

- Part No. STB06532
- Part No. STB06533
- Part No. STB06534
- Part No. STB06535
- Part No. STB06536
- Part No. STB06537
- Part No. STB06538

Installation Instructions

⚠ WARNING

CALIFORNIA Proposition 65 Warning

This product contains a chemical or chemicals known to the State of California to cause cancer, birth defects, or reproductive harm.

1. Park the machine on a level surface, and raise the plow a few inches off the ground.
2. Place a jack stand under the plow pushframe, shut off the vehicle engine, engage the parking brake, and remove the key.
3. Remove the bolts, washers, and nuts securing the blade to the plow and discard them (Figure 1).

Retain the plow blade.

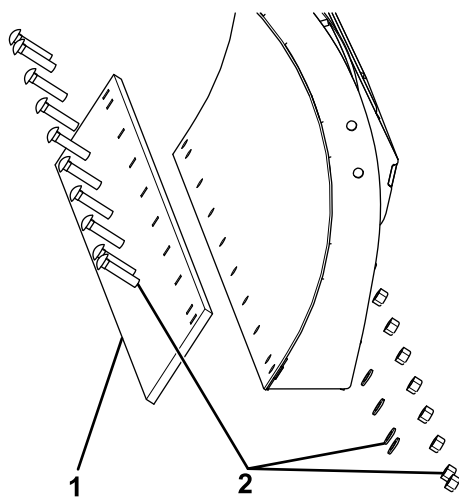

Figure 1

g209781

1. Retain

2. Discard

Safety

Installing this kit will change the weight of your plow. Ensure that your vehicle does not exceed the gross-vehicle-weight rating (GVWR) at any time. You may need to weigh the vehicle and add ballast or limit the payload of the vehicle to compensate.

4. Install the back drag edge and previously removed plow blade to the plow using new bolts, washers, and nuts, as shown in Figure 2.

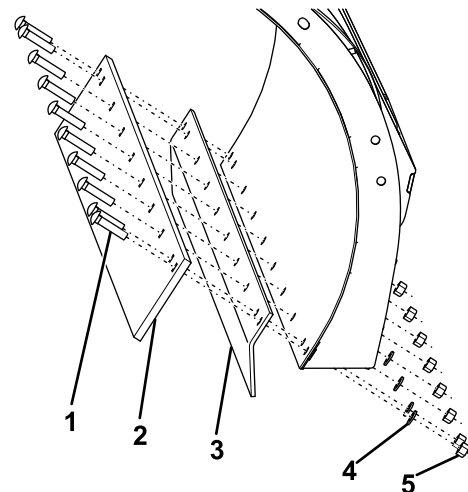

Figure 2

g209782

- | | |
|-------------------|-----------|
| 1. Bolt | 4. Washer |
| 2. Blade | 5. Nut |
| 3. Back drag edge | |