

Installation Instructions

Safety

- Always detach the wing extensions before transporting the plow.
- Installing this kit will change the weight of your plow. Ensure that your vehicle does not exceed the gross-vehicle-weight rating (GVWR) at any time. You may need to weigh the vehicle and add ballast or limit the payload of the vehicle to compensate.

Installation

Determine the left and right sides of the machine from the normal operating position.

1. Remove the plow if it is mounted to a vehicle; refer to your plow *Owner's Manual*.
2. Remove and retain the plow blade guides.
3. If your plow is equipped with snow deflectors, remove and retain the outermost belting straps, and pull the belting out of the way during installation.
4. On the left side of the plow, drill a hole (7/16 inch) at the location shown in [Figure 1](#).

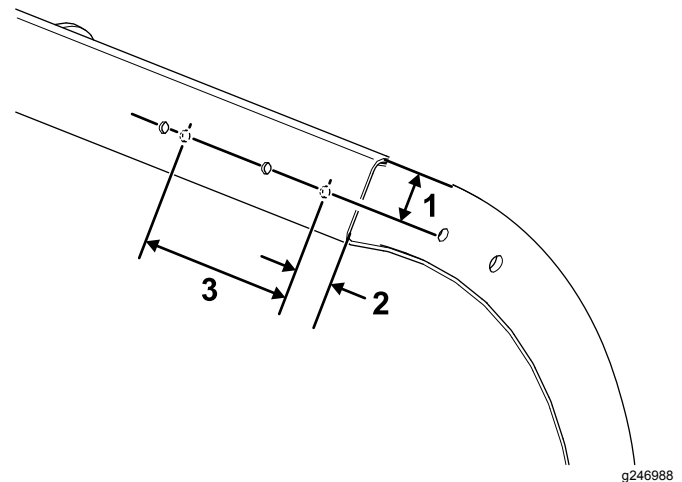

Figure 1

1. 4.25 cm (1-21/32 inches)
2. 4.12 cm (1-5/8 inches)
3. 16.35 cm (6-7/16 inches)

5. Loosely attach the spring bracket base-plate to the plow using a carriage bolt (3/8 inch), button head bolt, and 2 locknuts ([Figure 2](#)).

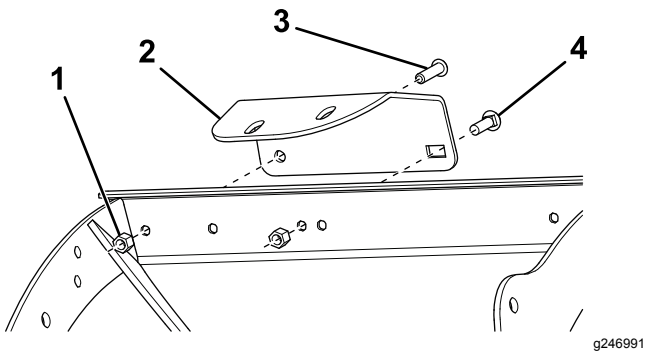

Figure 2

- | | |
|------------------------------|-----------------------------|
| 1. Locknut | 3. Button head bolt |
| 2. Spring bracket base-plate | 4. Carriage bolt (3/8 inch) |

6. Loosely attach the spring bracket to the side of the plow using a bolt (1/2 inch) and locknut (Figure 3).

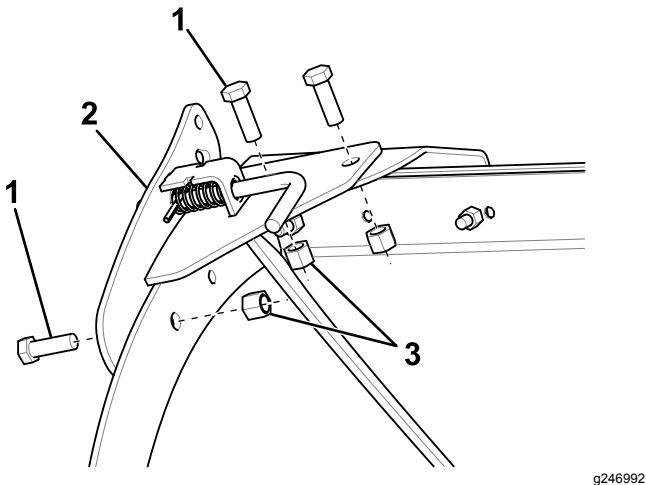

Figure 3

- | | |
|--------------------|------------|
| 1. Bolt (1/2 inch) | 3. Locknut |
| 2. Spring bracket | |

7. Loosely attach the spring bracket to the spring bracket base-plate using 2 bolts (1/2 inch) and locknuts (Figure 3).

Note: If necessary, use washers (3/8 inch) to shim between the spring bracket base-plate and the blade to adjust the position of the base-plate.

8. Attach a previously removed plow blade guide to the spring bracket (Figure 4), and torque the bolts to 19 N·m (14 ft-lb).

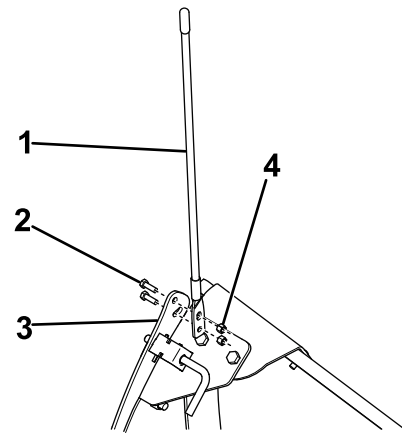

Figure 4

- | | |
|----------------------------|---------------------------|
| 1. Plow blade guide | 3. Spring bracket |
| 2. Previously removed bolt | 4. Previously removed nut |

9. Loosely attach the rib brackets to the plow using 4 bolts (1/2 inch) and locknuts (Figure 5).

Note: Ensure that the rib brackets are mounted to the correct side of the plow ribs.

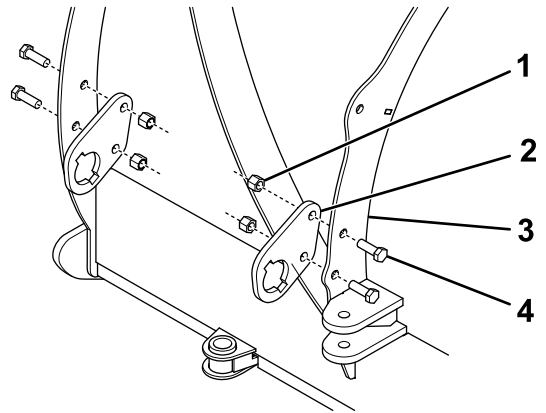

Figure 5

- | | |
|----------------|--------------------|
| 1. Locknut | 3. Plow rib |
| 2. Rib bracket | 4. Bolt (1/2 inch) |

10. Pull back on the spring pin and rotate it into the lock position (Figure 6).

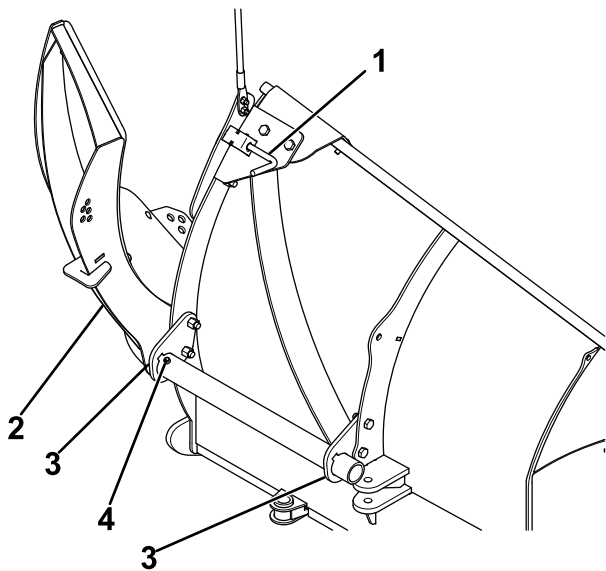

Figure 6

g246995

- | | |
|---------------|----------------|
| 1. Spring pin | 3. Rib bracket |
| 2. Plow wing | 4. Attach pin |

- Slide the plow wing tube through the rib brackets until the attach pin passes through the outer bracket (Figure 6).
- Rotate the plow wing forward and lock it in place with the spring pin (Figure 7).

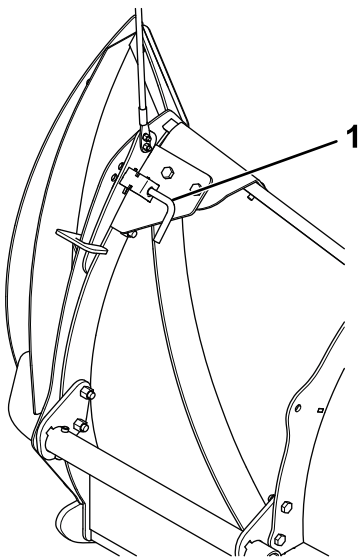

Figure 7

g246996

- Spring pin

- Attach a plow blade guide to the plow wing using 2 bolts (5/16 inch) and locknuts (Figure 8), and torque the bolts to 19 N·m (14 ft·lb).

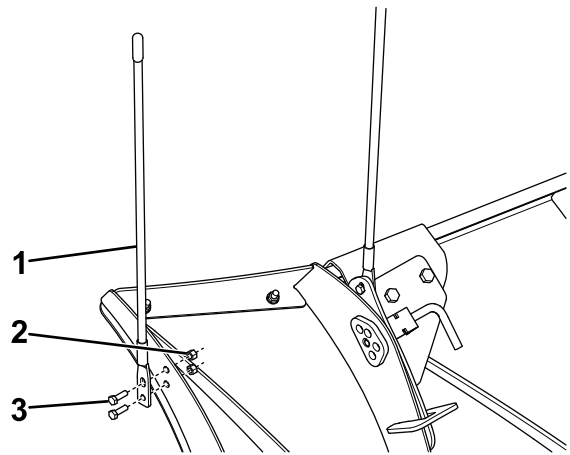

Figure 8

g246997

- | | |
|---------------------|---------------------|
| 1. Plow blade guide | 3. Bolt (5/16 inch) |
| 2. Locknut | |

- Repeat steps 4 through 13 on the right side of the plow.
- Determine which holes on the plow wing to use for mounting the cutting edge using Figure 9 and the following list:
 - XT plows—holes 1 and 5
 - DXT plows without the formed cutting edge—holes 1 and 3
 - DXT plows with the bolt-on replacement edge—holes 2 and 4

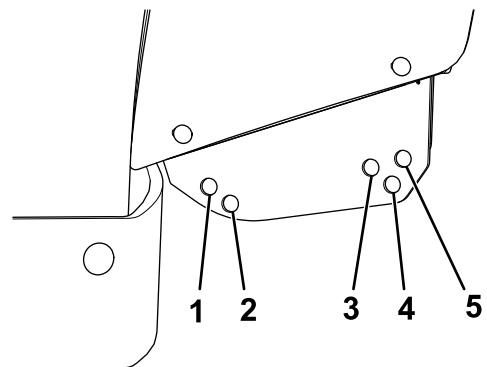

Figure 9

g246998

- Attach the plow wing cutting edge to the plow wing using 2 carriage bolts (5/8 inch), a mounting plate, and 2 nuts (Figure 10).

Note: Ensure that the plow wing cutting edge is aligned with the plow cutting edge and flush to the ground.

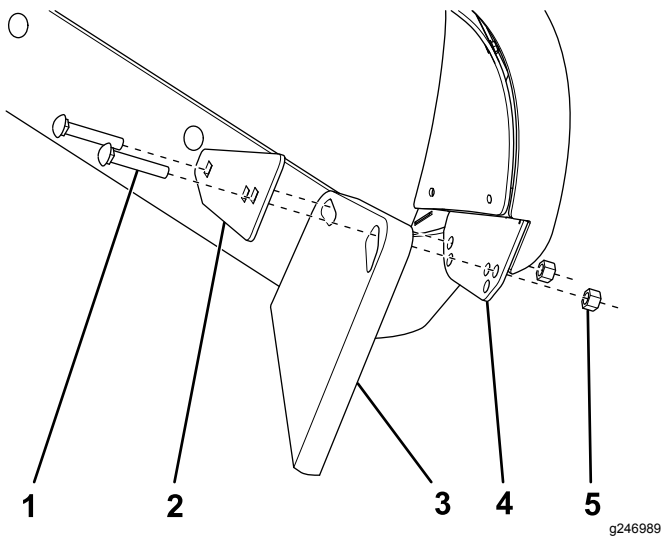
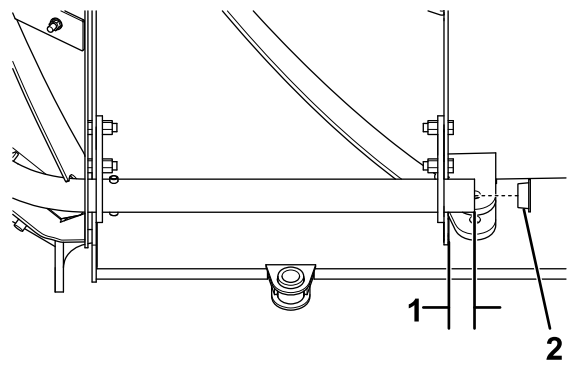

Figure 10

- | | |
|-----------------------------|--------------|
| 1. Carriage bolt (5/8 inch) | 4. Plow wing |
| 2. Mounting plate | 5. Nut |
| 3. Cutting edge | |



g246990

Figure 11

- | | |
|---------------------|--------------|
| 1. 12 mm (1/2 inch) | 2. Tube plug |
|---------------------|--------------|

-
17. Torque the fasteners to the following specifications:
 - 1/2-inch bolts to 76 N·m (56 ft-lb)
 - 3/8-inch carriage bolts to 31 N·m (23 ft-lb)
 - 5/8-inch carriage bolts to 153 N·m (113 ft-lb)
 - Button head bolts to 31 N·m (23 ft-lb)
 18. If your plow is equipped with snow deflectors, pull the belting back into place and secure it over the spring bracket base-plates with the previously removed belt straps and hardware.
 19. Check the installation as follows:
 - Remove and attach the plow wings several times, making any necessary adjustments.
 - Attach the plow to the truck and ensure it sits level with all cutting edges touching the ground.
 20. If desired, cut the plow wing tube to within 12 mm (1/2 inch) of the inner plow rib, and insert the tube plug in the end (Figure 11).

Note: The tube plug helps prevent corrosion.