

Installation Instructions

Safety

- Always follow the vehicle manufacturer's recommendations relating to system installation. For recommended vehicle models, refer to the *BOSS Snowplow Application Chart and Selection Guide*.
- Never disable, remove, or relocate any sensors or other components related to the operation of the air bags.
- To comply with federal regulations and to assure a safe vehicle, do not exceed the front gross-axle-weight rating (FGAWR), rear gross-axle-weight rating (RGAWR), and the gross-vehicle-weight rating (GVWR) at any time.
- Due to the variety of equipment that you can install on the vehicle and undercarriage, do not exceed the front gross-axle-weight rating (FGAWR), rear gross-axle-weight rating (RGAWR), and the gross-vehicle-weight rating (GVWR) at any time. This may require weighing the vehicle and adding ballast as necessary. It may also limit the payload capacity of the vehicle.

Installation

1. Park the vehicle on a level surface, engage the parking brake, shut off the engine, and remove the key.
2. Remove the vehicle bumper.
3. Remove the front-to-front compatibility brackets.

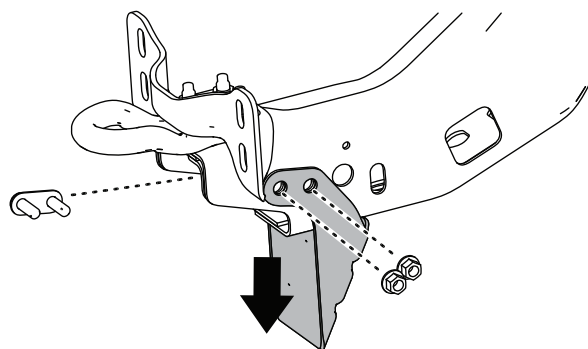

Figure 1

g350549

4. Remove the driver side OEM stabilizer bar mounting bolts and nuts from the frame.
5. For vehicles with an auxiliary radiator mounting between the front frame rails, remove the fasteners that secure the radiator brackets to the frame rails.

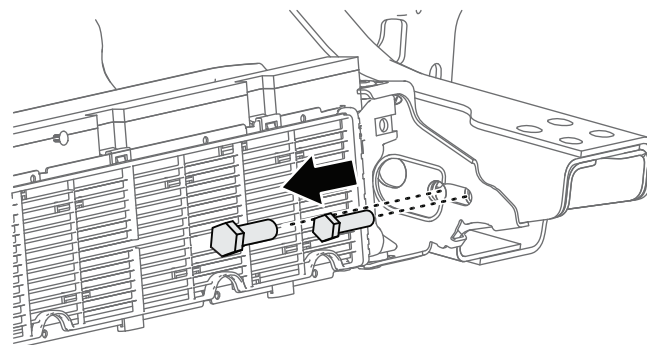

Figure 2

g350376

6. Slide the support plate between the frame and radiator mounting bracket.



- Secure the support plate to the frame using 2 bolts (5/8 x 2 inches), 2 washers (5/8 inch), and 2 nuts (5/8 inch).

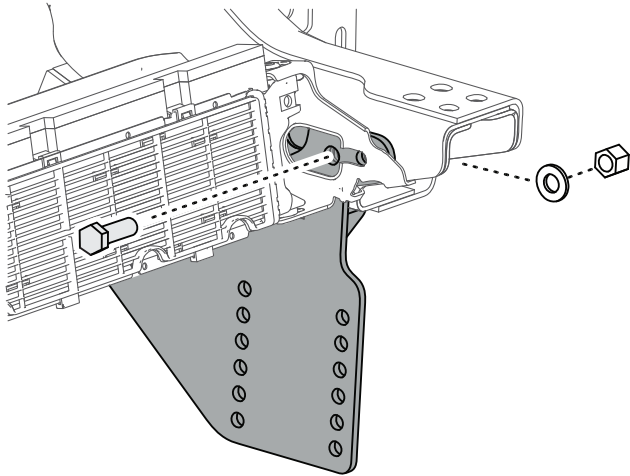

Figure 3

g350382

- Secure the radiator bracket and support plate to the frame using 2 bolts (1/2 x 2 inches), 2 washers (1/2 inch), and 2 nuts (1/2 inch).

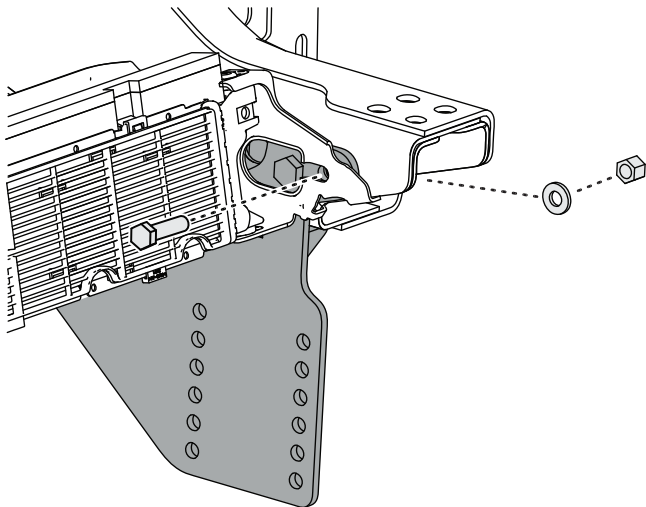

Figure 4

g350383

- Place a washer (3/8 inch) onto each of the bolt bars.

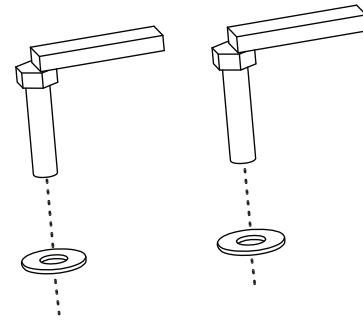

Figure 5

g350377

- Place the bolt bars and washers into the frame.
- Place the OEM stabilizer bracket with bushing onto the bolt bars.
- Place the support plate onto the bolt bars, and loosely secure with 4 washers (3/8 inch), and 4 nuts (3/8 inch).

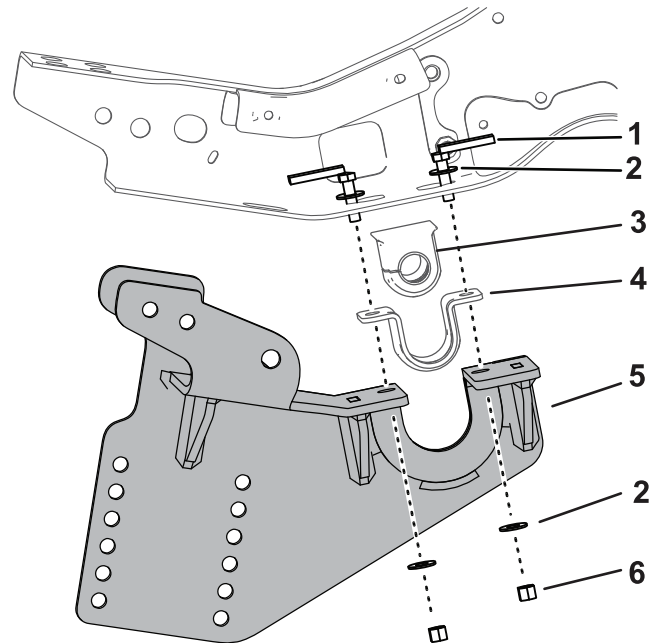

Figure 6

g350550

- | | |
|----------------------|---------------------------|
| 1. Bolt bars | 4. OEM stabilizer bracket |
| 2. Washer (3/8 inch) | 5. Support plate |
| 3. Bushing | 6. Nut (3/8 inch) |

- Install 2 bolts (5/8 x 2 inches), 2 washers (5/8 inch), and 2 nuts (5/8 inch) to secure the support plate to the frame.

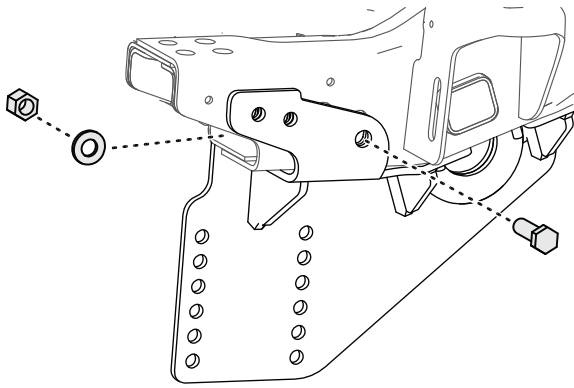

Figure 7

g350379

14. Install 4 bolts (1/2 x 2 inches), 4 washers (1/2 inch), and 4 nuts (1/2 inch) to secure the support plates to the frame.

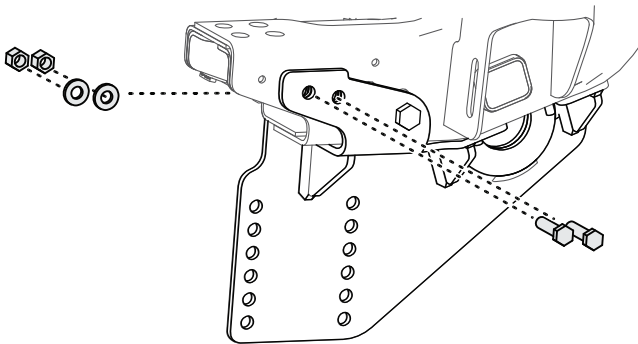

Figure 8

g350380

15. Install 2 bolts (5/8 x 2 inches), 2 washers (5/8 inch), and 2 nuts (5/8 inch) to secure the underside of the support plates to the frame.

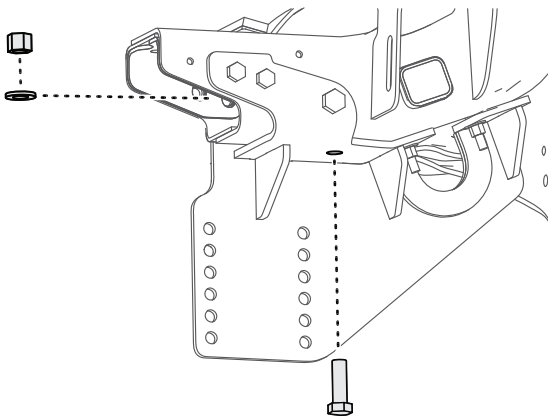

Figure 9

g350381

16. For model LTA10200, use 8 bolts (1/2 x 1-1/2 inch) and 8 nylon locknuts (1/2 inch) to loosely secure the push beam assembly to the support plates.

For model LTA10210, use 8 bolts (1/2 x 2 inches) and 8 nylon locknuts (1/2 inch) to loosely secure the push beam assembly to the support plates

Note: Refer to the Recommended Pushbeam Height table below.

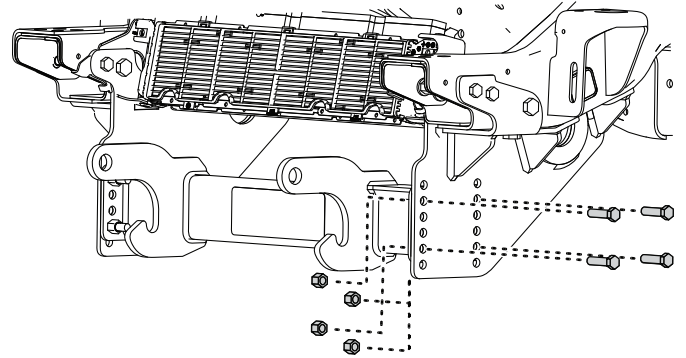

Figure 10

g350384

17. Install the bumper to the vehicle.
18. Torque all of the fasteners to the following specifications:
- 3/8 inch bolts: torque to 31 N·m (23 ft-lb)
 - 1/2-inch bolts: torque to 76 N·m (56 ft-lb)
 - 5/8-inch bolts: torque to 153 N·m (113 ft-lb)

Recommended Pushbeam Height

Plow Type	Recommended Pushbeam Height to the center of the hook hole
Heavy Duty	16-1/2 inches
Standard Duty	15-1/2 inches
HTX/Sport Duty	14-1/2 inches

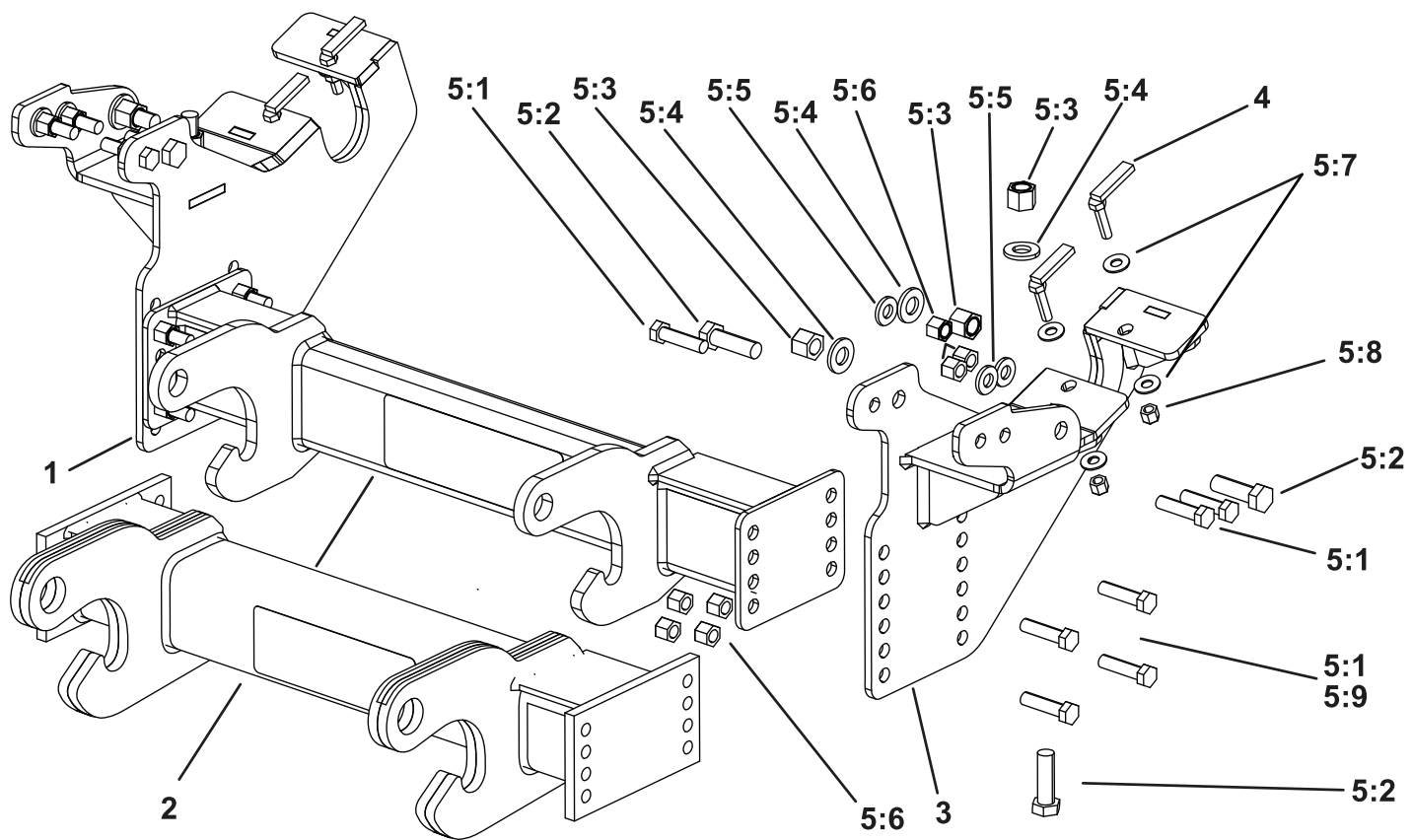

Parts

g350375

Ref.	Part Number	Qty.	Description	Ref.	Part Number	Qty.	Description
1	PBA10203-03 (for model LTA10200)	1	PBSP, PS, RT3, FORD, 2017+ [BLACK]	5:1	HDW01755 (for model LTA10200)	6	HHCS, 1/2-13X2, GR5, YZN
1	PBA10213-03 (for model LTA10210)	1	PBSP, PS, HD RT3, FORD, 2017+ [BLACK]	5:1	HDW01755 (for model LTA10210)	14	HHCS, 1/2-13X2, GR5, YZN
2	PBA10201-03 (for model LTA10200)	1	PB ASSY, RT3, FORD, 2017+ [BLACK]	5:2	HDW01731	6	HHCS, 5/8-11X2, GR5, YZN
2	PBA10211-03 (for model LTA10210)	1	PB ASSY, HD RT3, FORD, 2017+ [BLACK]	5:3	HDW05619	6	NUT, 5/8-11, NYL INS, YZN
3	PBA10202-03 (for model LTA10200)	1	PBSP, DR, RT3, FORD, 2017+ [BLACK]	5:4	HDW01726	6	WASHER, 5/8 FLAT HARDEN YZN
3	PBA10212-03 (for model LTA10210)	1	PBSP, DR, HD RT3, FORD, 2017+ [BLACK]	5:5	HDW01729	6	WASHER, 1/2, F436 HARD, F/W, YZN
4	LTA10233-03	4	BOLT BAR, FORD SUPER DUTY, 17+	5:6	HDW01748	14	NUT, 1/2-13, NYL INS, YZN
5	HDW10215	1	HARDWARE KIT	5:7	HDW01733	8	WASHER, 3/8, USS FLAT, YZN
				5:8	HDW01720	4	NUT, 3/8-16, NYL INS, YZN
				5:9	HDW01728 (for model LTA10200)	8	HHCS, 1/2-13 X 1-1/2, NC, GR5, YZN