



P.O. Box 787 Iron Mountain, MI 49801-0787
ISO 9001:2008 REGISTERED
bossplow.com

**2016 & NEWER
HONDA PIONEER 1000
RT3 UNDERCARRIAGE
MOUNTING INSTRUCTIONS
(PART NO. LTA12310)**

WARNING

Always follow the vehicle manufacturers' recommendations relating to system installation.

Due to the variety of equipment that can be installed on this vehicle, it is necessary to verify that the Gross Vehicle Weight Rating (GVWR) is not exceeded at any time. This may require weighing the vehicle and adding ballast as necessary. It may also limit payload capacity of the vehicle. It is the operator's responsibility to verify that these ratings are not exceeded.

2016 & NEWER HONDA PIONEER RT3 UNDERCARRIAGE MOUNTING INSTRUCTIONS

The mounting procedure outlined below covers 2016 & Newer Honda Pioneer 1000 models. You will need to refer to the illustrations and familiarize yourself with each of the undercarriage components and their relative position to each other. Then proceed as follows:

1. Park the vehicle on a level surface, set the parking brake, shut off the engine, and remove the key from the ignition switch.
2. Remove the four long existing hex bolts and two short hex key bolts attaching the factory steel bumper to the frame, then remove the screws and tabs that mount the skid plate to the plastic bumper panels.
3. If there is a stock winch and mount, remove the assembly, then remove the winch from the stock mount.
4. Using the Skid Plate Assembly (1) as a template, mark out the two hole locations on the bottom side of the factory steel bumper's skid plate.
5. Using a 7/16" drill bit, drill out the two marked hole locations on the vehicle's metal skid plate.
6. Install the winch to the New Winch Mount (2).
7. Place the Winch Mount (2) behind the factory bumper's location. Slide the factory bumper into place, tucking the plastic bumper panels between the steel bumper's skid plate and the Winch Mount (2). Line up the holes, re-install the four long factory hex head bolts, and loosely tighten.
8. Using four M10 x 1.25 x 40 Hex Head Bolts (B) and four M10 Lock Washers (A) attach the Skid Plate Assembly (1) to the vehicle's frame.
9. Using two 3/8"-16 x 1-1/4" Hex Head Bolts (D) and two 3/8"-16 Nylon Lock Nuts (C) fasten the two rear most holes of the Skid Plate Assembly (1) to the vehicle's frame.
10. Using two 3/8"-16 x 1-1/2" Hex Head Bolts (F) and two 3/8" Lock Washers (E), utilizing the holes drilled earlier, attach the factory bumper skid plate and Skid Plate Assembly (1) to the Winch Mount (2).
11. Using two M10 x 1.25 x 40 Hex Head Bolts (B) and two M10 Lock Washers (A), bolt the Skid Plate Assembly (1), factory bumper, and Winch Mount (2) to the frame through the side holes.
12. Attach the Push Beam Assembly (3) using six 3/8"-16 x 1-1/4" Bolts (D), six 3/8"-16 Nylon Lock Nuts (C), four 1/2"-13 x 1-1/2" Bolts (H) and four 1/2"-13 Nylon Lock Nuts (G).
13. Tighten all fasteners to recommended torque found in Figure 4.

2016 & HONDA PIONEER RT3 UNDERCARRIAGE INSTALLATION PROCEDURE

REF. NO.	DESCRIPTION	PART NO.	QTY.
1	Skid Plate Assembly	LTA12311	1
2	Winch Mount	LTA12329	1
3	Push Beam Assembly	PBA12535	1
	Fastener Kit	HDW12320	1
Includes:			
A	M10 Lock Washer	HDW05595	6
B	M10 x 1.25 x 40 Hex Head Bolt	HDW12324	6
C	3/8"-16 Nylon Lock Nut	HDW01720	8
D	3/8"-16 x 1-1/4" Hex Head Bolt	HDW01771	8
E	3/8" Lock Washer	HDW01718	2
F	3/8"-16 x 1-1/2" Hex Head Bolt	HDW01754	2
G	1/2"-13 Nylon Lock Nut	HDW01748	4
H	1/2"-13 x 1-1/2" Hex Head Bolt	HDW01728	4

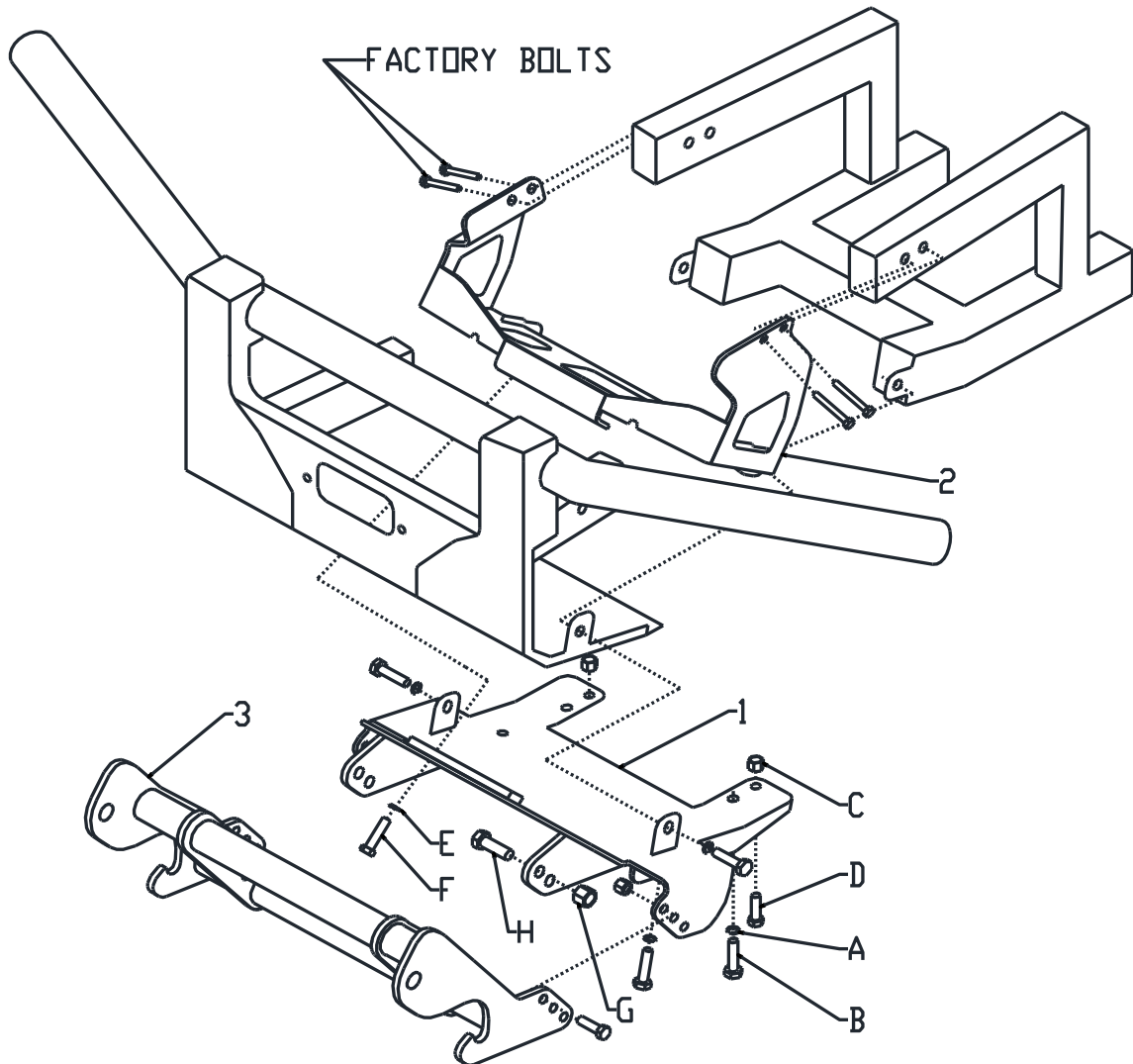

Figure 1

G13970

RECOMMENDED SUSPENSION SETTINGS

- Increase preload of front springs to highest setting. See manufacturer's specifications for proper adjustment procedure.

GUIDE TO RECOMMENDED ASSEMBLY TORQUE

DIAMETER / PITCH	GRADE 5	GRADE 8	GRADE 8.8	GRADE 10.9
1/4-20	6	9		
5/16-18	14	19		
3/8-16	23	33		
7/16-14	38	53		
1/2-13	56	80		
9/16-12	82	116		
5/8-11	113	159		
3/4-10	201	283		
M10 X 1.25			36	
M10 X 1.5				49
M12 X 1.75				71
M14 X 2.0				80

ALL TORQUE VALUES ARE IN FOOT-POUNDS (FT.-LB.)

Figure 2

G10410

* The torque values listed above are based on dry, coated bolts. Variables such as oil or other lubrications may appreciably alter these values and must be taken into consideration.

NOTE: IT IS IMPORTANT THAT ALL FASTENERS BE PROPERLY TORQUED TO ASSURE A SAFE OPERATING PLOW. RE-TIGHTEN ALL FASTENERS AFTER 2 HOURS OF PLOWING.