

Part No. MSC18237—Serial No. 400000000 and Up
 Part No. MSC18238—Serial No. 400000000 and Up
 Part No. MSC18239—Serial No. 400000000 and Up
 Part No. MSC29090—Serial No. 400000000 and Up

Installation Instructions

BOSS Products limited consumer warranty and BOSS Products commercial warranty policies are located at www.BOSSPlow.com.

Patent www.ttcopats.com.

Installation

1. Park the machine on a level surface and raise the plow a few centimeters (inches) off the ground.
2. Place a jack stand under the plow pushframe, shut off the vehicle engine, engage the parking brake, and remove the key.
3. Remove the existing cutting edges by removing the bolts, washers, and nuts that secure the cutting edges to the blades (Figure 1).

Retain the washers and nuts for future steel cutting edge installation.

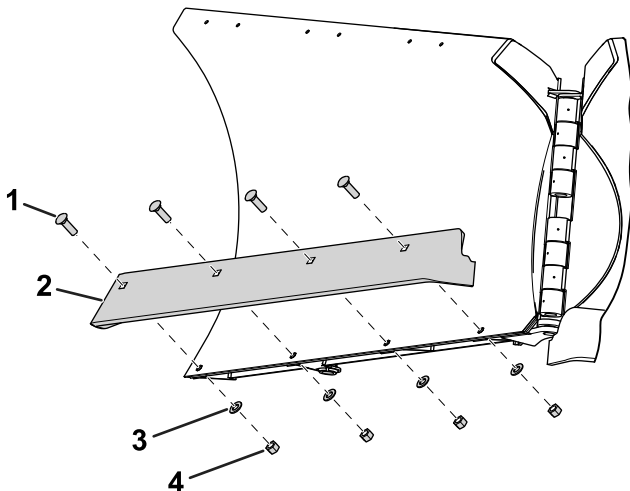

Figure 1

2.29 m (7-1/2 ft) or 2.5 m (8-1/6 ft) plow shown

- | | |
|--------------------------|-----------|
| 1. Bolt (5/8 x 2 inches) | 3. Washer |
| 2. Cutting edge | 4. Nut |

Safety

- Always lower the blade when the machine is not in use.
- Never put any part of your body between the plow and the machine.

4. Secure the urethane cutting edges and straps to the blades using the carriage bolts, washers, and locknuts that are provided in the kit (Figure 2). Loosely tighten the hardware by hand.

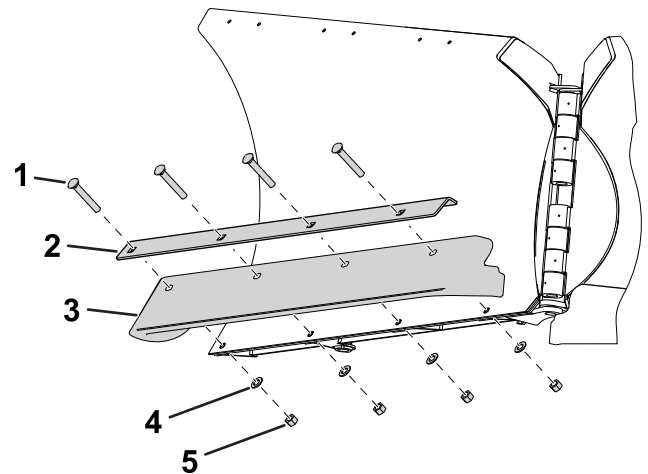

Figure 2

2.29 m (7-1/2 ft) or 2.5 m (8-1/6 ft) plow shown

- | | |
|-----------------------------------|-----------------------|
| 1. Carriage bolt (5/8 x 4 inches) | 4. Washer |
| 2. Strap | 5. Locknut (5/8 inch) |
| 3. Urethane cutting edge | |

5. Ensure that there is a gap (3.2 mm or 1/8 inch) between the edges at the center of the plow (Figure 3).



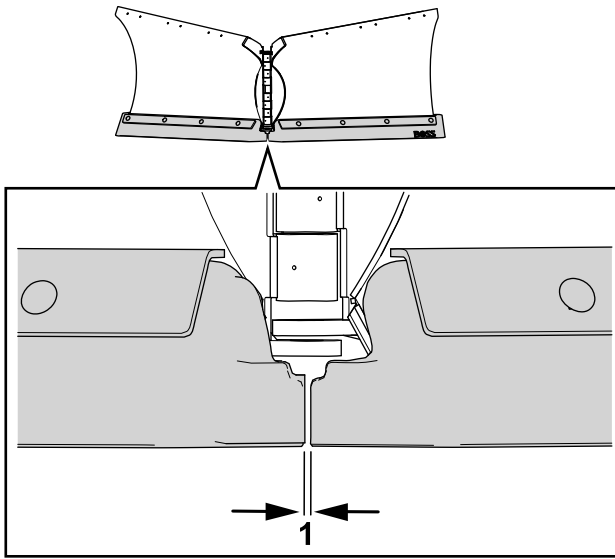

g237785

Figure 3

1. 3.2 mm (1/8 inch)

6. Tighten the bolts until the strap is securely fastened in place.

Part No. MSC18237—Serial No. 40000000 and Up

Part No. MSC18238—Serial No. 40000000 and Up

Part No. MSC18239—Serial No. 40000000 and Up

Part No. MSC29090- Serial No.40000000 and Up

Installation Instructions

BOSS Products limited consumer warranty and BOSS Products commercial warranty policies are located at www.BOSSPlow.com.

Patent www.ttcopats.com.

Safety

- Always lower the blade when the machine is not in use.
- Never put any part of your body between the plow and the machine.

Installation

1. Park the machine on a level surface and raise the plow a few centimeters (inches) off the ground.
2. Place a jack stand under the plow pushframe, shut off the vehicle engine, engage the parking brake, and remove the key.
3. Remove the existing cutting edges by removing the bolts, washers, and nuts that secure the cutting edges to the blades (Figure 1).

Retain the washers and nuts for future steel cutting edge installation.

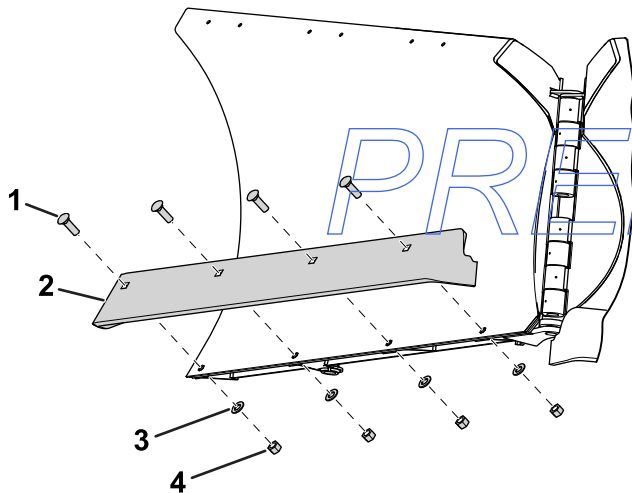

Figure 1

2.29 m (7-1/2 ft) or 2.5 m (8-1/6 ft) plow shown

- | | |
|--------------------------|-----------|
| 1. Bolt (5/8 x 2 inches) | 3. Washer |
| 2. Cutting edge | 4. Nut |

4. Secure the urethane cutting edges and straps to the blades using the carriage bolts, washers, and locknuts that are provided in the kit (Figure 2). Loosely tighten the hardware by hand.

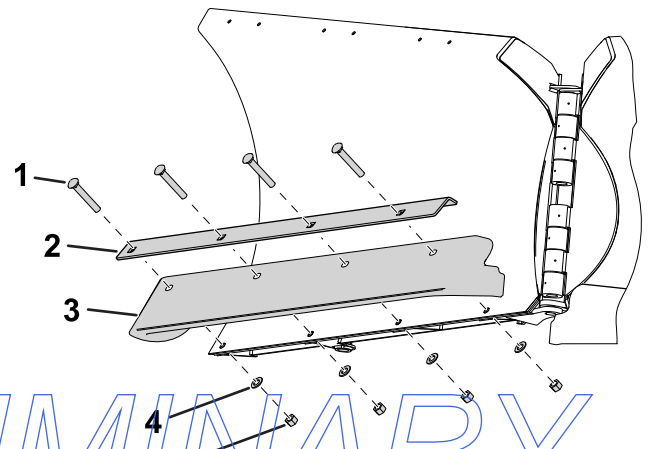

Figure 2

2.29 m (7-1/2 ft) or 2.5 m (8-1/6 ft) plow shown

- | | |
|-----------------------------------|-----------------------|
| 1. Carriage bolt (5/8 x 4 inches) | 4. Washer |
| 2. Strap | 5. Locknut (5/8 inch) |
| 3. Urethane cutting edge | |

5. Ensure that there is a gap (3.2 mm or 1/8 inch) between the edges at the center of the plow (Figure 3).



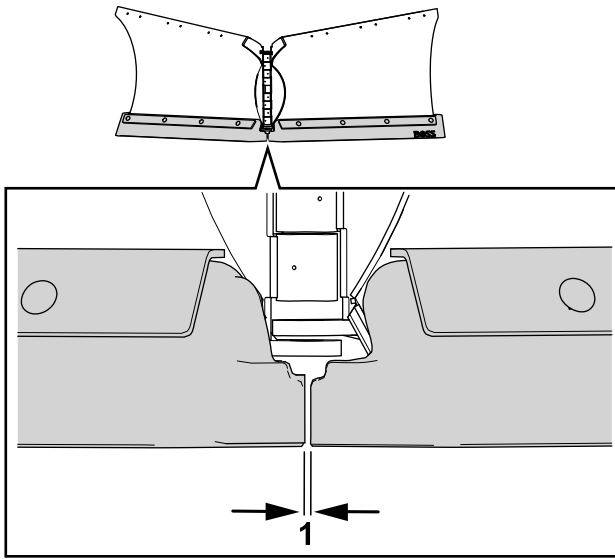

g237785

Figure 3

1. 3.2 mm (1/8 inch)

6. Tighten the bolts until the strap is securely fastened in place.

PRELIMINARY

Part No. MSC18237—Serial No. 40000000 and Up

Part No. MSC18238—Serial No. 40000000 and Up

Part No. MSC18239—Serial No. 40000000 and Up

Add MSC29090

Installation Instructions

This is a revision
Text will be edited AFTER routing
To see the changes once implemented, click the Post-Drafting Review checkbox in your task.
The Reason for creating the Rev is:
adding model MSC15780
Use of this product may cause exposure to chemicals known to the State of California to cause cancer, birth defects, or reproductive harm.

BOSS Products limited consumer warranty and BOSS Products commercial warranty policies are located at www.BOSSPlow.com.

Safety

- Always lower the blade when the machine is not in use.
- Never put any part of your body between the plow and the machine.

Installation

1. Park the machine on a level surface and raise the plow a few centimeters (inches) off the ground.
2. Place a jack stand under the plow pushframe, shut off the vehicle engine, engage the parking brake, and remove the key.
3. Remove the existing cutting edges by removing the bolts, washers, and nuts that secure the cutting edges to the blades (Figure 1).

Retain the washers and nuts for future steel cutting edge installation.

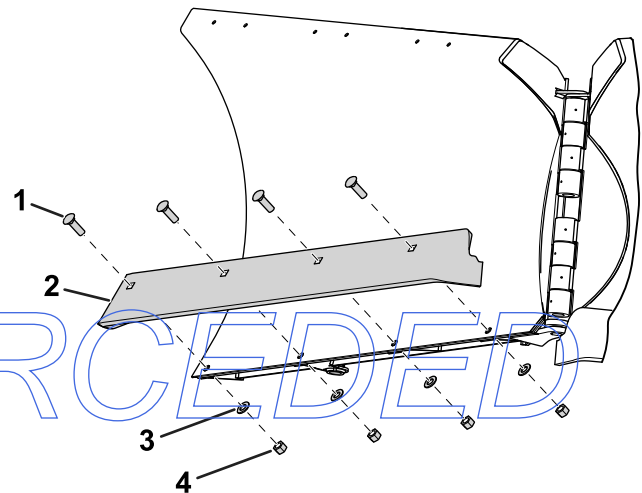

Figure 1

2.29 m (7-1/2 ft) or 2.5 m (8-1/6 ft) plow shown

- | | |
|--------------------------|-----------|
| 1. Bolt (5/8 x 2 inches) | 3. Washer |
| 2. Cutting edge | 4. Nut |

Revision to add model MSC 29090



- Secure the urethane cutting edges and straps to the blades using the carriage bolts, washers, and locknuts that are provided in the kit (Figure 2). Loosely tighten the hardware by hand.

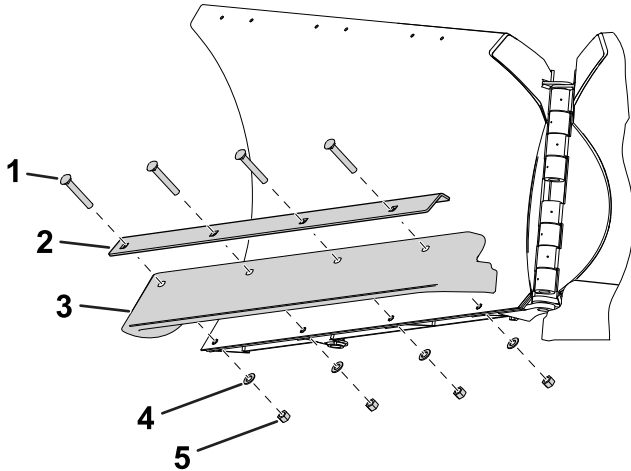

g235401

Figure 2

2.29 m (7-1/2 ft) or 2.5 m (8-1/6 ft) plow shown

- | | |
|-----------------------------------|-----------------------|
| 1. Carriage bolt (5/8 x 4 inches) | 4. Washer |
| 2. Strap | 5. Locknut (5/8 inch) |
| 3. Urethane cutting edge | |

- Ensure that there is a gap (3.2 mm or 1/8 inch) between the edges at the center of the plow (Figure 3).

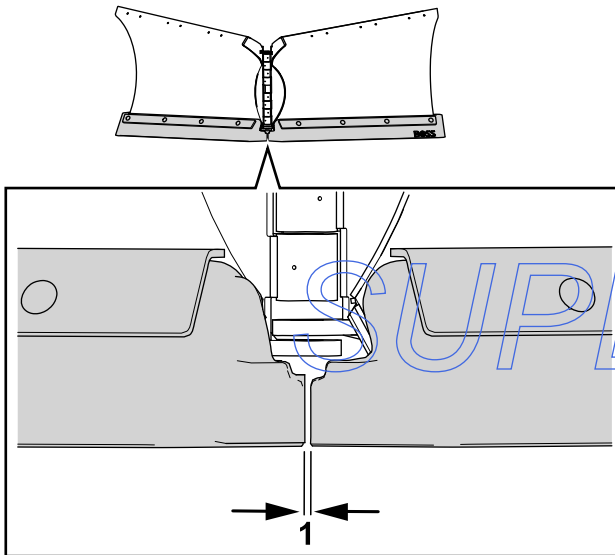

g237785

Figure 3

- 3.2 mm (1/8 inch)

- Tighten the bolts until the strap is securely fastened in place.