



P.O. Box 787
Iron Mountain, MI 49801
United States

Owner's Manual

Straight Blade Plow

for Groundsmaster® 3200 or 3300 Series Traction Unit

Part No. MSC23345—Serial No. 40000000 and Up

Part No. STB13567B—Serial No. 40000000 and Up

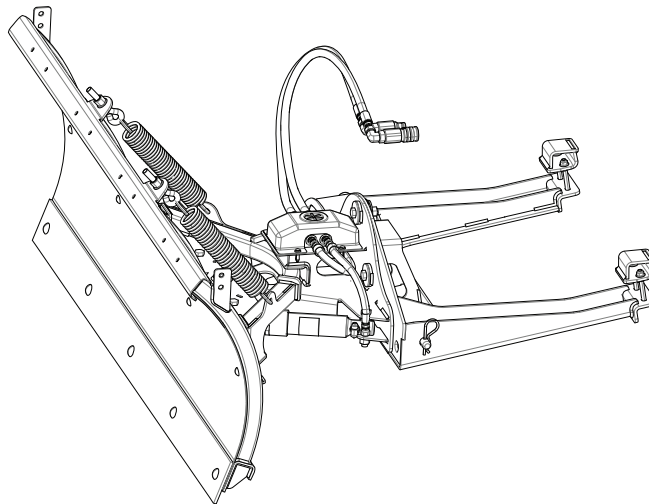

This product complies with all relevant European directives; for details, please see the separate product specific Declaration of Conformity (DOC) sheet.

BOSS Products limited consumer warranty and BOSS Products commercial warranty policies are located at www.bossplov.com.

Patents www.ttcopats.com.

Introduction

Note: This plow attaches to the Groundsmaster 3200 or 3300.

The straight-blade plow is intended to be used on a Toro ride-on, multi-purpose machine. The blade is designed to hydraulically change its angle as needed for snow removal. Using this product for purposes other than its intended use could prove dangerous to you and bystanders.

Read this information carefully to learn how to operate and maintain your product properly and to avoid injury and product damage. You are responsible for operating the product properly and safely.

Visit www.bossplov.com for product safety and operation training materials, accessory information, help finding a dealer, or to register your product.

Whenever you need service, genuine BOSS parts, or additional information, contact an Authorized BOSS Dealer or BOSS Technical Service (1-800-286-4155) and have the model and serial numbers of your product ready. **Figure 1** identifies the location of the model and serial numbers on the product. Write the numbers in the space provided.

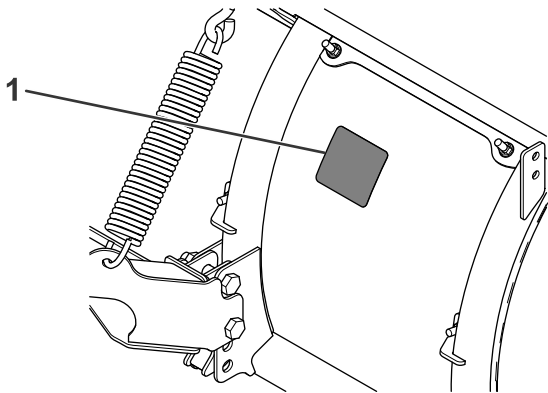

Figure 1

1. Model and serial number location

Date Purchased	_____
Model No.	_____
Serial No.	_____
Blade Crate Serial No.	_____

This manual identifies potential hazards and has safety messages identified by the safety-alert symbol (**Figure 2**), which signals a hazard that may cause serious injury or death if you do not follow the recommended precautions.



Figure 2

Safety-alert symbol

g000502

This manual uses 2 words to highlight information. **Important** calls attention to special mechanical information and **Note** emphasizes general information worthy of special attention.

Contents

- Safety 3
 - Preparation..... 3
 - Operation..... 3
 - Safety and Instructional Decals 4
- Setup 5
 - Preparing the Machine..... 5
 - Installing the Required Kits 6
 - Installing the Plow on the Machine 6
 - Installing the Push Frame 7
 - Installing the Hydraulic Hoses..... 8
- Product Overview 9
 - Controls 9
 - Specifications 9
- Operation 10
 - Operating the Plow 10
 - Operating Tips 10
- Maintenance 11
 - Recommended Maintenance Schedule(s) 11
 - 11
 - Maintenance 11
- Storage 11
 - Storing the Plow 11
 - Removing the Plow from Storage..... 11
- Troubleshooting 12

Safety

Improper use or maintenance by the operator or owner can result in injury. To reduce the potential for injury, comply with these safety instructions and always pay attention to the safety-alert symbol , which means *Caution, Warning, or Danger*—personal safety instruction. Failure to comply with the instruction may result in personal injury or death.

Preparation

- Read the *Owner's Manual* before operating or servicing the plow.
- Always follow the vehicle manufacturer's recommendations relating to system installation.
- Ensure that only trained personnel installs and performs maintenance on the equipment and hydraulic components.
- Always wear appropriate personal protective equipment when loading, unloading, and servicing the plow. Wear substantial, slip-resistant footwear and eye protection.

Operation

- Use a 500 kg (1/2 ton) minimum lifting device to move heavy plow components.
- Never put any part of your body between the plow and the vehicle.
- When transporting the plow, ensure that it is properly secured. Instructions are available at www.bossplov.com.
- When transporting the vehicle, position the plow so as not to block your vision or headlights.
- Do not change the blade position when traveling.
- Do not exceed 16 km/h (10 mph) while transporting.
- Always lower the blade when the vehicle is not in use.
- Do not operate the machine while ill, tired, or under the influence of alcohol or drugs.
- Always follow the vehicle manufacturer's recommendations for proper parking procedures.
- Overloading the plow could result in an accident or damage. Never exceed the rated operating capacity for the vehicle.
- Ensure that you do not exceed the gross-vehicle-weight rating (GAWR) at any time.

- Turn the vehicle and plow off before filling, servicing, or cleaning it.
- Do not climb into or ride on the plow.
- Keep your hands, feet, and clothing away from moving parts and mounting points.
- Use your full attention while operating the machine. Do not engage in any activity that causes distractions; otherwise, injury or property damage may occur.
- Do not operate the plow within 8 m (25 ft) of bystanders.

Safety and Instructional Decals



Safety decals and instructions are easily visible to the operator and are located near any area of potential danger. Replace any decal that is damaged or missing.



MSC23037

decalsc23037

1. Warning—read the *Owner's Manual*.
2. Warning—all operators should be trained before operating the machine.
3. Warning—coupler must be locked before plowing.
4. Warning—coupler must be unlocked to remove the plow.
5. Warning—shut off the engine, remove the key, and read the *Owner's Manual* before performing maintenance.
6. Crushing hazard—do not stand between the plow and vehicle during maintenance.
7. Warning—do not exceed 8 km/h (5 mph) when transporting or plowing.
8. Warning—lower the plow when the vehicle is not in use.

Setup

Note: Determine the left and right sides of the machine from the normal operating position.

Preparing the Machine

Remove the Deck from the Machine (if required)

Refer to the deck *Installation Instructions*.

Remove the PTO Shaft from the Machine

Remove the 6 bolts from the PTO shaft and remove the shaft.

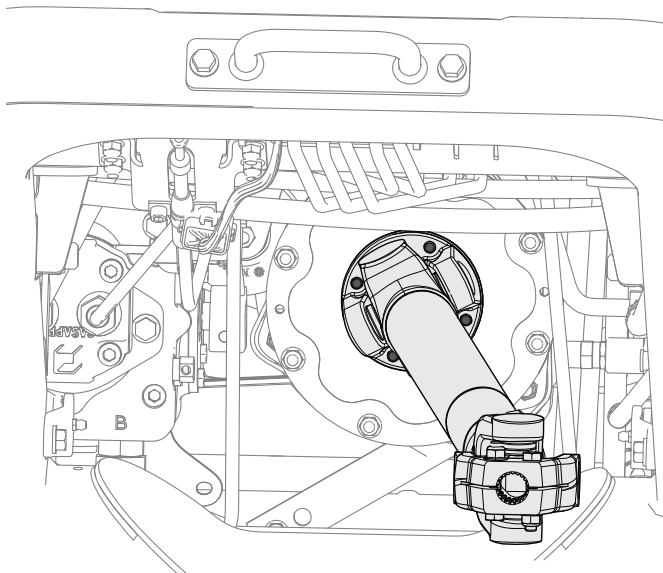

Figure 3

g317217

Removing the Shoulder Bolt from the Lift Arms

Use the removal tool to remove the shoulder bolt from the lift arms.

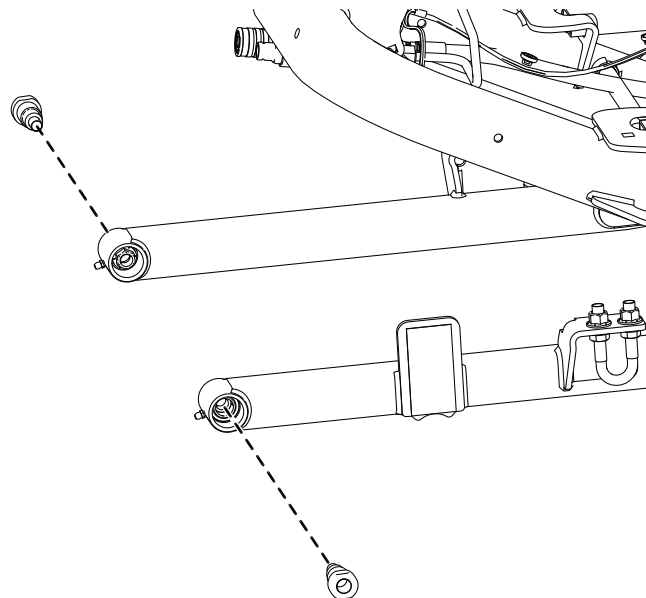

Figure 4

g317026

Removing the Manifold Orifice

1. Locate the lift manifold from under the machine (Figure 5).

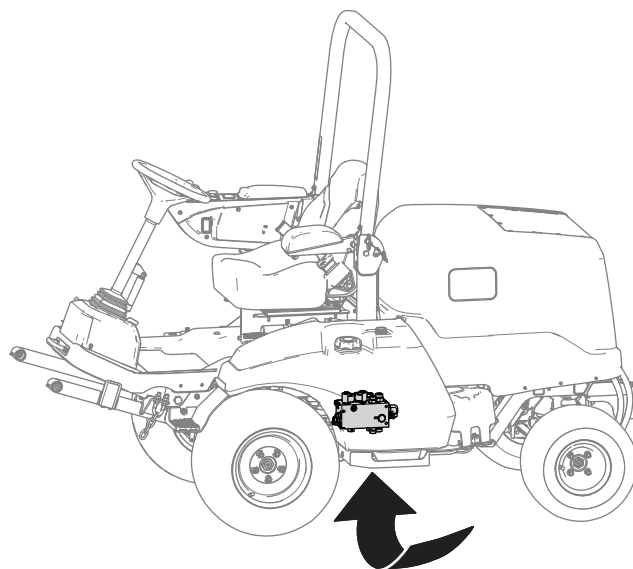

Figure 5

g299920

- Remove the hose connection from the fitting in port C1 (Figure 6).

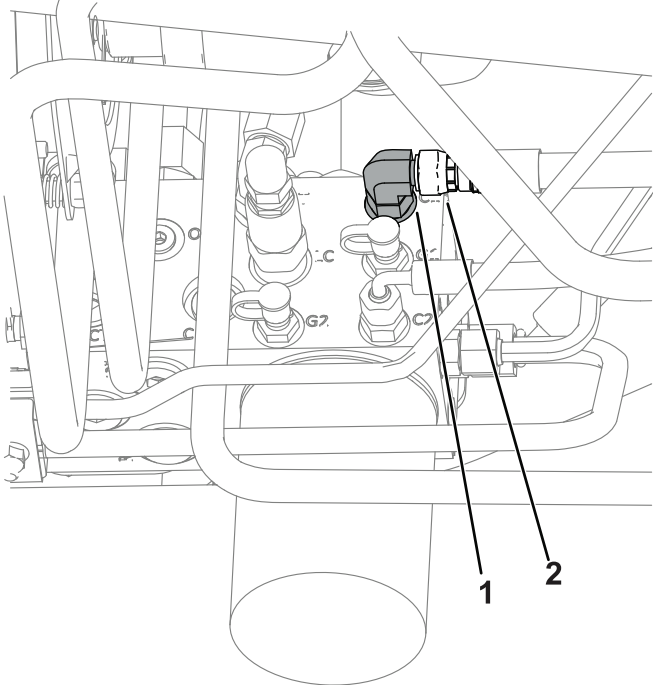

Figure 6

g316862

- Fitting
- Hose connection

- Remove the fitting from the manifold.
 - Use a pick to remove the orifice disc from the manifold.
- Note:** Do not discard the orifice disc. It is required for installing other Groundsmaster attachments.
- Install the fitting onto the C1 port on the manifold.
 - Secure the hose to the fitting.
 - Torque the fitting to 47 to 53 N·m (35 to 39 ft-lb).
 - Torque the hose connection to 41 to 45 N·m (30 to 33 ft-lb).

Adjusting the Weight Transfer of the Attachment

Refer to the machine *Operator's Manual*.

Installing the Required Kits

Install the following kits:

- Auxiliary Hydraulic Kit (31966)
- Accessory Control Kit (31994)

Installing the Plow on the Machine

- Install the clevis pins through the lift arm bushings.

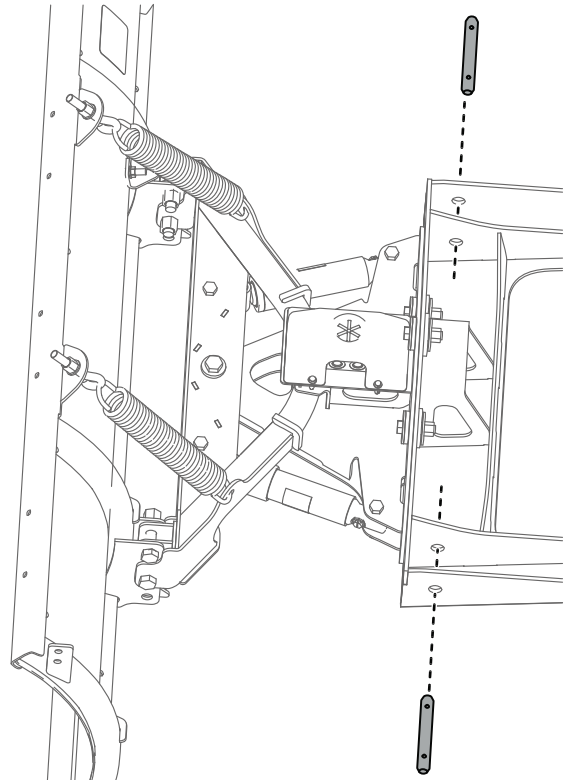

Figure 7

g317027

- Install the cotter pins.

Installing the Push Frame

1. Loosely secure the 2 mounting brackets to the plow using 2 bolts (5/8 inch) and nuts (Figure 10).

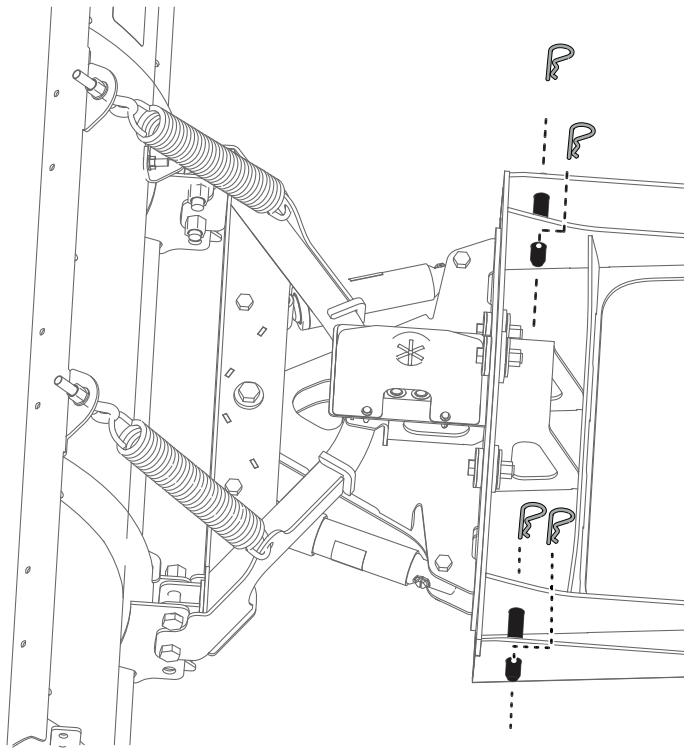

Figure 8

g317028

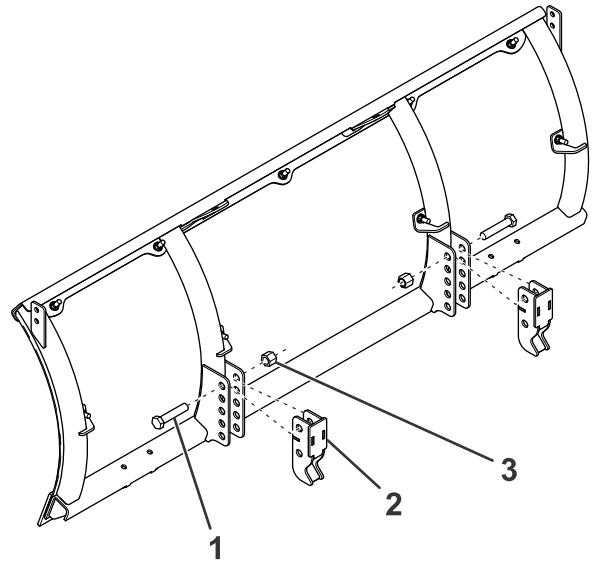

Figure 10

g297803

3. Install the brackets.

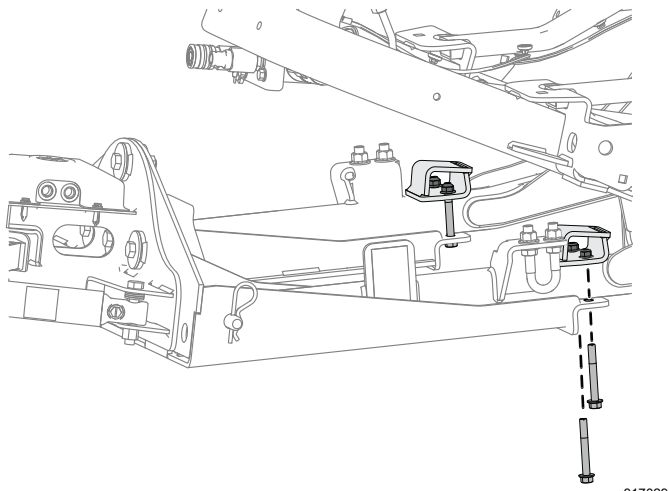

Figure 9

g317029

1. Bolt (5/8 inch)
2. Mounting bracket
3. Nut (5/8 inch)

2. Loosely secure the push frame to the plow and mounting brackets using 2 bolts (5/8 inch) and nuts (Figure 11).

4. Torque the bolts to 48 N·m (35 ft-lb).

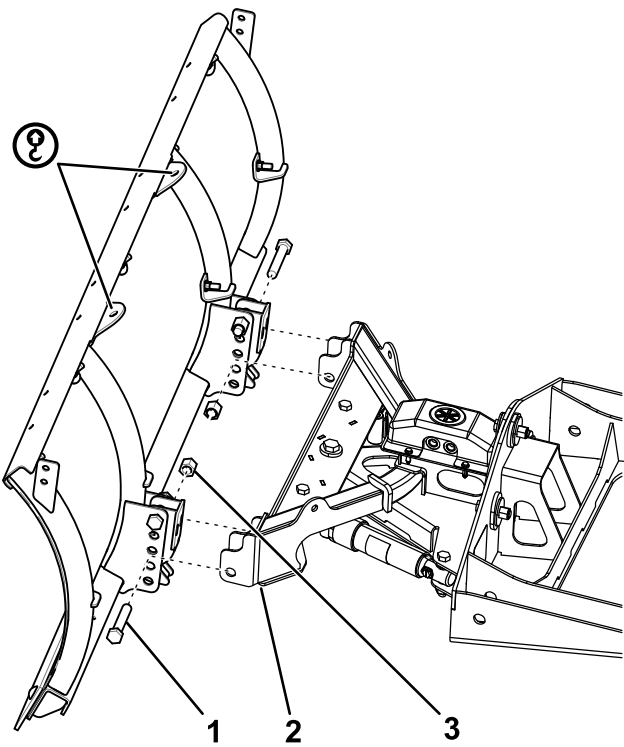

Figure 11

g322158

- 1. Bolt (5/8 inch)
- 2. Push frame
- 3. Nut (5/8 inch)

- 3. Torque all 4 bolts to 153 N·m (113 ft-lb).

Note: Do not overtighten the fasteners; ensure that the push frame can pivot freely.

- 4. Hook the 2 trip springs through the holes on the push frame (Figure 12).

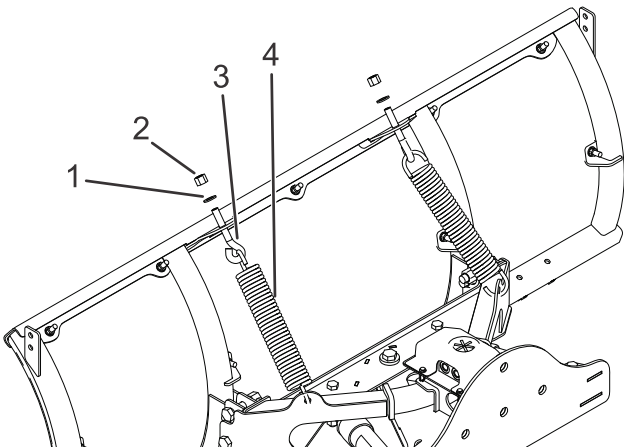

Figure 12

g316202

- 1. Washer (1/2 inch)
- 2. Nylon locknut (1/2 inch)
- 3. Eyebolt
- 4. Trip spring

- 5. Hook the other ends of the trip springs to 2 eyebolts (Figure 12).
- 6. Insert the threaded end of the eyebolts through the holes on the plow blade and secure them

using 2 washers (1/2 inch) and nylon locknuts (Figure 12).

- 7. Tighten the nylon locknuts until there is a gap of 0.8 mm (1/32 inch) between the trip spring coils.

Installing the Hydraulic Hoses

Install the hoses to the manifold as shown in Figure 13.

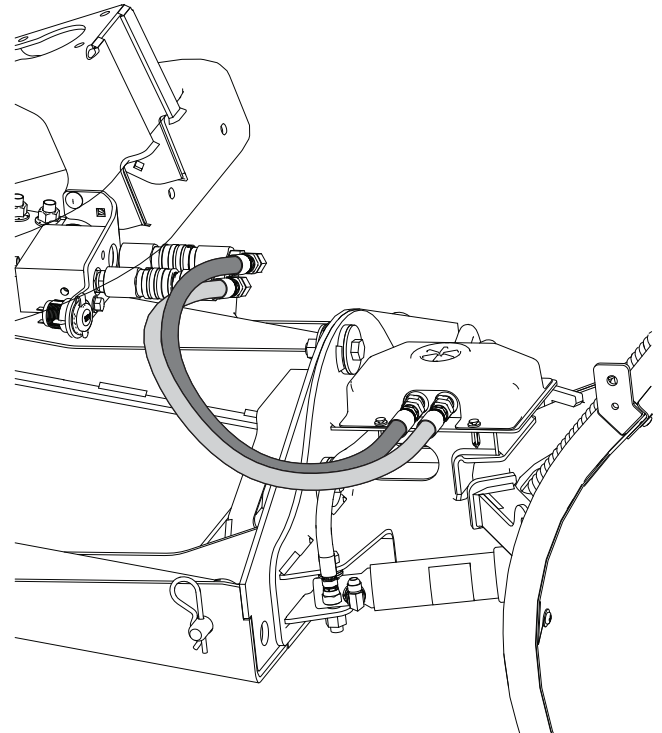
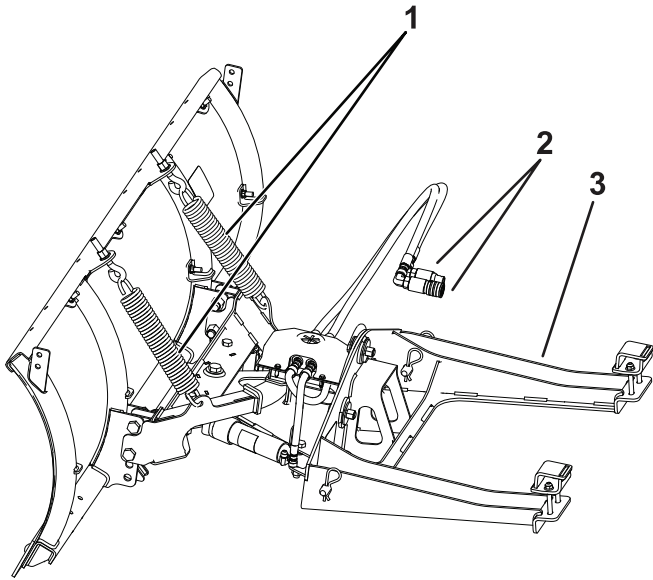

Figure 13

g317030

Product Overview

Push the lower switch, on the side console, up or down to raise or lower the plow.



g316207

Figure 14

- 1. Trip springs
- 2. Hydraulic hose quick couplers
- 3. Attachment plate

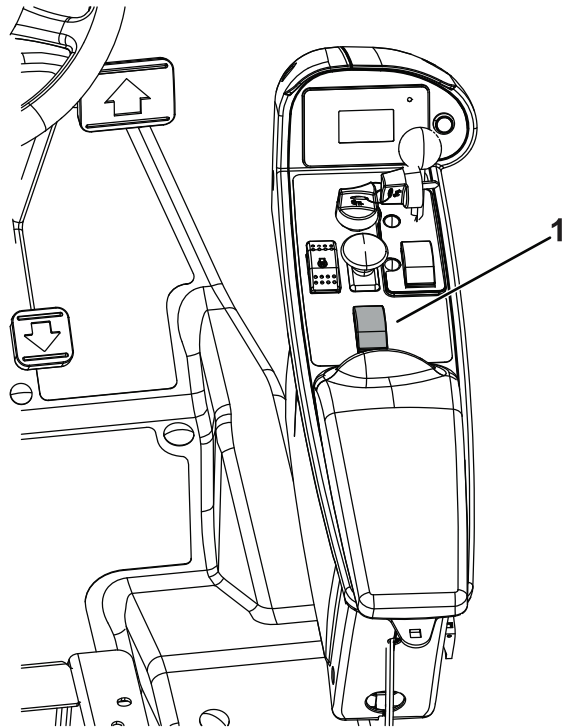

g317814

Figure 16

- 1. Raise / lower the plow

Controls

Push the upper switch, on the steering column, left or right to angle the plow.

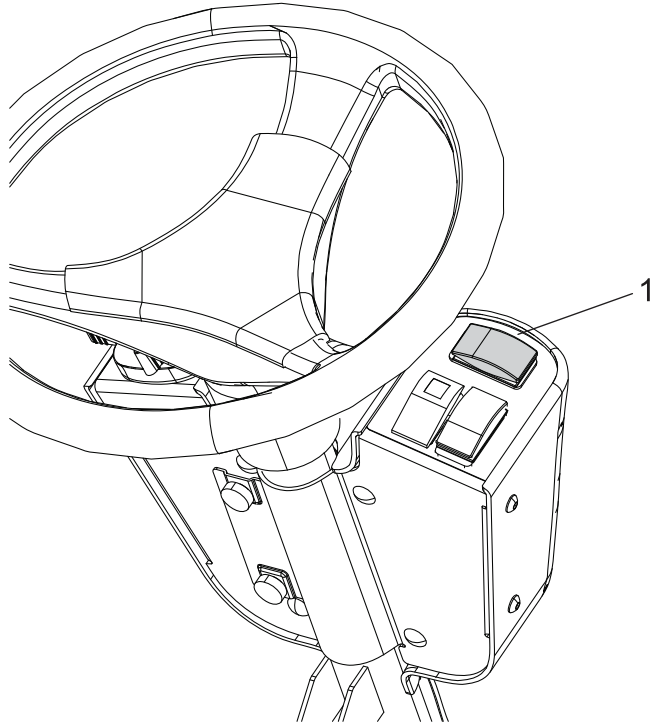

g317219

Figure 15

- 1. Angle switch

Specifications

Blade Width	Blade Height	Weight
1.52 m (5 ft)	55.8 cm (22 inches)	104 kg (229 lb)

Operation

Operating the Plow

Refer to your machine *Operator's Manual* for instructions on operating attachments.

Operating Tips

- Become familiar with the area you are plowing; hidden obstructions such as curbs and pipes can damage your plow or machine.
- Do not let snow accumulate; always plow with the storm.
- Lower the plow when not in use to prevent possible injury.
- Always plow at a safe speed in case you hit hidden obstructions.
- When transporting the machine, do not block your vision with the plow.
- Do not change the plow position while plowing.
- For more plowing tips, visit www.bosspow.com.

Maintenance

Recommended Maintenance Schedule(s)

Maintenance Service Interval	Maintenance Procedure
After the first 2 hours	<ul style="list-style-type: none">• Tighten all hardware.
Before each use or daily	<ul style="list-style-type: none">• Check the hydraulic cylinders.• Check the hydraulic lines and hoses.• Check all fasteners, pins, retainers, nuts, and bolts.• Check the cutting edge for wear.
Before storage	<ul style="list-style-type: none">• Lightly sand and use touch-up paint on painted areas that are scratched, chipped, or rusted.• Grease the hydraulic cylinder rods.• Lightly sand and use touch-up paint on painted areas that are scratched, chipped, or rusted.

Maintenance

- Check the hydraulic lines and hoses daily for leaks, kinked lines, loose mounting supports, wear, loose fittings, weather deterioration, and chemical deterioration. Make all necessary repairs before operating.
- Check the hydraulic cylinders daily for leaks, rust, or pitting on the rods. Make all necessary repairs before operating.
- Check the cutting edge daily for wear. If the cutting edge is worn down either flip or replace it.
- Check all fasteners, pins, retainers, nuts, and bolts daily to ensure that they are secure. Torque them to the appropriate value if they are loose.

Storage

Storing the Plow

1. Drive the plow to your storage location and remove the plow; refer to your machine *Operator's Manual*.
2. Grease any exposed metal on the hydraulic cylinder rods.
3. Lightly sand and use touch-up paint on painted areas that are scratched, chipped, or rusted.
4. Loosen the trip springs.

Removing the Plow from Storage

1. Check the torque of all fasteners; tighten as necessary.
2. Check the hydraulic lines and hoses for cracks or leaks.
3. Check the cutting edge for wear.
4. Tighten the trip springs.
5. Lightly sand and use touch-up paint on painted areas that are scratched, chipped, or rusted.
6. Attach the plow to the machine; refer to your machine *Operator's Manual*.
7. Move the plow through its range of motion to check the hydraulic cylinder rods.

Troubleshooting

Problem	Possible Cause	Corrective Action
Oil leaks from the hydraulic cylinders.	<ol style="list-style-type: none"><li data-bbox="586 216 802 243">1. The hose is bad.<li data-bbox="586 310 829 338">2. The cylinder is bad.<li data-bbox="586 344 889 371">3. The cylinder rod is pitted.	<ol style="list-style-type: none"><li data-bbox="1062 216 1516 296">1. Check the hose for leaks. Apply thread locking compound to the connection or replace the hose.<li data-bbox="1062 310 1321 338">2. Replace the cylinder.<li data-bbox="1062 344 1414 371">3. Polish the rod with steel wool.
The blade trips too easily.	<ol style="list-style-type: none"><li data-bbox="586 390 1029 420">1. The trip springs are loose or damaged.	<ol style="list-style-type: none"><li data-bbox="1062 390 1500 447">1. Tighten the springs or replace them if they are damaged.