

Installation Instructions

Installation

Installing this kit will change the weight and center of gravity of your vehicle. You may need to weigh the vehicle and add ballast or limit the payload of the vehicle to compensate.

1. Park the machine on a level surface, move the motion-control levers to the NEUTRAL position, shut off the engine, wait for all moving parts to stop, remove the key, and chock the front tires.
2. Raise the rear of the machine and support it with jack stands.
3. Remove the fasteners securing the rear tires to the machine and remove the rear tires (Figure 1).
4. Remove the nuts securing the rear light bracket to the machine (Figure 2).

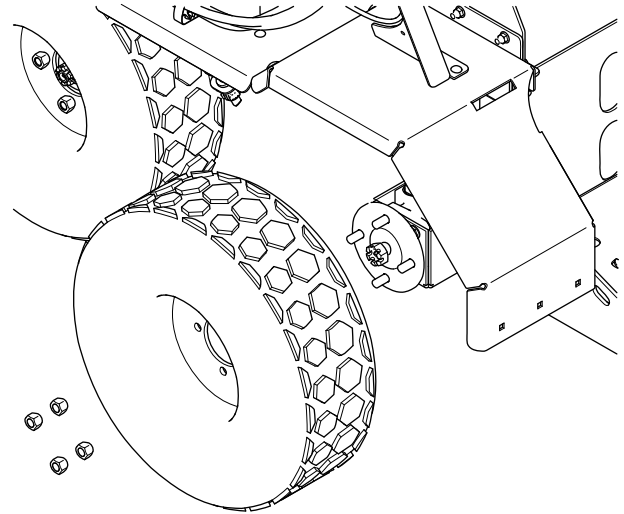

Figure 1

g294035

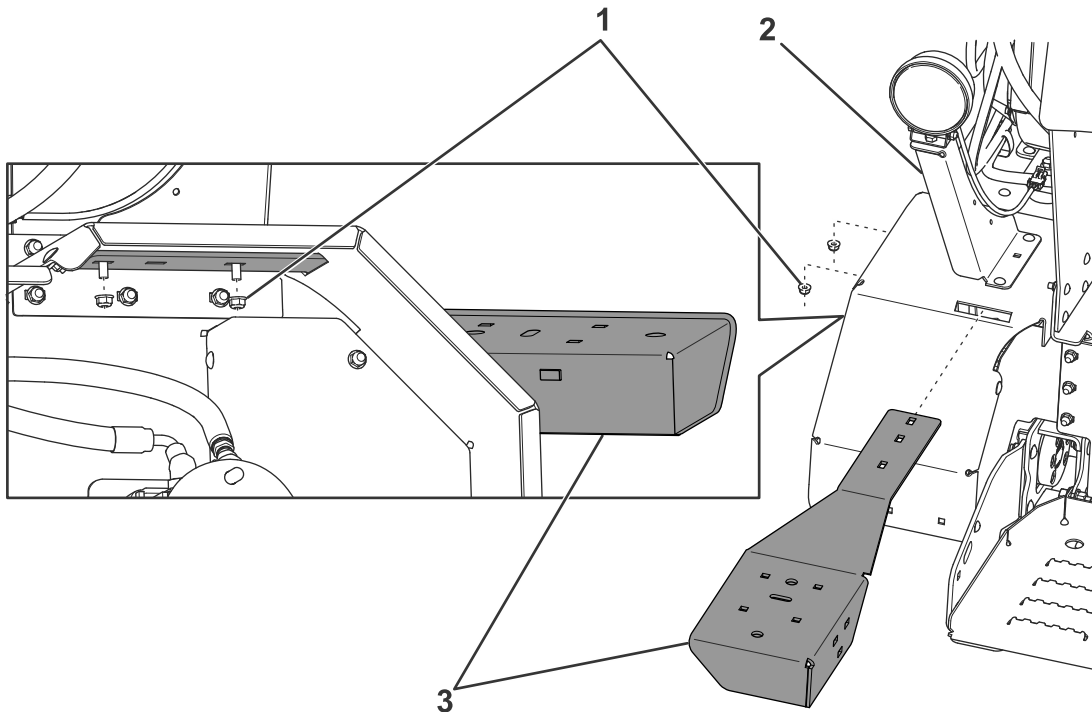

Figure 2

g297927

1. Nuts
2. Light bracket

3. Container-support bracket

5. Insert the left container support-bracket through the slot in the fender and secure it to the

machine using the fasteners for the rear light bracket (Figure 2).

6. Repeat steps 4 through 5 on the right side of the machine with the battery tray.
7. Secure the top of the left vertical bracket to the container support-bracket using 3 bolts (5/16 inch) and flange nuts (Figure 3).

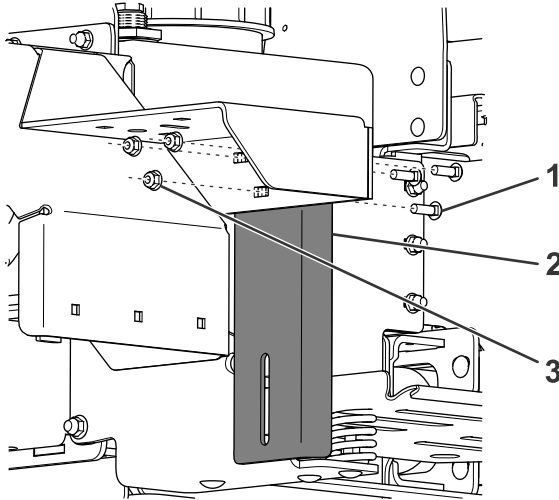

Figure 3

g297928

1. Bolt (5/16 inch)
2. Vertical bracket
3. Flange nut (5/16 inch)

8. Secure the bottom of the left vertical bracket to the operator platform using 2 bolts (3/8 inch) and flange nuts (Figure 4).

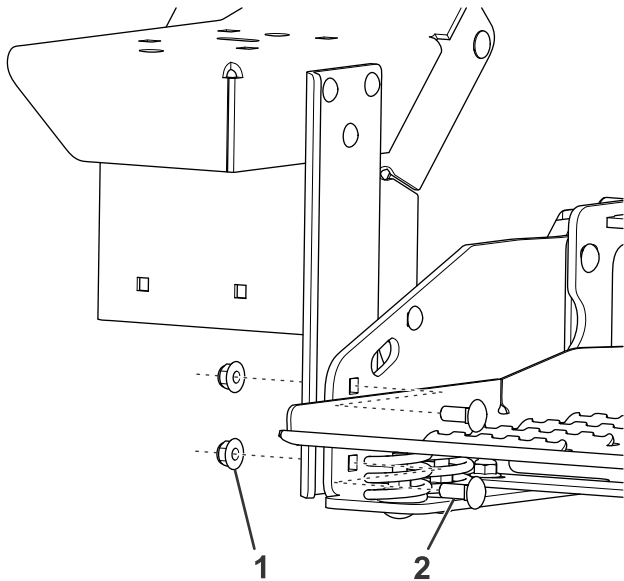

Figure 4

g297929

1. Flange nut (3/8 inch)
2. Bolt (3/8 inch)

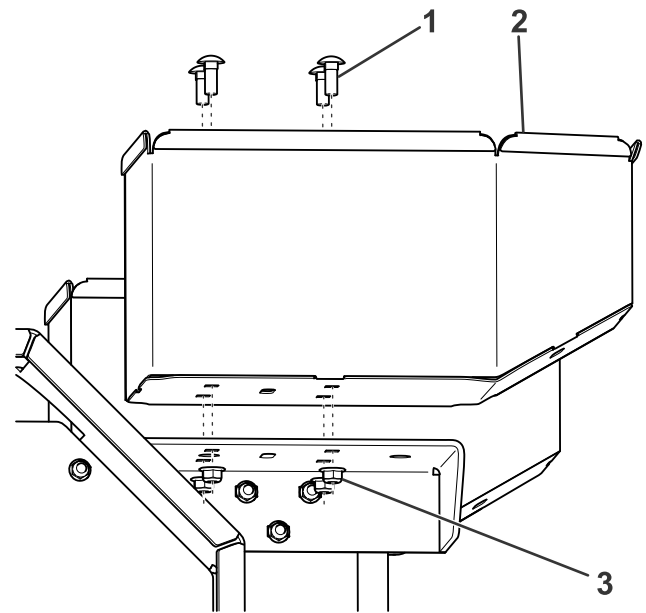

Figure 5

g297930

1. Bolt (3/8 inch)
2. Container
3. Flange nut (3/8 inch)

11. Torque the bolts to the following specifications:
 - 5/16-inch bolts to 15 N·m (11 ft-lb)
 - 3/8-inch bolts to 27 N·m (20 ft-lb)
12. Install the previously removed rear tires and torque them to 102 N·m (75 ft-lb).
13. Lower the machine from the jack stands.

9. Repeat steps 7 through 8 on the right side.
10. Secure the container to the brackets using 4 bolts (3/8 inch) and flange nuts (Figure 5).