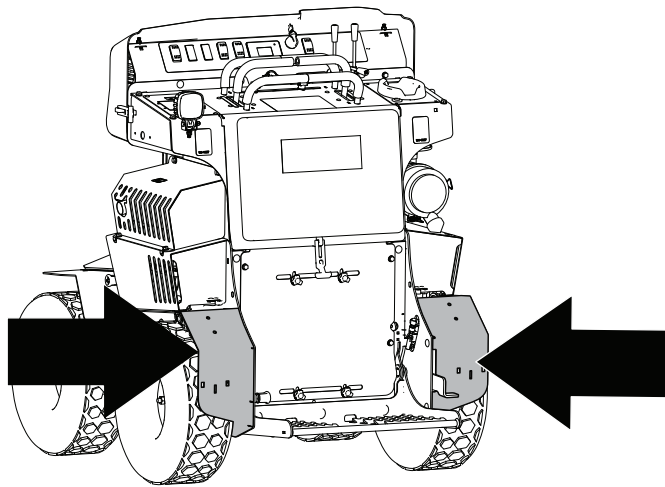


## Setup

### Installing the Mounting Plates

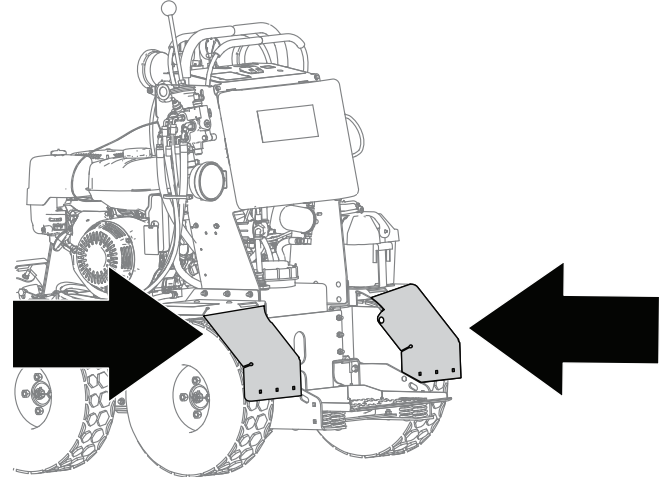
1. Park the machine on a level surface, move the motion-control levers to the NEUTRAL position, shut off the engine, wait for all moving parts to stop, remove the key, and chock the front tires.



g383799

**Figure 1**

Installation location options



g382858

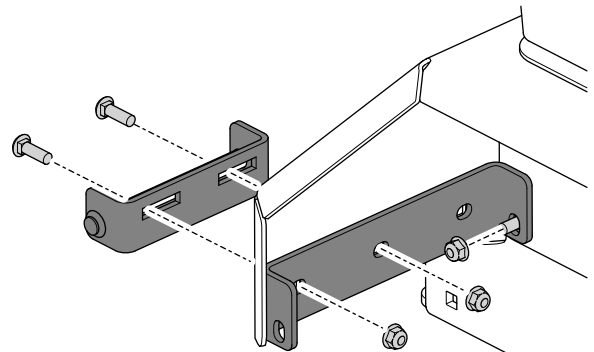
**Figure 2**

Installation location options

2. Secure the lower mounting plates to the machine using 2 bolts (5/16-18 x 1 inch) and 2 nuts (5/16-18 inch) from the kit. For the Snowrator only, use the single nut and bolt attached to the inside of the fender as well (Figure 3).

**Important:** Ensure that the mounting bar is below the hardware slots when installing the mounting plates.

- Use both brackets for the Snowrator.
- Use the outer bracket only for the Snowrator MAG.

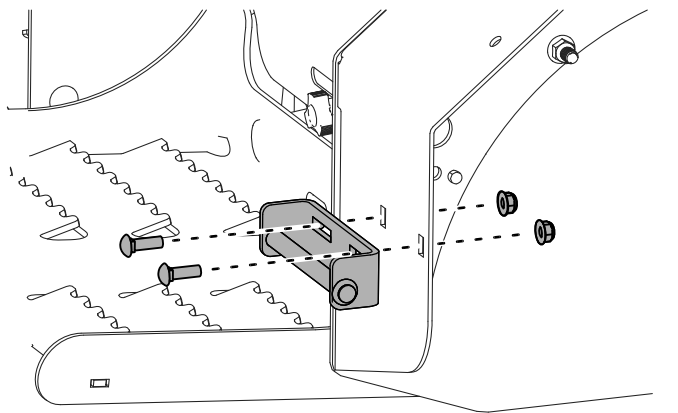


g446024

**Figure 3**

Snowrator

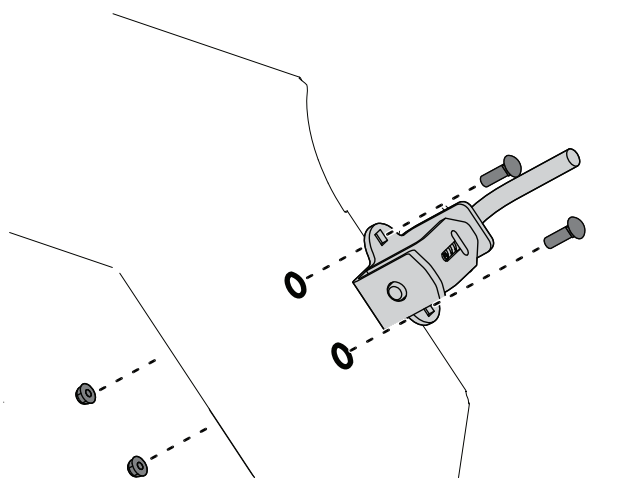




**Figure 4**  
Snowrator MAG

3. Install the upper mounting bracket and latch using 2 bolts (5/16 x 1 inch) and 2 nuts (5/16 inch).

**Note:** If your fender doesn't have mounting holes, proceed to [Drilling Mounting Holes on the Fender](#) (page 2).



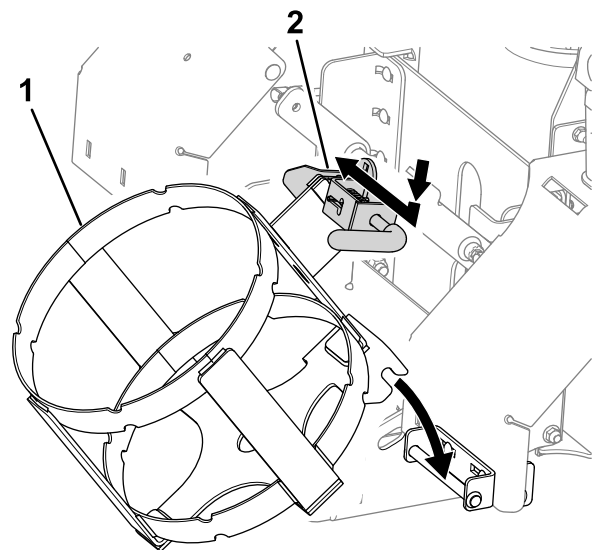
**Figure 5**

4. Torque the fasteners to 15 N·m (11 ft·lb).

## Drilling Mounting Holes on the Fender

**Note:** This step is for machines without mounting holes on the fenders. If your fenders do not have mounting holes as shown in [Figure 5](#), you will need to use the upper mounting bracket assembly as a guide to drill holes in the fenders.

1. Attach the mounting bracket assembly to the bucket holder by opening and then securing the latch pin. Mount the bucket holder to the mounting bar ([Figure 6](#)).



**Figure 6**

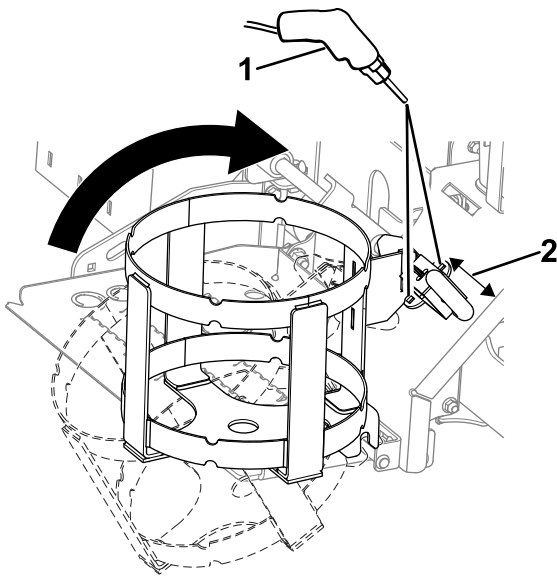
1. Bucket holder
2. Mounting bracket assembly

2. Rotate the bucket holder into the desired position so that the mounting bracket is flat against the fender surface and the holes in the bracket are 3-3/4 inches away from the edge of the fender ([Figure 7](#)). Using the mounting holes, mark and drill 2 holes (3/8 inch) ([Figure 7](#)).

### **⚠ WARNING**

Using a drill without proper eye protection may allow debris to enter the eye, causing injury.

When drilling, always wear eye protection.



**Figure 7**

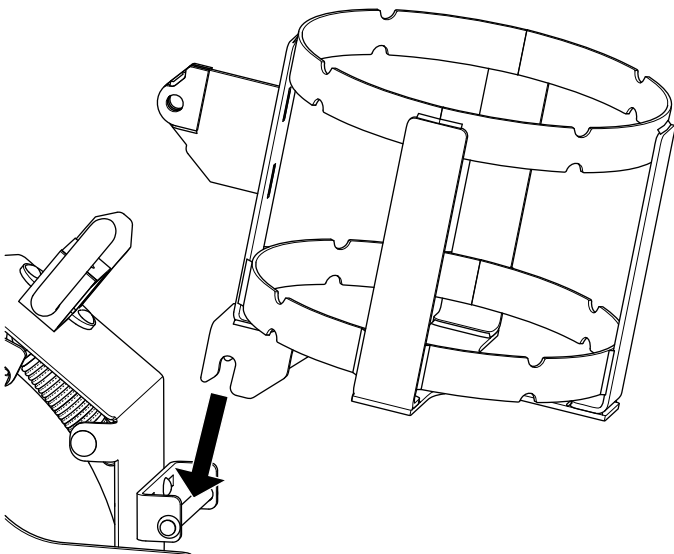
g448581

1. Drill 2 (3/8 inch) holes.
2. Reference dimension (3-3/4 inches)

3. Proceed to steps 3 and 4 in [Installing the Mounting Plates \(page 1\)](#).

## Installing the Bucket Holder on the Mounting Plates

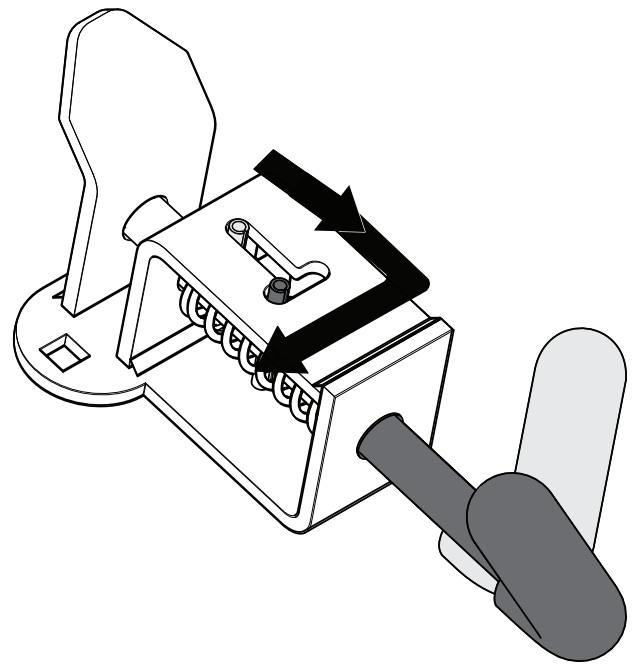
1. Place the bucket holder mounting flange on the mounting bar.



**Figure 8**

g400281

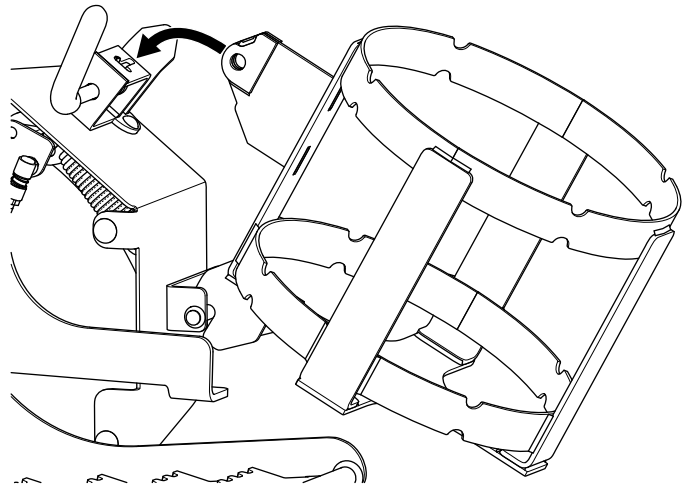
2. Pull back and lock the latch pin.



**Figure 9**

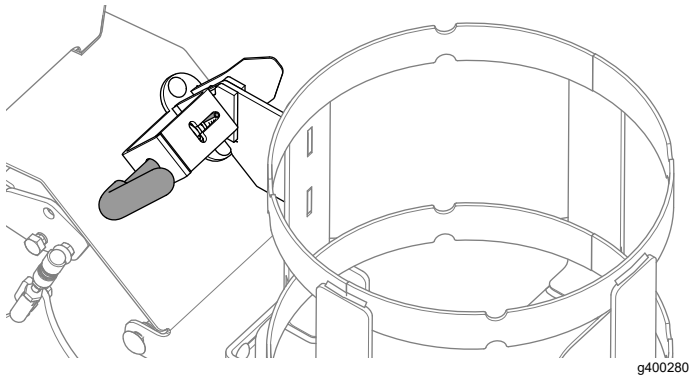
g382866

3. Rotate the bucket holder upright to the mounting hole and spring bracket. Release the latch pin to secure the assembly.



**Figure 10**

g400282



**Figure 11**

g400280