



P.O. Box 787
Iron Mountain, MI 49801
United States

Owner's Manual

TGS 600 and 1100 Tailgate Spreader

Part No. TGS06000

Part No. TGS11000

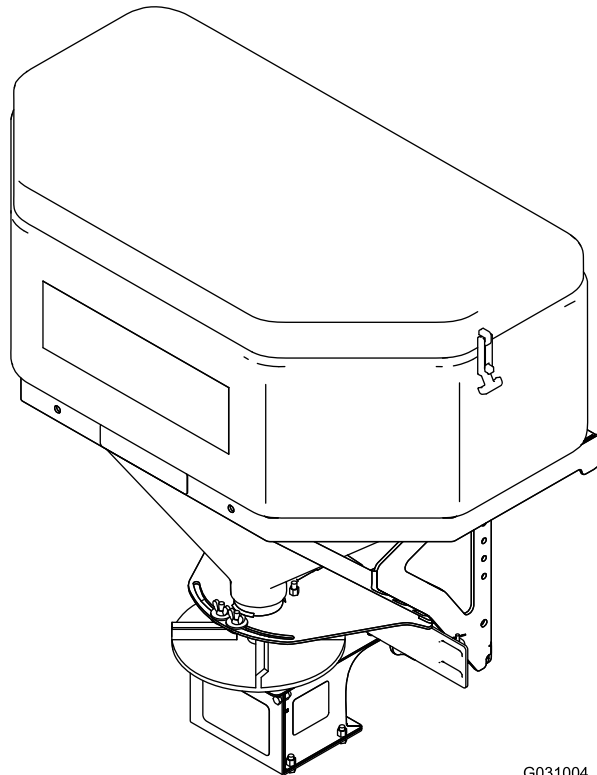

G031004



This product complies with all relevant European directives; for details, please see the separate product specific Declaration of Conformity (DOC) sheet.

which signals a hazard that may cause serious injury or death if you do not follow the recommended precautions.

⚠ WARNING

**CALIFORNIA
Proposition 65 Warning**

This product contains a chemical or chemicals known to the State of California to cause cancer, birth defects, or reproductive harm.



1. Safety alert symbol

Patents Pending.

This manual uses 2 words to highlight information. **Important** calls attention to special mechanical information and **Note** emphasizes general information worthy of special attention.

Introduction

This tailgate spreader is designed to spread salt on icy or snowy surfaces.

Read this information carefully to learn how to operate and maintain your product properly and to avoid injury and product damage. You are responsible for operating the product properly and safely.

You may contact BOSS directly at www.bossplov.com for product and accessory information, help finding a dealer, or to register your product.

Whenever you need service, genuine BOSS parts, or additional information, contact an Authorized Service Dealer or BOSS Customer Service and have the model and serial numbers of your product ready. **Figure 1** identifies the location of the model and serial numbers on the product. Write the numbers in the space provided.

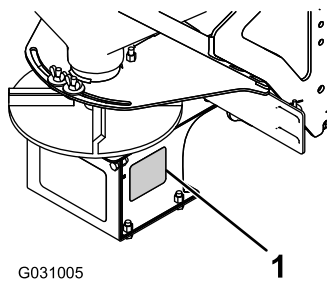

1. Serial number location

Model No. _____

Serial No. _____

This manual identifies potential hazards and has safety messages identified by the safety alert symbol (**Figure 2**),

Contents

Safety	3
Preparation.....	3
Operation.....	3
Safety and Instructional Decals	4
Setup	5
Installing the Wire Harness	5
Installing the Slide-In Attachment.....	6
Mounting the Spreader.....	6
Installing the RT3 Attachment	7
Mounting the Spreader.....	7
Installing the Spreader Controller	9
Product Overview	10
Controls	10
Specifications	11
Operation	12
Removing the Spreader	12
Mounting the Spreader.....	12
Removing the Spreader	13
Mounting the Spreader.....	13
Loading the Spreader	14
Operating the Spreader	15
Freeing a Clog.....	15
Adjusting the Material Deflectors	15
Operating Tips	16
Troubleshooting	17

Safety

Improperly using and maintaining the equipment can result in injury. To reduce the potential for injury, comply with these safety instructions and always pay attention to the safety-alert symbol **A**, which means: *Caution, Warning, or Danger*—personal safety instruction. Failure to comply with the instruction may result in personal injury or death.

Preparation

- Ensure that only trained personnel install and perform maintenance on the equipment.
- Always wear appropriate personal protective equipment when loading, unloading, and servicing the spreader. Wear substantial, slip-resistant footwear, cold-weather clothing, safety glasses, and dust protection.
- Ensure that your rearview mirror is in a good operating position.
- Many newer trucks are equipped with air bags. **Never** disable, remove, or relocate any sensors or other components related to the operation of the air bags.
- TGS 600 spreaders with slide-in or RT3 attachments must only be used with a minimum Class III receiver hitch. **Do not** exceed the vehicle hitch rating.
- TGS 1100 spreaders with the slide-in or RT3 attachments must only be used with a minimum Class IV receiver hitch. **Do not** exceed the vehicle hitch rating.
- The TGS 600 can hold a maximum weight of 181 kg (400 lb) of salt. **Do not** exceed this weight.
- The TGS 1100 can hold a maximum weight of 363 kg (800 lb) of salt. **Do not** exceed this weight.

Operation

- Read the *Operator's Manual* before operating or servicing the spreader.
- Do not operate the machine while ill, tired, or under the influence of alcohol or drugs.
- For vehicle-mounted spreaders, always follow the manufacturer's recommendations for proper parking procedures.
- Always wear your seatbelt while operating a motor vehicle.
- Do not exceed 22.5 km/h (14 mph) while spreading.
- This spreader has an operating sound level below 70 dBA.
- **Never** put any part of your body between the spreader and the vehicle.
- Overloading the spreader could result in an accident or damage. **Never** exceed the gross-vehicle-weight rating or the front or rear gross-axle-weight ratings for the vehicle.
- This spreader is restricted to the use of salt only. **Do not** run other materials through the spreader.
- **Do not** attempt to mount or remove the spreader with material in it.
- Turn the spreader off before filling, mounting, removing, servicing, or cleaning it.
- **Never** operate the spreader within 7.6 m (25 ft) of bystanders.
- **Do not** climb into or ride on the spreader.
- Keep your hands, feet, and clothing away from moving parts and mounting points.
- Mount the spreader to a vehicle before loading material.
- Install ratchet straps and keep them properly tightened with the slide-in and RT3 Attachments.
- When transporting the spreader, ensure that it is properly secured. Instructions are available at www.bossplo.com.
- The slide-in attachment must be fully engaged and pinned into the vehicle's 5 cm (2 inch) receiver hitch.
- The upper and lower pins of the RT3 attachment must be fully engaged and pinned into the vehicle's 5 cm (2 inch) receiver hitch.
- Material safety data sheets (MSDS) are available at www.bossplo.com.
- Use a 1/2 ton minimum lifting device to move heavy spreader components.
- **Do not** store material in the hopper.

Safety and Instructional Decals



Safety decals and instructions are easily visible to the operator and are located near any area of potential danger. Replace any decal that is damaged or lost.



TGS06269

- | | | | |
|--|---|--|---|
| 1. Warning—read the <i>Owner's Manual</i> . | 4. Warning—turn the machine off before filling. | 7. Warning—do not stand or ride on the machine. | 10. Warning—turn the machine off and disconnect the power before servicing the machine. |
| 2. Warning—all operators should be trained before operating the machine. | 5. Warning—empty the hopper and disconnect the power before installing or removing the machine. | 8. Warning—the machine must be installed before filling. | |
| 3. Loss of control hazard—do not overfill the machine. | 6. Thrown object hazard—keep bystanders a safe distance from the machine. | 9. Warning—do not store materials in the machine. | |

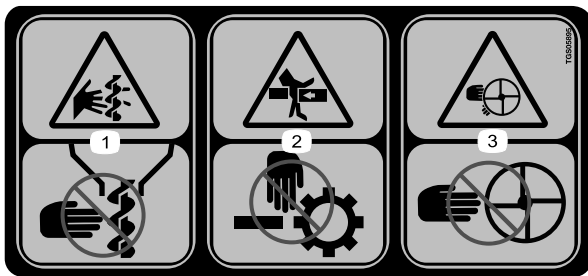

TGS05895

- | | |
|---|---|
| 1. Cutting/dismemberment hazard; auger—keep fingers and hands clear of the auger. | 3. Cutting/dismemberment hazard; spinner—keep fingers and hands clear of the spinner. |
| 2. Crushing hazard—keep fingers and hands clear of moving parts. | |

Setup

Note: Either the slide-in or RT3 attachment is required to install this machine. Contact your Authorized BOSS Dealer for more information.

Installing the Wire Harness

⚠ DANGER

Vehicle engines contain moving parts and can become extremely hot, capable of causing severe burns and serious bodily harm.

Stop the engine and allow it sufficient time to cool down before installing this kit.

⚠ DANGER

Vehicle batteries can cause dangerous electrical shocks that could lead to severe burns or death.

Disconnect your battery before installing this kit.

1. Secure the brown and white connector on the wire harness (Figure 3) to the center of your vehicle's rear bumper with a cable tie.
2. Route the wire harness along the driver-side frame-rail and into the engine compartment, and secure it with cable ties.

Note: Keep the wire harness away from any hot or moving parts.

3. Insert the controller connector through the firewall and into the vehicle cab, and secure it with cable ties.

Note: Route the connector to the location that you want to install your controller.

4. Connect the black ring connector to the negative (-) battery terminal (Figure 3).
5. Connect the red ring connector to the positive (+) battery terminal (Figure 3).
6. Wrap all of the excess wire and secure it in the engine compartment with cable ties..

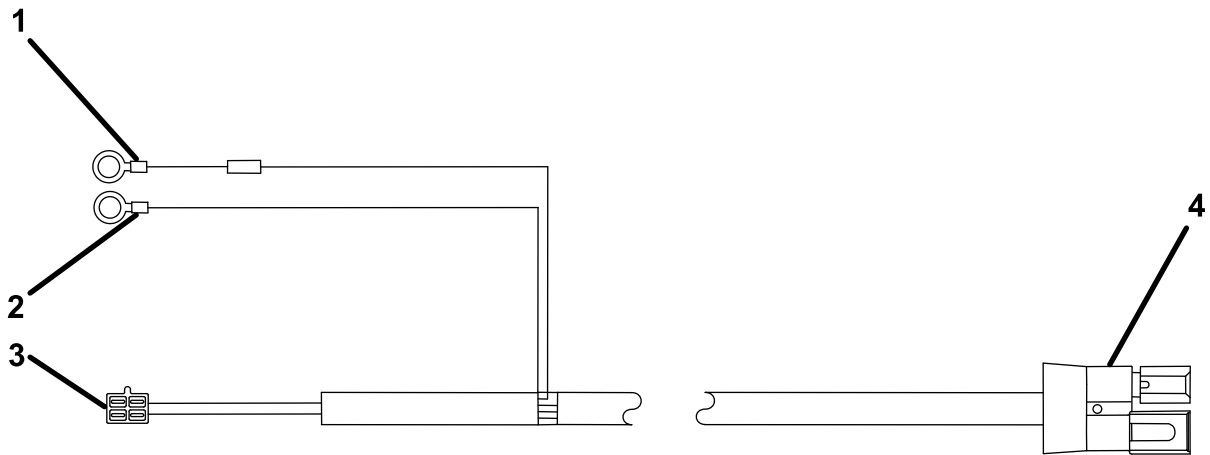

G031006

Figure 3

1. Red ring connector
2. Black ring connector
3. Controller connector
4. Brown and white connector

Installing the Slide-In Attachment

1. Mount the slide-in attachment to the spreader using 4 bolts (1/2 inch) and locknuts (1/2 inch) and torque the bolts to 76 Nm (56 ft-lb) (Figure 4).

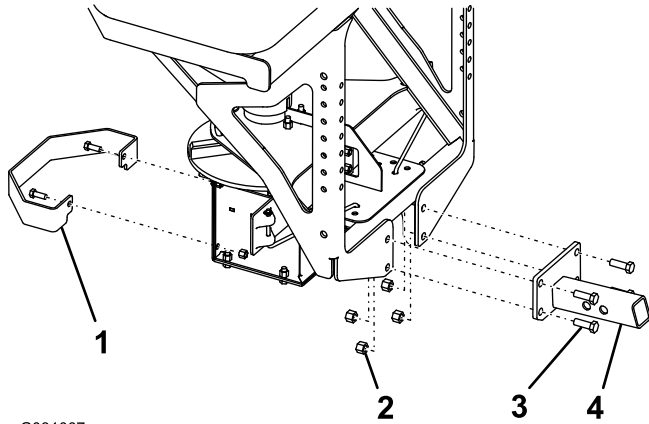

Figure 4

- | | |
|-----------------------|------------------------|
| 1. Spinner guard | 3. Bolt (1/2 inch) |
| 2. Locknut (1/2 inch) | 4. Slide-in attachment |

2. Mount the spinner guard to the spreader using the 2 existing bolts (3/8 inch) and locknuts (3/8 inch) and torque the bolts to 27 Nm (19.7 ft-lb) (Figure 4).

Mounting the Spreader

1. Attach the D-ring end of the ratchet straps to the upper holes on the outside of the spreader frame using a bolt (1/2 inch), washer (1/2 inch), and locknut (1/2 inch) and torque the bolts to 76 Nm (56 ft-lb) (Figure 5).

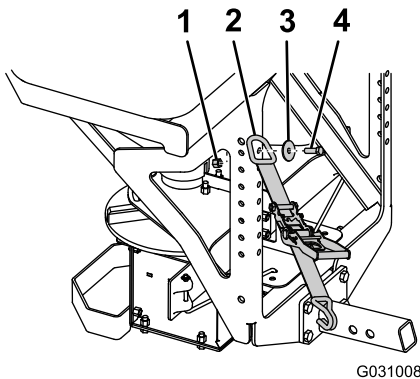

Figure 5

- | | |
|-----------------------|----------------------|
| 1. Locknut (1/2 inch) | 3. Washer (1/2 inch) |
| 2. Ratchet strap | 4. Bolt (1/2 inch) |

2. Slide the hitch on the spreader into the receiver hitch of your vehicle and line up the second hole on the spreader hitch with the hole in the hitch of your vehicle (Figure 6).

Note: If the spreader contacts the bumper of your vehicle, slide the spreader out and align the first hole of the spreader hitch instead.

⚠ DANGER

The spreader is heavy and could cause serious injury if dropped.

Ensure that your footing is stable, and avoid lifting the spreader on slippery or uneven surfaces.

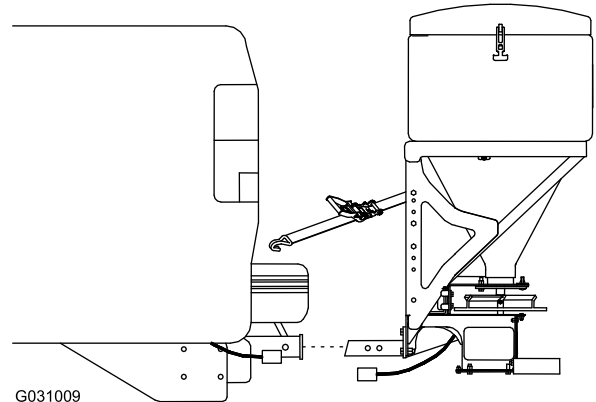

Figure 6

3. Secure the spreader hitch to the vehicle hitch using the clevis pin and cotter hairpin.
4. Attach the stabilizer arms to the spreader frame using 8 bolts (3/8 inch) and locknuts (3/8 inch) and torque the bolts to 27 Nm (19.7 ft-lb) as shown in Figure 7.

Note: Attach the arms so that the stabilizer pads contact your truck bed.

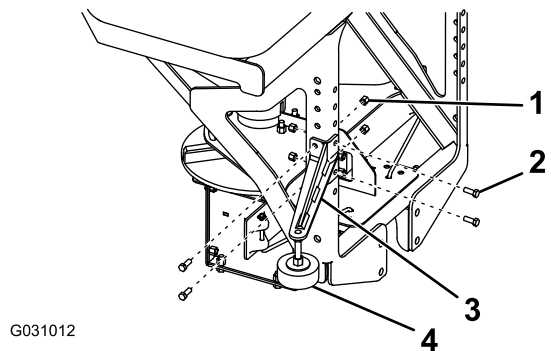

Figure 7

- | | |
|-----------------------|-------------------|
| 1. Locknut (3/8 inch) | 3. Stabilizer arm |
| 2. Bolt (3/8 inch) | 4. Stabilizer pad |

5. Rotate the pads on the stabilizer arms until they are tight against your truck bed and tighten the jam nut to secure them (Figure 7).
6. Slide the ends of the ratchet straps between your vehicle's bumper and tailgate and attach them to a solid point on the truck frame rail.

Note: You may have to drill a hole in the truck frame rail to attach them.

7. Plug the spreader harness into the brown and white connector from the vehicle wire harness as shown in [Figure 3](#).

Installing the RT3 Attachment

1. Mount the RT3 attachment to the spreader using 4 bolts (1/2 inch) and locknuts (1/2 inch) and torque the bolts to 76 Nm (56 ft-lb) ([Figure 8](#)).

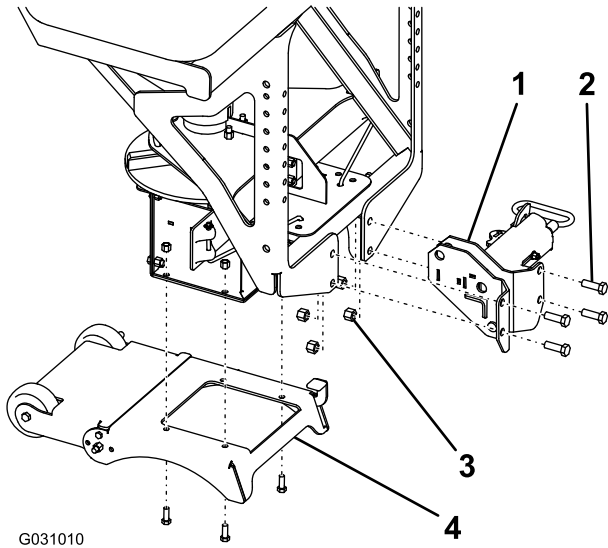

Figure 8

- | | |
|--------------------|-----------------------|
| 1. RT3 attachment | 3. Locknut (1/2 inch) |
| 2. Bolt (1/2 inch) | 4. Leg assembly |

2. Mount the leg assembly to the spreader using the 4 existing bolts (3/8 inch) and locknuts (3/8 inch) and torque the bolts to 27 Nm (19.7 ft-lb) ([Figure 8](#)).

Mounting the Spreader

1. Attach the D-ring end of the ratchet straps to the upper holes on the outside of the spreader frame using a bolt (1/2 inch), washer (1/2 inch), and locknut (1/2 inch) and torque the bolts to 76 Nm (56 ft-lb) ([Figure 5](#)).
2. Slide the RT3 hitch into the receiver hitch of your vehicle and line up the second hole on the spreader hitch with the hole in the hitch of your vehicle ([Figure 9](#)).

Note: If the spreader contacts the bumper of your vehicle, slide the spreader out and align the first hole of the spreader hitch instead.

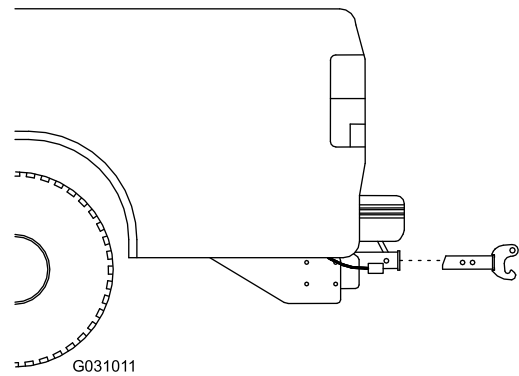

Figure 9

3. Secure the spreader hitch to the vehicle hitch using the clevis pin and cotter hairpin.
4. Rotate the locking lever on the RT3 attachment to the LOCK position ([Figure 10](#)).

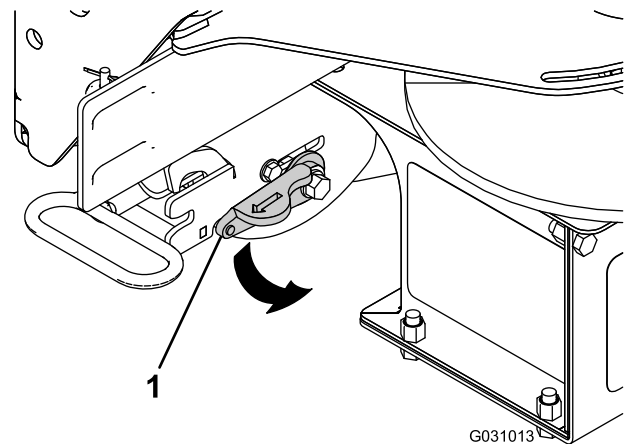

Figure 10

1. Locking lever

5. Grip the spreader firmly and step on the leg assembly to rotate it back until the bottom pin of the RT3 attachment clears the hook on the RT3 hitch ([Figure 11](#)).

⚠ DANGER

The spreader is heavy and could cause serious injury if dropped.

Ensure that your footing is stable, and avoid lifting the spreader on slippery or uneven surfaces.

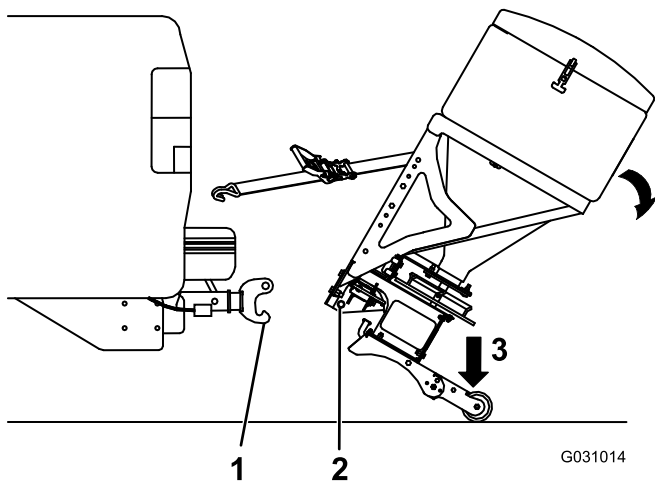

Figure 11

1. RT3 hitch hook
2. Bottom pin
3. Step here

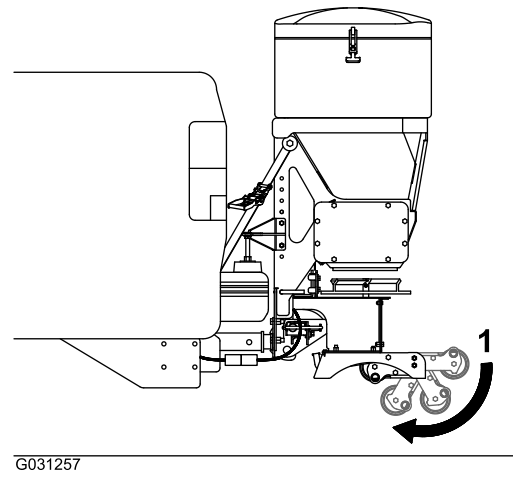

Figure 12

1. Leg-assembly wheels
12. Plug the spreader harness into the brown and white connector from the vehicle wire harness (Figure 3).

6. Push the spreader forward and lower the bottom pin of the RT3 attachment onto the hitch hook.
7. Tip the spreader upright until the top pin of the RT3 attachment locks into place.

⚠ DANGER

The spreader is heavy and could cause serious injury or property damage if it falls off your vehicle.

Ensure that the top pin of the RT3 attachment is fully locked into place and that the safety latch is down.

8. Attach the stabilizer arms to the spreader frame using 8 bolts (3/8 inch) and locknuts (3/8 inch) and torque the bolts to 27 Nm (19.7 ft-lb) (Figure 7).
- Note:** Attach the arms so that the stabilizer pads contact your truck bed.
9. Rotate the pads on the stabilizer arms until they are tight against your truck bed and tighten the jam nut to secure them (Figure 7).
10. Slide the ends of the ratchet straps between your vehicle's bumper and tailgate and attach them to a solid point on the truck frame rail.
- Note:** You may have to drill a hole in the truck frame rail to attach them.
11. Step on the leg-assembly wheels to pivot them and stow them under the leg assembly (Figure 12).

Installing the Spreader Controller

Mount the controller in the cab where it does not interfere with vehicle operation or visibility.

Important: Do not mount the controller in a location that vehicle occupants could contact it during a crash.

1. Remove the mounting bracket from the controller (Figure 13).

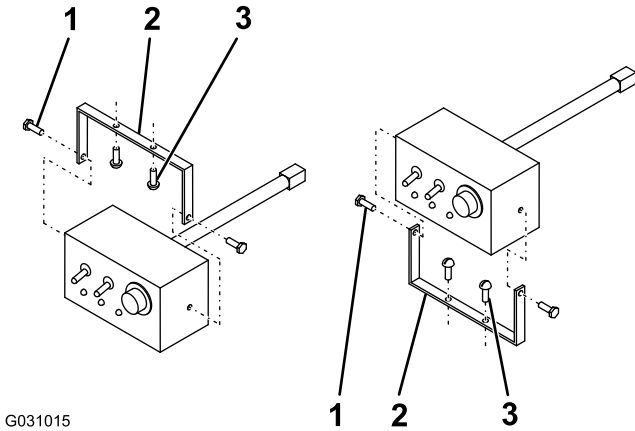

G031015

Figure 13

1. Mounting bracket bolt
2. Mounting bracket
3. Sheet-metal screw

-
2. Attach the mounting bracket to the vehicle using 2 sheet-metal screws (Figure 13).
 3. Attach the controller to the mounting bracket with the previously removed bolts.

Note: Position the controller screen so that it is clearly visible to the driver.

4. Connect the wire harness controller connector to the controller.

Product Overview

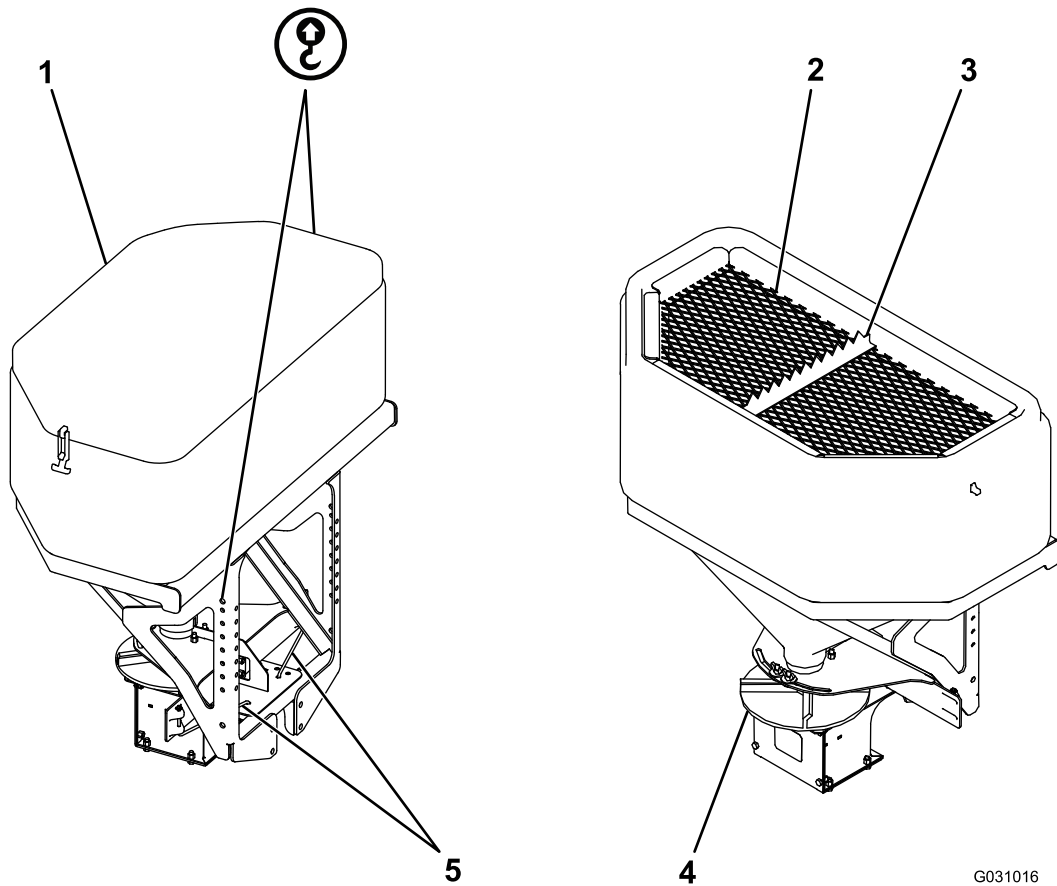

Figure 14

G031016

- 1. Hopper cover
- 2. Top screen
- 3. Bag splitter

- 4. Spinner
- 5. Material deflector adjustment pins

Controls

Become familiar with all the controls before you operate the spreader.

Material Deflector

The material deflector controls the spread of materials; you can adjust the controls to provide different spread patterns; refer to [Adjusting the Material Deflectors \(page 15\)](#).

Spreader Controller

The spreader controller lets you operate your spreader and displays information about your machine.

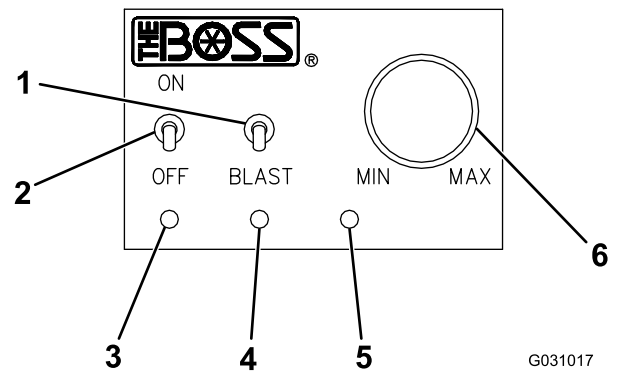

Figure 15

G031017

- 1. BLAST button
- 2. ON/OFF button
- 3. Green LED
- 4. Yellow LED
- 5. Red LED
- 6. SPEED dial

- ON/OFF switch—turns the spinner motor on or off
- BLAST switch—momentarily sends full power to the spinner motor as long as it is pressed.
- SPEED dial—increases the spinner motor speed when turned clockwise, and decreases the spinner motor speed when turned counterclockwise.
- Green LED—indicates that the controller is on and the spinner motor is turning
- Yellow LED—indicates that the BLAST switch is active
- Red LED—indicates that the spreader is clogged and the controller is being overloaded

Specifications

Note: Specifications and design are subject to change without notice.

	TGS 600	TGS 1100
Hopper height	65 cm (25.75 inches)	86 cm (34 inches)
Hopper width	97 cm (38 inches)	112 cm (44 inches)
Hopper depth	53 cm (21 inches)	61 cm (24 inches)
Weight (empty)	46 kg (101 lb)	69 kg (152 lb)
Capacity	0.2 m ³ (6 ft ³)	0.3 m ³ (11 ft ³)

Operation

Note: Determine the left and right sides of the machine from the normal operating position.

Removing the Spreader Equipped with the Slide-In Attachment

1. Ensure that the spreader controller is in the OFF position.
2. Unplug the spreader wire harness from the vehicle wire harness and attach the weather caps to each end.
3. Loosen the ratchet straps and stabilizer arms.
4. Remove the cotter hairpin and clevis pin from the vehicle hitch.
5. Slide the spreader out of the receiver hitch of your vehicle (Figure 16).

⚠ DANGER

The spreader is heavy and could cause serious injury if dropped.

Ensure that your footing is stable, and avoid lifting the spreader on slippery or uneven surfaces.

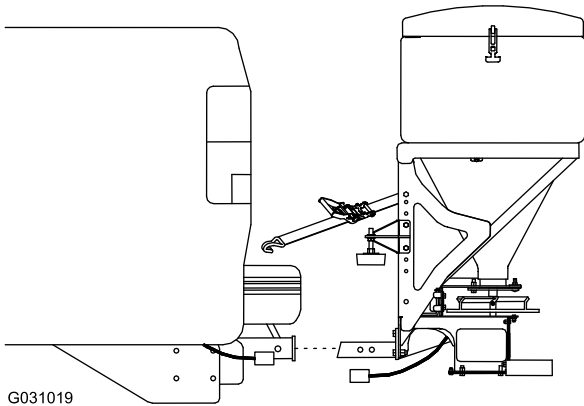

Figure 16

⚠ DANGER

The spreader is heavy and could cause serious injury if dropped.

Ensure that your footing is stable, and avoid lifting the spreader on slippery or uneven surfaces.

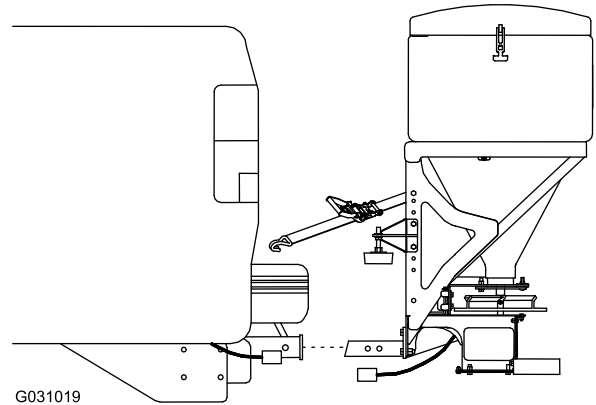

Figure 17

3. Secure the spreader hitch to the vehicle hitch using the clevis pin and cotter hairpin.
4. Rotate the pads on the stabilizer arms until they are tight against your truck bed and tighten the jam nut to secure them.
5. Slide the ends of the ratchet straps between your vehicle's bumper and tailgate and attach them to a solid point on the truck frame rail.
6. Remove the weather caps from both the vehicle and spreader wire harnesses, and plug the spreader harness into the vehicle wire harness.

6. Move the spreader to your storage area.

Mounting the Spreader Equipped with the Slide-In Attachment

1. Ensure that the spreader controller is in the OFF position.
2. Slide the hitch of the spreader into the receiver hitch of your vehicle and line up the second hole on the spreader hitch with the hole in the hitch of your vehicle (Figure 17).

Note: If the spreader contacts the bumper of your vehicle, slide the spreader out and align the first hole of the spreader hitch instead.

Removing the Spreader

Equipped with the RT3 Attachment

1. Ensure that the spreader controller is in the OFF position.
2. Unplug the spreader wire harness from the vehicle wire harness and attach the weather caps to each end.
3. Pivot the leg-assembly wheels from under the spreader (Figure 18).

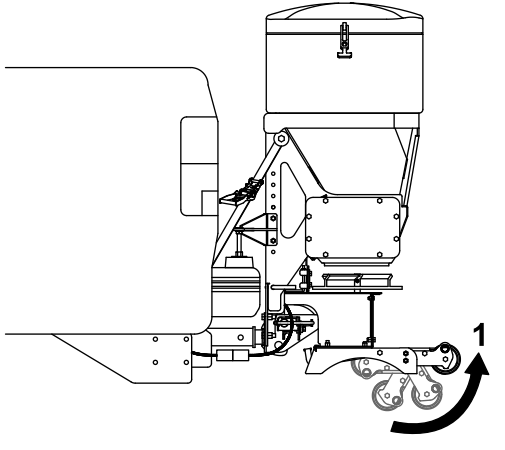

G031258

Figure 18

1. Leg-assembly wheels

4. Loosen the ratchet straps and stabilizer arms.
5. Rotate the locking lever on the RT3 attachment to the UNLOCK position (Figure 19).

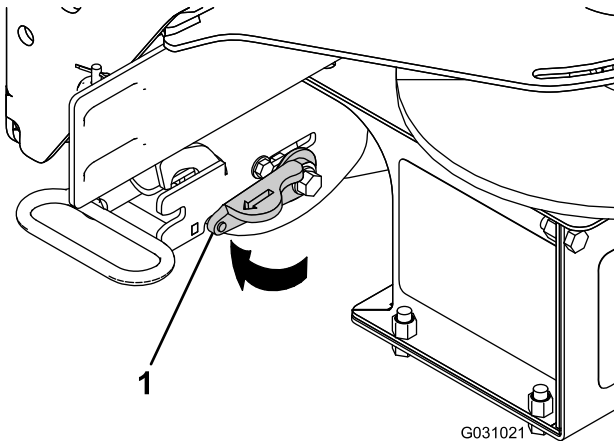

G031021

Figure 19

1. Locking lever

6. Tilt the spreader down to release the top pin of the RT3 attachment (Figure 20).

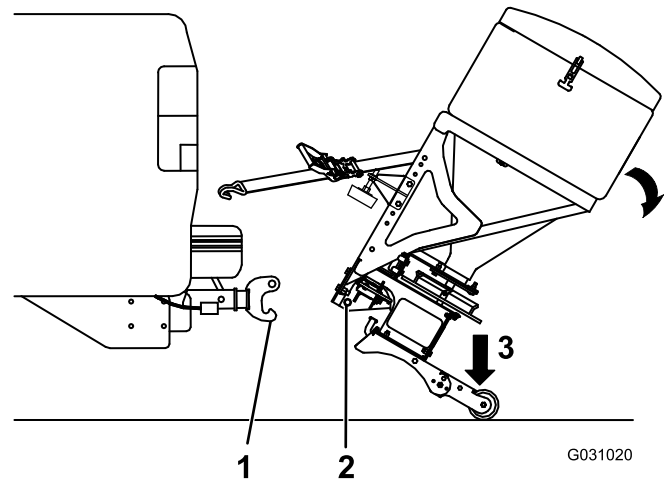

G031020

Figure 20

1. RT3 hitch hook
2. Bottom pin
3. Step here

7. Grip the spreader firmly and step on the leg assembly to rotate it back until the bottom pin of the RT3 attachment clears the hook on the RT3 hitch (Figure 20).

⚠ DANGER

The spreader is heavy and could cause serious injury if dropped.

Ensure that your footing is stable, and avoid lifting the spreader on slippery or uneven surfaces.

8. Pull the spreader back and lower it to the ground.
9. Move the spreader to your storage area.

Mounting the Spreader

Equipped with the RT3 Attachment

1. Ensure that the spreader controller is in the OFF position.
2. Rotate the locking lever on the RT3 attachment to the LOCK position (Figure 21).

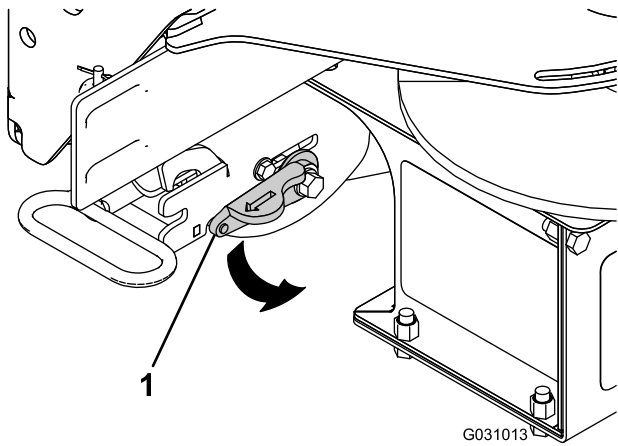

Figure 21

1. Locking lever

3. Grip the spreader firmly and step on the leg assembly to rotate it back until the bottom pin of the RT3 attachment clears the hook on the RT3 hitch (Figure 22).

⚠ DANGER

The spreader is heavy and could cause serious injury if dropped.

Ensure that your footing is stable, and avoid lifting the spreader on slippery or uneven surfaces.

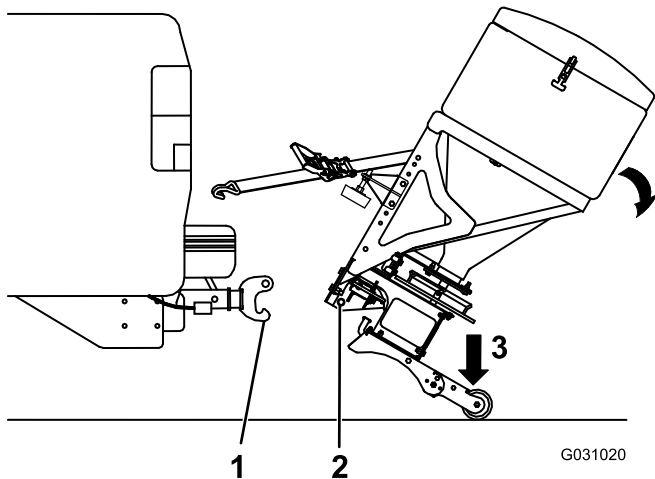

Figure 22

1. RT3 hitch hook
2. Bottom pin
3. Step here

4. Push the spreader forward and lower the bottom pin of the RT3 attachment onto the hitch hook.
5. Tip the spreader upright until the top pin of the RT3 attachment locks into place.

⚠ DANGER

The spreader is heavy and could cause serious injury or property damage if it falls off your vehicle.

Ensure that the top pin of the RT3 attachment is fully locked into place and that the safety latch is down.

6. Rotate the pads on the stabilizer arms until they are tight against your truck bed and tighten the jam nut to secure them.
7. Slide the ends of the ratchet straps between your vehicle's bumper and tailgate and attach them to a solid point on the truck frame rail.
8. Step on the leg-assembly wheels to pivot them and stow them under the leg assembly (Figure 23).

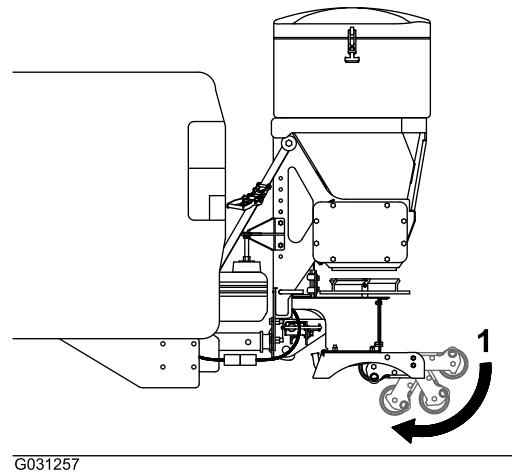

Figure 23

1. Leg-assembly wheels

9. Remove the weather caps from both the vehicle and spreader wire harnesses, and plug the spreader harness into the vehicle wire harness.

Loading the Spreader

Important: Only use dry salt in the spreader. Other materials could cause damage to the machine.

1. Ensure that the spreader is securely mounted to your vehicle and is not over slippery or uneven terrain.
2. Remove the hopper cover and ensure that the top screen is installed and closed.
3. Determine the amount of material that you can safely transport in your spreader; refer to [Specifications \(page 11\)](#).
4. Fill the hopper with salt using the following methods:
 - If using bagged salt, place the bag on the top screen bag splitter and work it back and forth to split the

bag. Continue to move and shake the bag until it is empty.

Note: Use 2 people to lift any bagged salt weighing more than 18 kg (40 lb).

Note: Keep hands and fingers clear of the bag splitter when loading materials.

- If using dry bulk salt, load the salt into the hopper through the top screen to break up any large, impassable chunks of salt that may clog the spreader.

Operating the Spreader

⚠ DANGER

Hands, feet, and clothing can get caught in the moving parts of the spreader and cause serious bodily injury and loss of limbs.

Keep your hands, feet, and clothing away from the moving spinner and attachment points.

⚠ CAUTION

The spreader throws material at a high speed that could cause minor injuries to bystanders.

Bystanders should stay a minimum of 7.6 m (25 ft) away from operating spreaders.

1. Flip the ON/OFF SWITCH to the ON position.
Note: Always check for bystanders before starting the spreader.
2. Use the speed dial to set your desired spinner speed.
Note: The spinner speed will determine how quickly the material is spread as well as how far it is thrown.
3. While spreading, you can press the BLAST switch to momentarily increase the speed of the spinner motor.
4. Flip the ON/OFF SWITCH to the OFF position when you are finished spreading to stop the spreader.

Freeing a Clog

The red LED on the spreader controller will illuminate when debris gets wedged in the spreader and the controller is overloaded.

1. If the red LED illuminates, quickly pulse the BLAST button.
2. If the clog is not cleared automatically, disconnect the spreader wire harness and manually free the clog.

Adjusting the Material Deflectors

You can adjust the material deflectors by inserting the deflector pins into the staggered holes near the spinner (Figure 24).

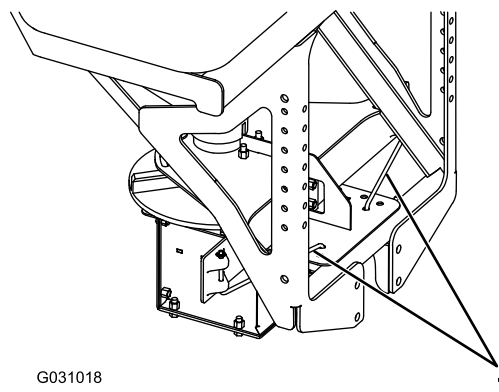

G031018

Figure 24

1. Material deflector pins

You can adjust the spread pattern by positioning the deflectors as shown in Figure 25.

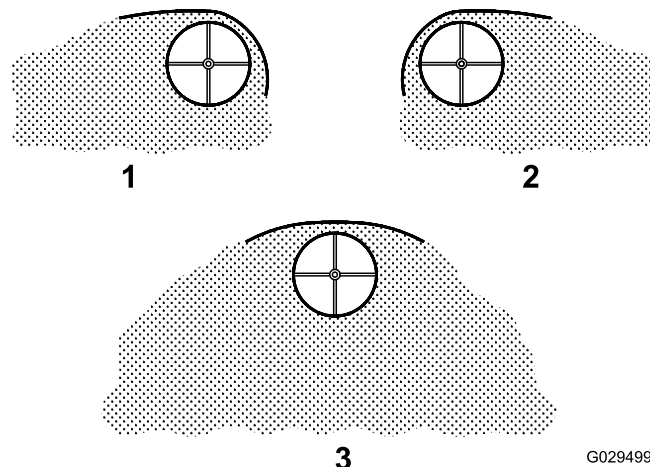

G029499

Figure 25
Deflection Settings

1. Driver side open
2. Passenger side open
3. Both sides open

Operating Tips

- Know the area in which you are working; hidden obstructions such as curbs, sidewalks, and pipes, can damage your spreader or vehicle.
- Do not let the ice build up; always start as soon as possible.
- Always wear your seatbelt when spreading.
- Always remember to spread at a safe speed. Spreading faster can be hard on your vehicle as its load is greatly increased.
- **Never** ride on or put body parts into the spreader while servicing or operating it.

Troubleshooting

Problem	Possible Cause	Corrective Action
The controller has no power (the green LED is not on).	<ol style="list-style-type: none"> 1. The battery connections are corroded. 2. The 40 amp in-line fuse in the vehicle side harness is bad. 3. The controller is not plugged into the vehicle side harness. 	<ol style="list-style-type: none"> 1. Clean the battery connections. 2. Replace the fuse. 3. Plug in the controller.
The spinner motor does not work.	<ol style="list-style-type: none"> 1. The spreader and vehicle wire harnesses are not connected. 2. The controller is not plugged into the vehicle side harness. 3. The spinner motor is not connected to the spreader side harness. 	<ol style="list-style-type: none"> 1. Connect the wire harnesses. 2. Plug in the controller. 3. Contact your Authorized Service Dealer.
The red LED is lit on the controller.	<ol style="list-style-type: none"> 1. The spreader is jammed. 	<ol style="list-style-type: none"> 1. Refer to the Freeing a Clog section.
The spinner motor works but the spinner and auger are not turning.	<ol style="list-style-type: none"> 1. The connection between the auger and spinner and the motor shaft is bad. 2. The connection between the motor shaft and the motor hub is bad. 	<ol style="list-style-type: none"> 1. Contact your Authorized Service Dealer. 2. Contact your Authorized Service Dealer.

Notes:

BOSS Products Commercial Warranty

What this warranty covers:

This warranty covers defects in material and workmanship except as set forth below.

Who is covered:

The original purchaser from an authorized dealer.

For how long:

Complete Product: 2 years from the date of purchase.

Labor: 2 years from the date of purchase for complete product.

Parts: 1 year from the date of purchase. (no Labor)

What BOSS Products will do:

BOSS Products will, at its sole option, repair or replace defective parts at no charge.

What you must do for warranty service:

To obtain warranty service, purchaser must return the defective product to any authorized BOSS Products dealer (preferably the one from whom the product was purchased) within the warranty period. Purchaser must be able to verify the original purchase date. All transportation costs to and from the dealer will be the responsibility of the purchaser. To locate the authorized BOSS dealer nearest to you, call toll free: (800) 286-4155.

What is not covered:

1. Expendable parts such as hoses, plow shoes, cutting edges, pins, nuts, bolts, blade guides, etc.
2. Products repaired or altered by anyone other than an authorized BOSS Products dealer.
3. Products which have been subject to misuse, negligence, accident, improper installation, maintenance, care, or storage.
4. Products mounted on vehicles other than those listed in the *BOSS Snowplow Application Chart and Selection Guide*.
5. BOSS Products does not assume liability for damage to your motor vehicle resulting from the attachment or use of any BOSS products. Vehicle risk is the sole responsibility of the purchaser.

Limits of BOSS Products Liability are:

BOSS Products' liability is expressly limited to repair or replacement of defective parts. BOSS Products shall not be liable for consequential, incidental, or contingent damages whatsoever, even if damages are caused by the negligence or fault of BOSS Products. The foregoing warranties are exclusive and in lieu of all other express and implied warranties including, but not limited to, the implied warranties of merchantability and fitness for a particular purpose.

This warranty does not apply if you purchased your product for personal, family, or household use. In this case, refer to the BOSS Products Limited Consumer Warranty.

BOSS Products is a division of
The Toro® Company
P.O.Box 787 2010 The BOSS Way
Iron Mountain, MI 49801

(2016-2017)

BOSS Products Consumer Warranty

What this warranty covers:

This warranty covers defects in material and workmanship except as set forth below.

Who is covered:

The original retail purchaser of a BOSS product who purchases it for personal, family, or household use.

For how long:

Complete Product: 2 years from the date of purchase.

Labor: 2 years from the date of purchase for complete product.

Parts: 1 year from the date of purchase. (no Labor)

What BOSS Products will do:

BOSS Products will, at its sole option, repair or replace defective parts at no charge.

What you must do for warranty service:

To obtain warranty service, purchaser must return the defective product to any authorized BOSS Products dealer (preferably the one from whom the product was purchased) within the warranty period. Purchaser must be able to verify the original purchase date. All transportation costs to and from the dealer will be the responsibility of the purchaser. To locate the authorized BOSS dealer nearest to you, call toll free: (800) 286-4155.

What is not covered:

1. Expendable parts such as hoses, plow shoes, cutting edges, pins, nuts, bolts, blade guides, etc.
2. Products repaired or altered by anyone other than an authorized BOSS Products dealer.
3. Products which have been subject to misuse, negligence, accident, improper installation, maintenance, care, or storage.
4. Products mounted on vehicles other than those listed in the *BOSS Snowplow Application Chart and Selection Guide*.
5. BOSS Products does not assume liability for damage to your motor vehicle resulting from the attachment or use of any BOSS products. Vehicle risk is the sole responsibility of the purchaser.

Limits of BOSS Products Liability are:

BOSS Products' liability is expressly limited to repair or replacement of defective parts. BOSS Products shall not be liable for consequential, incidental, or contingent damages whatsoever, even if damages are caused by the negligence or fault of BOSS Products. The foregoing warranties are exclusive and in lieu of all other express and implied warranties including, but not limited to, the implied warranties of merchantability and fitness for a particular purpose.

State laws:

Some states do not allow exclusion of incidental or consequential damages or the limitations on how long an implied warranty lasts, so these limitations or exclusions may not apply to you. This warranty gives you specific legal rights and you may also have the other rights which vary from state to state.

This warranty does not apply if you purchased your product for personal, family, or household use. In this case, refer to the BOSS Products Limited Consumer Warranty.

BOSS Products is a division of
The Toro® Company
P.O.Box 787 2010 The BOSS Way
Iron Mountain, MI 49801

(2016-2017)