

SNOWPLOW

BOSS PRODUCTS
A Division of Northern Star Industries, Inc.
P.O. Box 787 Iron Mountain MI 49801-0787
www.bossplow.com

**V-BOX SPREADER
VIBRATOR KIT
INSTALLATION MANUAL
VBS14465/6**

BOSS Products / Northern Star Industries, Inc. reserves the right under its continuous product improvement policy to change construction or design details and furnish equipment when so altered without reference to illustrations or specifications used herein.

PUSHING THE EDGE

VBS14572-0

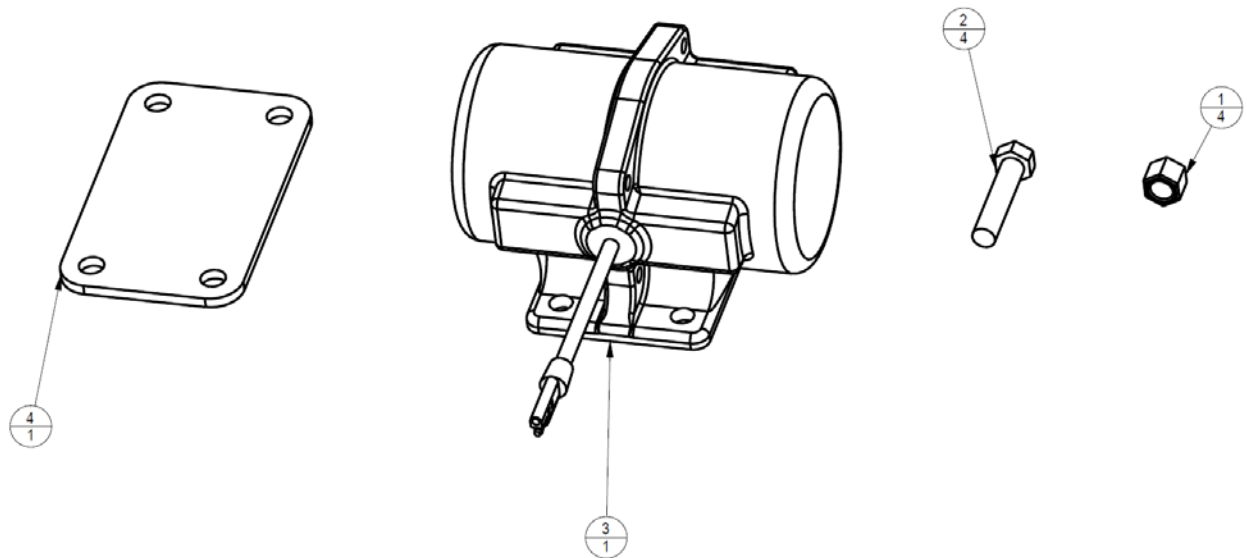

Figure 1: VBS14465 Vibrator Kit contents.

G10690

REF. NO.	DESCRIPTION	PART NO.	QTY.
1	NUT,NYL LOCK,3/8-16,ST/ST 18-8 MOLY-THRD	HDW05854	4
2	HHCS,3/8-16 X 1 3/4",ST/ST 18-8	HDW14433	4
3	VIBRATOR,12VDC,200LB	MSC14275	1
4	BACKER,PLT,IVB	VBS14301	1

Note: Shown components and instructions are for Single Vibrator Kit (VBS14465). For Dual Vibrator Kit (VBS14466) repeat method on each side of unit.

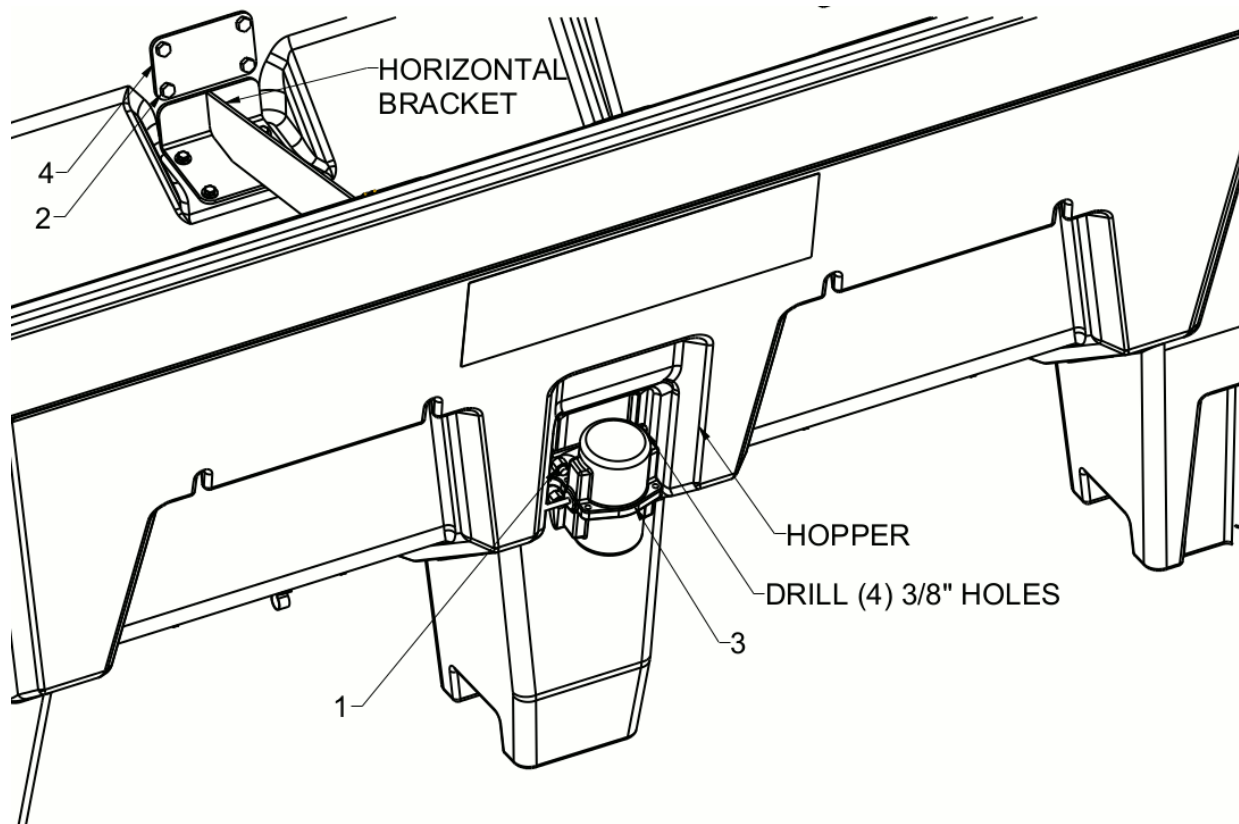

Figure 2: Vibrator Location (Note: dual kit shown)

G10691

1. Align Backing Plate (4) onto side of Hopper and mark hole locations for drilling. Drill four 3/8" holes through slots in Hopper. Holes can be drilled from either inside or outside of Hopper. Vibrator can be attached to either driver side or passenger side.

Note: If applicable, be sure Backing Plate (4) is above Horizontal Bracket of Inverted V inside Hopper. Refer to Figure 2. Inverted V is not required for Vibrator Kit installation.

2. Attach Vibrator (3) onto outside of hopper using Backing Plate (4), 3/8"-16 X 1-3/4 HHCS ST/ST (2), and 3/8"-16 ST/ST Nylon Locknuts (1). Refer to Figure 3. Be sure bolts are properly torqued. Refer to Table 1.
3. Connect Vibrator (3) wiring to Spreader main harness.

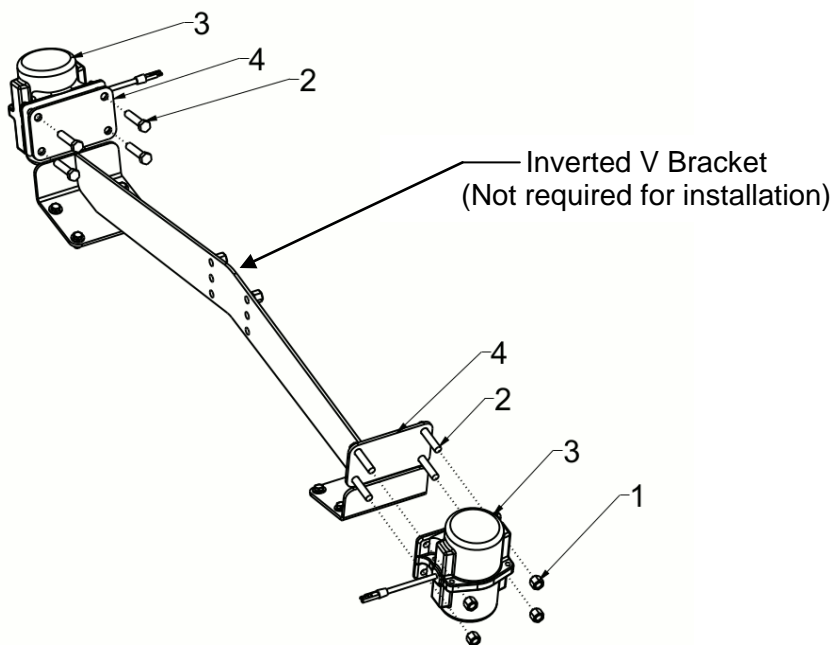

Figure 3: Bolt Configuration

G10692

GUIDE TO RECOMMENDED ASSEMBLY TORQUE

All Torque Values Are In Foot-Pounds (Ft.-Lb.)

DIA./PITCH	CLASS	GRADE 5	GRADE 8
1/4 - 20		6	9
5/16 - 18		14	19
3/8 - 16		23	33
7/16 - 14		38	53
1/2 - 13		56	80
9/16 - 12		82	116
5/8 - 11		113	159
3/4 - 10		201	283
M10-1.5	49		
M12-1.75	86		

Table 1: Recommended Torque Values

* The torque values listed above are based on dry, coated bolts, variables such as oil, or other lubrications may appreciably alter these values and must be taken into consideration.

VIBRATOR OPERATION

The Vibrator can only be activated when the V-Box Spreader is attached to the Vehicle and the Feed System is on.

The Vibrator should not be activated when the V-Box Spreader's hopper is empty. This causes un-due wear to the Vibrator Motor.

Check all hardware on the Vibrator and on the V-Box Spreader after using the Vibrator. Excessive use may loosen hardware.