

BOSS PRODUCTS
A Division of Northern Star Industries, Inc.
P.O. Box 787 Iron Mountain MI 49801-0787
www.bossplov.com

**1992 - 1997 FORD
F250 AND F350 (GASOLINE & DIESEL)
RT II™ UNDERCARRIAGE
MOUNTING INSTRUCTIONS
(PART NO. LTA03500)**

WARNING

Many newer trucks are now equipped with air bags. DO NOT under any circumstances disable, remove or relocate any sensors or other components related to the operation of the air bags.

Always follow the vehicle manufacturer's recommendations relating to snowplow installation. For recommended vehicle models refer to the Boss Snowplow Application Chart and Selection Guide.

1992 - 1997 FORD F250 AND F350 (GASOLINE AND DIESEL) UNDERCARRIAGE MOUNTING INSTRUCTIONS (WITH RAPID-TACH II™)

The mounting procedure outlined below covers FORD (1992 - 1997) F250 and F350 trucks equipped with gasoline and diesel engines. You will need to refer to the illustrations and familiarize yourself with each of the undercarriage components and their relative position to each other. Then proceed as follows:

1. Remove the Front Bumper. Remove the Bumper mounting bolts. Insert the BOLT BAR (Ref. 100, Fig. 1) inside the frame rail. Using the 3/8" BOLT PULLERS, pull bolt through frame and install the FRAME GUSSET (Ref. 98R and 98L, Fig. 1). Fasteners should only be finger tight.
2. Position the ANGLE BRACKET (Ref. 62A and 62B, Fig. 1) behind the FRAME GUSSET, and secure with 1/2" – 13 x 3" FULL THREAD BOLT, 1/2" HARDENED WASHERS, and 1/2" – 13 NUT. Insert the bolt from the rear, with the nut in the front. Tighten Nuts finger tight.
3. Position the FRAME MOUNTS (Ref. 75R and 75L, Fig. 1) on the ANGLE BRACKET, and fasten with the 5/8" – 11 x 2" HEX HEAD BOLT and 5/8" – 11 SELF LOCKING NUTS provided. Tighten Nuts finger tight.
4. Raise the FRAME MOUNTS up tight against the frame. Mark and drill the top hole of the FRAME MOUNTS. Fasten the FRAME MOUNTS to the Frame using 5/8"-11 NUTS, 5/8" SPLIT LOCK WASHERS, and BOLT PULLERS.(Ref. 99, Fig. 1)
5. Attach the CROSS MEMBER WELDMENT (Ref. 62C, Fig. 1) to the ANGLE BRACKET (Ref. 62A and 62B, Fig. 1) using 1/2" – 13 x 1- 1/2" HEX HEAD BOLTS and 1/2" – 13 SELF LOCKING NUTS.
6. Attach the PUSHBEAM (Ref. 62, Fig. 1) to the ANGLE BRACKETS (Ref. 62B and 62C, Fig. 1) using 1/2" – 13 x 1- 1/2" HEX HEAD BOLTS and 1/2" – 13 SELF LOCKING NUTS provided.

NOTE: The proper height adjustment for the PUSH BEAM is approximately 12- 1/2" for the 7'6" V or 13- 1/2" for the 8'2" V, 9'2" V, and straight blade from the ground to the center of the PUSH BEAM MOUNTING ROD (see Fig. 2). Should the PUSH BEAM ASSEMBLY be mounted too

high, the nose of the plow will tend to dig in while plowing. If the PUSH BEAM ASSEMBLY is mounted too low the wings of the plow will not lay flat against the ground. This will be most apparent when plowing in the SCOOP position.

7. Adjust the spacing of the bumper mounting bolts (Ref. G, Fig. 1) to match the spacing on the bumper then torque the bolts as specified in Figure 3. Install the Bumper and secure with ½" – 13 SELF LOCKING NUTS and ½" HARDENED WASHERS provided. Tighten the ½" – 13 SELF LOCKING NUTS as specified in Figure 3.

8. With the FRAME MOUNTS pushed tightly against the frame, torque the 5/8"-11 NUTS as specified in Figure 3. Next torque the 5/8" – 11 x 2" HEX HEAD BOLTS connecting the ANGLE BRACKET to the FRAME MOUNT. Finally, torque the ½" – 13 x 1- ½" HEX HEAD BOLTS attaching the PUSH BEAM to the ANGLE BRACKETS.

9. Verify that there is adequate clearance between the LEFT ANGLE BRACKET (Ref. 62B, Fig.1) and the pitman arm of the steering linkage.

1992 & NEWER FORD F250 & F350 (GASOLINE AND DIESEL) UNDERCARRIAGE (WITH RAPID-TACH II™) INSTALLATION PROCEDURE

REF. NO.	DESCRIPTION	PART NO.	QTY.
62	Push Beam	PBA03503	1
62A	Angle Bracket (RH)	LTA04466	1
62B	Angle Bracket (LH)	LTA04465	1
62C	Cross Member Weldment	PBA03564	1
98R	Frame Gusset (RH)	LTA03317	1
98L	Frame Gusset (LH)	LTA03316	1
75R	Frame Mount (RH)	LTA03568	1
75L	Frame Mount (LH)	LTA03569	1
99	Bolt Bar-Frame Mount	LTA04369	4
100	Bolt Bar-Frame Gusset	LTA03334	2

UNDCG HDW BG, 92-96 FORD	HDW01791	1
--------------------------	----------	---

Includes:

A	½" – 13 x 1-½" Hex Head Bolt	HDW01728	12
B	½" – 13 Self Locking Nut	HDW01748	16
C	5/8" – 11 x 2" Hex Head Bolt	HDW01731	4
D	5/8" – 11 Self Locking Nuts	HDW01709	10
E	5/8" – 11 x 1-½" Hex Head Bolt	HDW01727	2
F	5/8" Flat Washer	HDW01726	2
G	½" – 13 x 3 Hex Head Bolt, Full Threaded	HDW05508	4
H	½" Hardened Washer	HDW05507	16
J	½" – 13 Nut	HDW02410	4
K	3/8" – 16 Nut	HDW01720	4
L	3/8" Split Lock Washer	HDW01718	4
M	5/8" Split Lock Washer	HDW01733	4
N	5/8"-11 Nut	HDW03891	4
O	3/8"-16 x 1-½" Hex Head Bolt	HDW05596	4

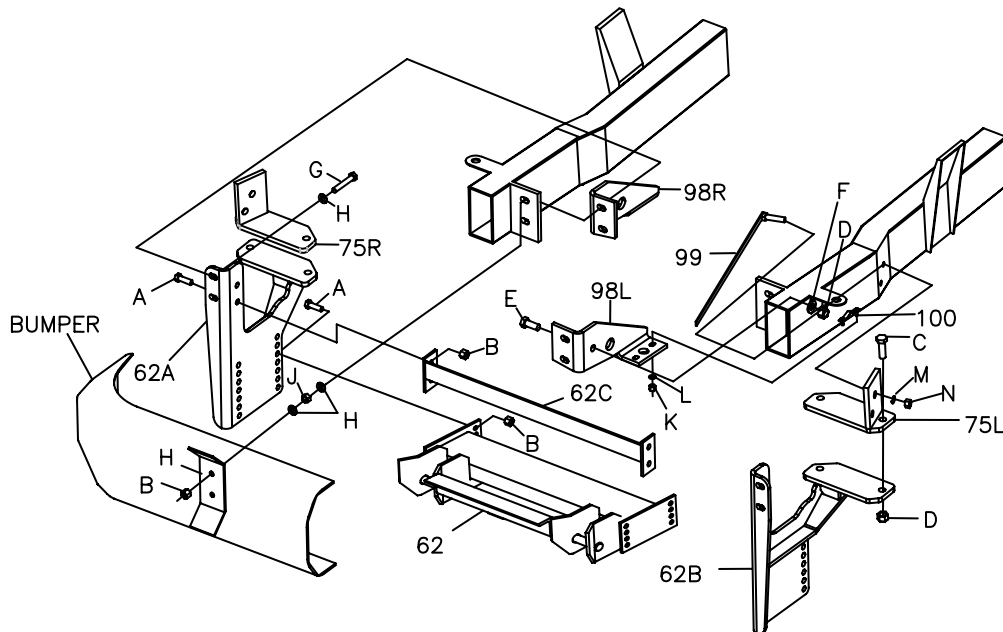

Figure 1

G10435

RECOMMENDED PUSHBEAM HEIGHT

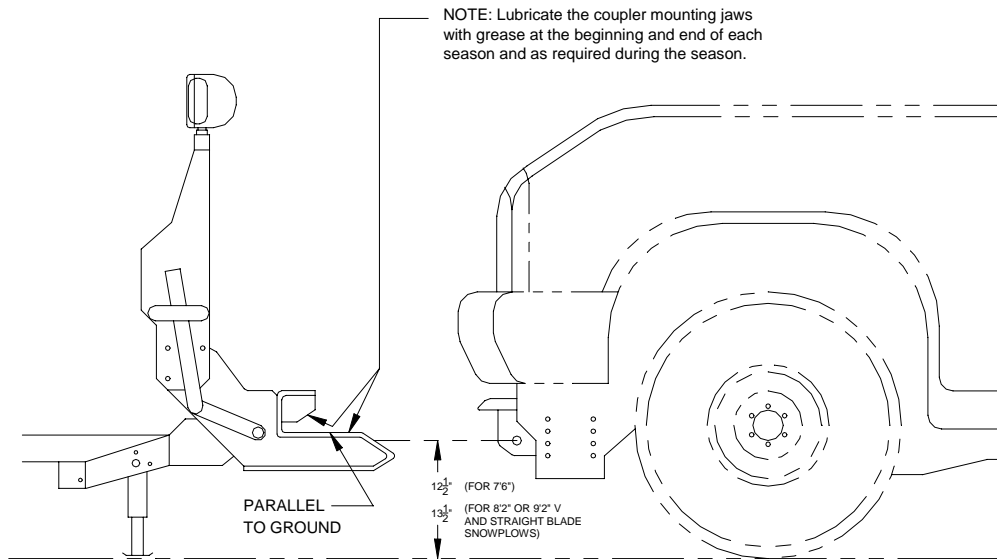

Figure 2

GUIDE TO RECOMMENDED ASSEMBLY TORQUE

All Torque Values Are In Foot-Pounds (Ft.-Lb.)



DIA./PITCH	GRADE 5	GRADE 8
1/4 - 20	6	9
5/16 - 18	14	19
3/8 - 16	23	33
7/16 - 14	38	53
1/2 - 13	56	80
M14 x 2.00	80	112
9/16 - 12	82	116
5/8 - 11	113	159
3/4 - 10	201	283

* The torque values listed above are based on dry, coated bolts, variables such as oil, or other lubrications may appreciably alter these values and must be taken into consideration.

NOTE: IT IS IMPORTANT THAT ALL FASTENERS BE PROPERLY TORQUED TO ASSURE A SAFE OPERATING PLOW.

Figure 3