



## Back Drag Edge Kit

### V-Blade Plows

Part No. MSC06584

Part No. MSC06585

Part No. MSC06586

Part No. MSC23701

Part No. MSC23702

Part No. MSC29080

Form No. MSC06590 Rev C

## Installation Instructions

---

BOSS Products limited consumer warranty and BOSS Products commercial warranty policies are located at [www.BOSSPlow.com](http://www.BOSSPlow.com).

Patent [www.ttcopats.com](http://www.ttcopats.com).

## Safety

Installing this kit changes the weight of your plow. Ensure that your vehicle does not exceed the gross-vehicle-weight rating (GVWR) at any time. You may need to weigh the vehicle and add ballast or limit the payload of the vehicle to compensate.



# Installation

1. Park the machine on a level surface and raise the plow a few inches off the ground.
2. Place a jack stand under the plow pushframe, shut off the vehicle engine, engage the parking brake, and remove the key.
3. Remove the bolts, washers, and nuts that secure the cutting edge to the plow and discard them. Retain the cutting edge.

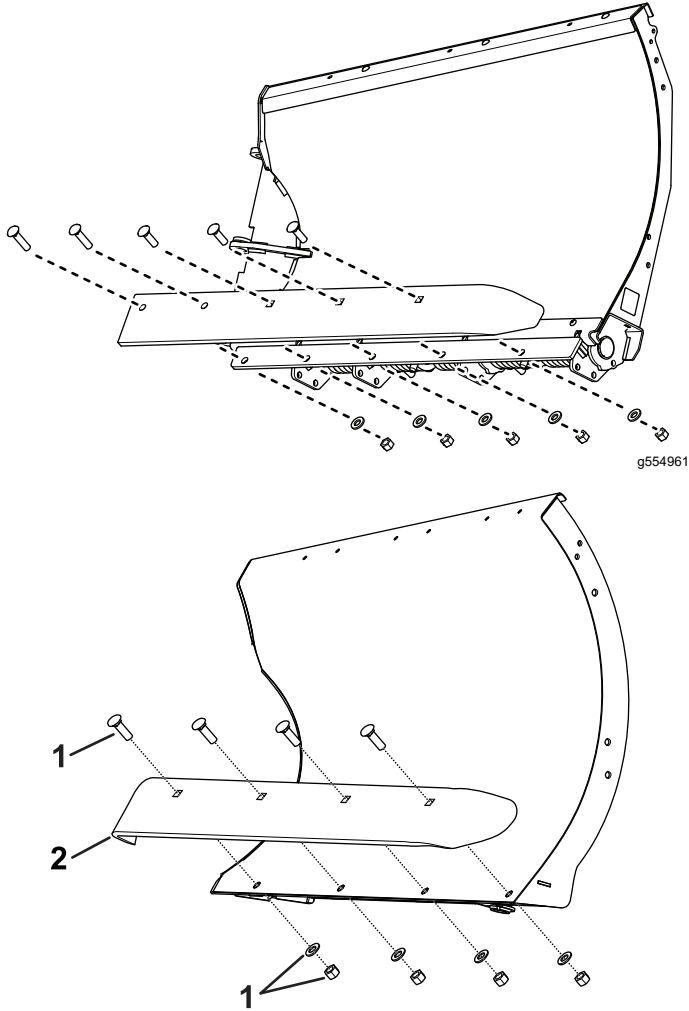

**Figure 1**

1. Hardware—discard
2. Cutting edge—retain

4. Install the back drag edge and previously removed cutting edge to the plow using new bolts, washers, and nuts.

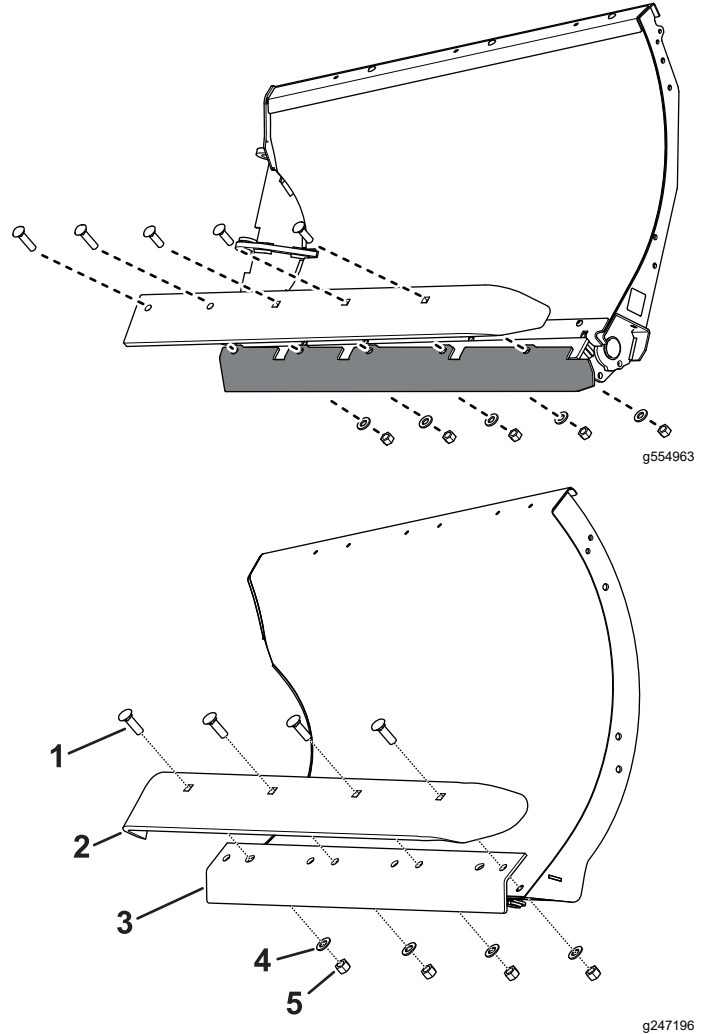

**Figure 2**

1. Bolt
2. Cutting edge
3. Back drag edge
4. Washer
5. Nut