

# 13-Pin Headlight Adapter Kit 9008 (H13) Bulb

MSC09993

Brown — BR  
 Red — R  
 Violet — V  
 Pink — P  
 Violet/Yellow — V/Y  
 Pink/Yellow — P/Y

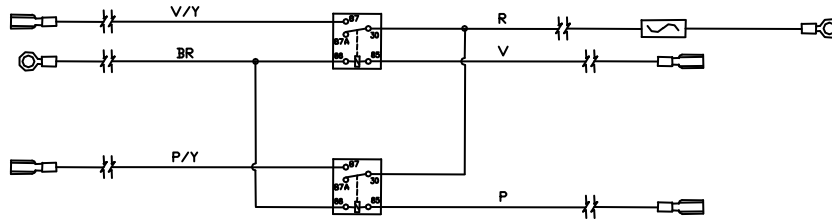

RELAY  
ASSEMBLY  
(1) REQUIRED

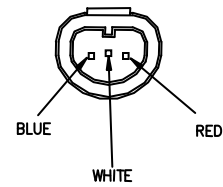
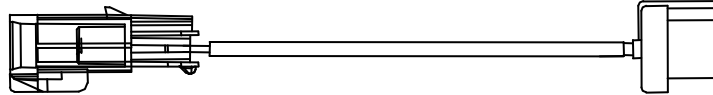
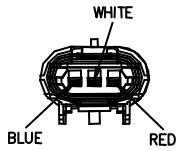

HEADLIGHT  
ADAPTOR 1  
(2) REQUIRED

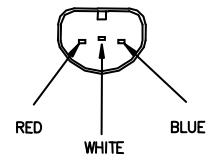
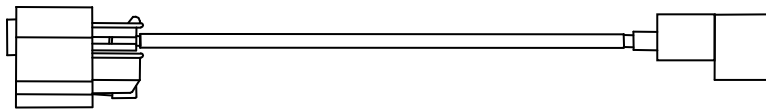
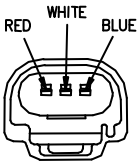

HEADLIGHT  
ADAPTOR 2  
(2) REQUIRED

Figure 1. Headlight Adapter Kit

## MSC08839 Headlight Adapter Installation Procedure

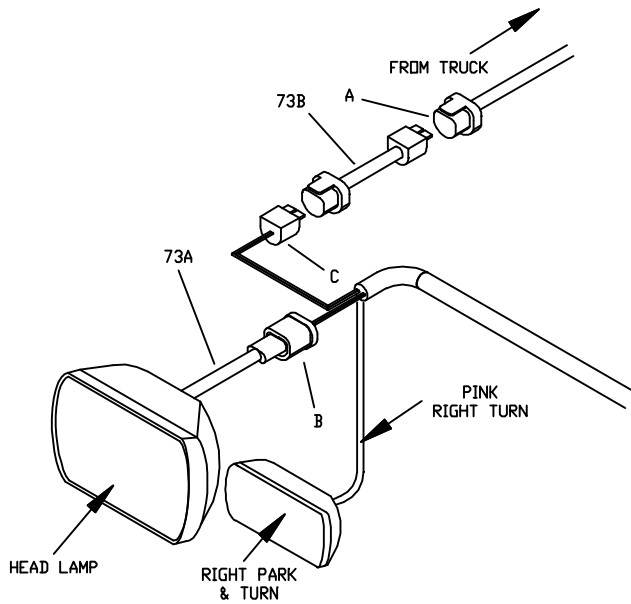

**Figure 1.** Ford F150 Headlight Adapter Connections G10274

This installation Procedure is for 2004 & Newer Ford F150, 2005 & Newer Ford Super Duty, and 2006 & Newer Dodge ½, ¾, and 1 ton trucks.

1. Disconnect OEM Headlight Connector Plug (A) from the back of the vehicle headlight.
2. Connect one end of Headlight Adapter (73A) into the back of the vehicle headlight.
3. Connect end (B) of Headlight Adapter (73A) into the plow wiring harness.
4. Connect the Black Rubber Female Socket (C) of the plow wiring harness into Headlight Adapter (73B).
5. Connect Headlight Adapter (73B) into OEM Headlight Connector Plug (A).
6. Repeat Steps 1 through 5 for the opposite side headlight.

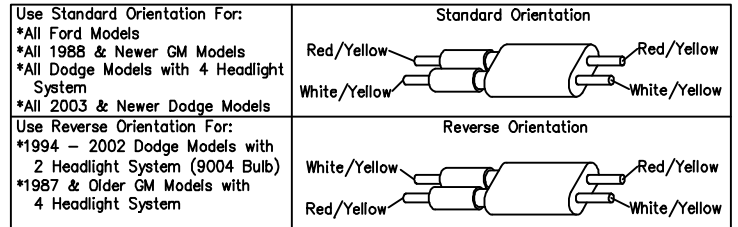

**Figure 2.** Vehicle Option Connector

G10202

7. Locate vehicle option connector. Align the connector so that the wire colors are positioned to match the vehicle it is installed on. This is illustrated in Figure 2.



---

A DIV. OF NORTHERN STAR INDUSTRIES, INC.  
P.O. BOX 788 IRON MOUNTAIN, MICHIGAN 49801

**Turn Signal Relay Kit  
Installation Instructions  
MSC09991**

***DRIVEN TO BE THE BEST***

MSC09992-0

## Turn Signal Relay Kit Installation Procedure

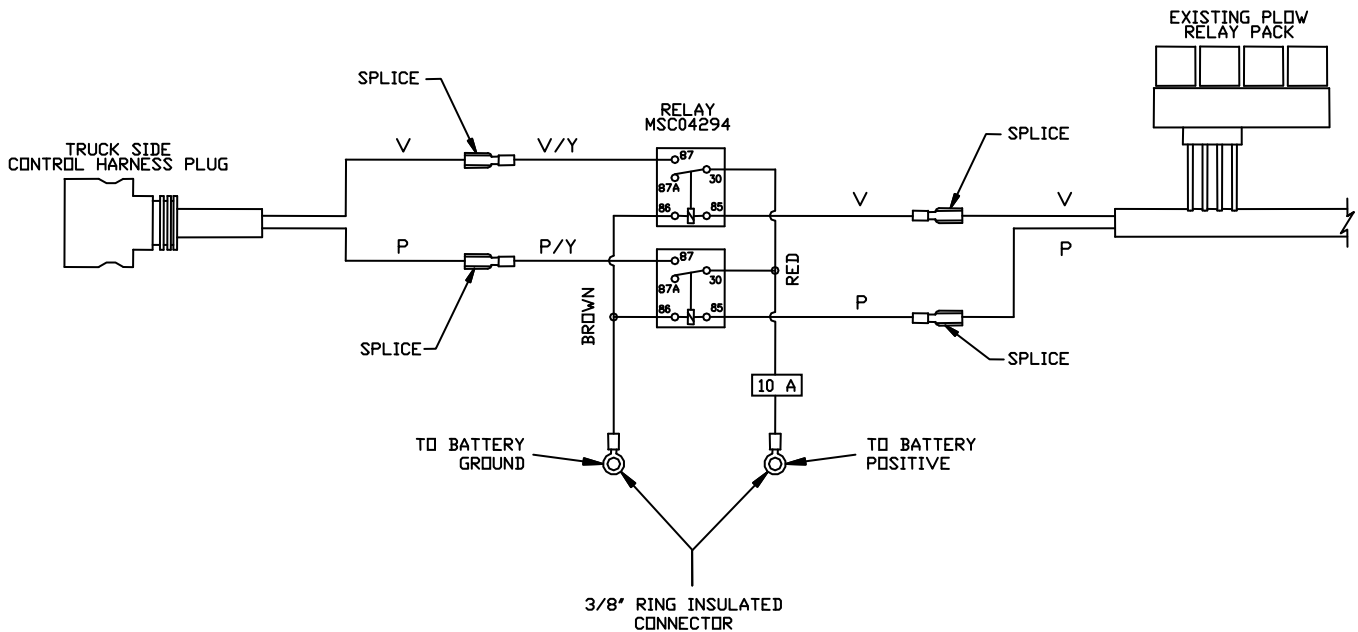

**Figure 1.** Turn Signal Relay Kit Installation

G10396

1. Start by locating the existing plow control harness relay pack mounted inside the truck engine compartment.
  2. On the control plug side of the relay pack, locate the PINK and VIOLET wires and pull them out of the black convoluted tubing of the wiring harness.
  3. Cut the PINK and VIOLET wires and strip all cut ends.
  4. Attach the PINK and VIOLET wires of the Relay Kit to the cut ends of the PINK and VIOLET wires leading to the existing plow control harness relay pack.
  5. Attach the PINK/YELLOW and VIOLET/YELLOW wires of the Relay Kit to the remaining cut end of the PINK and VIOLET wires leading to the control plug.
  6. Attach the BROWN ground wire of the Relay Kit to the negative ground side of the truck battery.
  7. Attach the RED wire of the Relay Kit to the positive side of the truck battery.
  8. Mount Relay Kit securely with the existing relay pack.
- Note:** If the Relay Kit cannot be mounted with the existing relay pack, the Relay Kit should be mounted securely inside the engine compartment in the upright position.
- 
- NOTICE
- All plow wiring should be secured within the engine compartment in a position that provides sufficient room so that hot or moving parts will not be contacted. Vehicle damage could occur if wires are not properly secured.
- 
9. After verifying that both truck and plow lights and turn signals work properly, heat the butt-end splice connectors to shrink and seal.