



P.O. Box 787 Iron Mountain, MI 49801-0787
ISO 9001:2008 REGISTERED
bossplow.com

**2010 & NEWER
POLARIS RANGER MIDSIZE –
400,500,570,800
UTV UNDERCARRIAGE
MOUNTING INSTRUCTIONS
(PART NO. LTA13185)**

WARNING

Always follow the vehicle manufacturers' recommendations relating to system installation.

Due to the variety of equipment that can be installed on this vehicle, it is necessary to verify that the Gross Vehicle Weight Rating (GVWR) is not exceeded at any time. This may require weighing the vehicle and adding ballast as necessary. It may also limit payload capacity of the vehicle. It is the operator's responsibility to verify that these ratings are not exceeded.

2010 & NEWER POLARIS RANGER MIDSIZE – 400,500,570,800 UTV UNDERCARRIAGE MOUNTING INSTRUCTIONS

The mounting procedure outlined below covers 2010 & Newer Polaris Ranger Midsize models. You will need to refer to the illustrations and familiarize yourself with each of the undercarriage components and their relative position to each other. Then proceed as follows:

1. Remove two existing screws from vehicle upper bumper screen and set aside.
2. Remove three existing screws from vehicle bumper guard on backside of bumper and set aside.
3. Using one 3/8"-16 x 1-1/4" Hex Head Bolt (A), one 3/8"-16 Nylon Lock Nuts (B) and one 3/8" Flat Washer (C) position and attach Skid Plate Assembly (1) to vehicle frame. Bolt should be snug.
4. Mark the three hole locations on the front of the vehicles' front bumper and two on the metal skid plate underneath.
5. Remove Skid Plate Assembly (1).
6. Using a 7/16" drill bit, drill through the five marked hole locations on the front of the vehicles' front bumper and through the metal skid plate underneath.
7. Using three 3/8"-16 x 1-1/4" Hex Head Bolts (A), three 3/8"-16 Nylon Lock Nuts (B), and Backer Plate (2) position and loosely attach Skid Plate Assembly (1). Backer Plate (2) should be located on the opposite side of bumper as Skid Plate Assembly (1).
8. Place Nut Plate Assembly (3) on top side of metal skid plate and align with mount holes in metal skid plate.
9. Using two 3/8"-16 x 1-1/4" Hex Head Bolts (A) and two 3/8" Split Lock Washers (D) attach rear of Skid Plate Assembly (1) to vehicle frame.
10. Tighten all fasteners to recommended torque found in Figure 2.

**2010 & NEWER POLARIS RANGER MIDSIZE –
400,500,570,800
UTV UNDERCARRIAGE
INSTALLATION PROCEDURE**

REF. NO.	DESCRIPTION	PART NO.	QTY.
1	Skid Plate Assembly	LTA13186	1
2	Backer Plate	LTA13192	1
3	Nut Plate	LTA13193	1
	Fastener Kit	HDW13372	1
Includes:			
A	3/8"-16 x 1-1/4" GR5 Hex Head Bolt	HDW01771	6
B	3/8"-16 Nylon Lock Nut	HDW01720	4
C	3/8" Flat Washer	HDW01733	2
D	3/8" Split Lock Washer	HDW01718	2

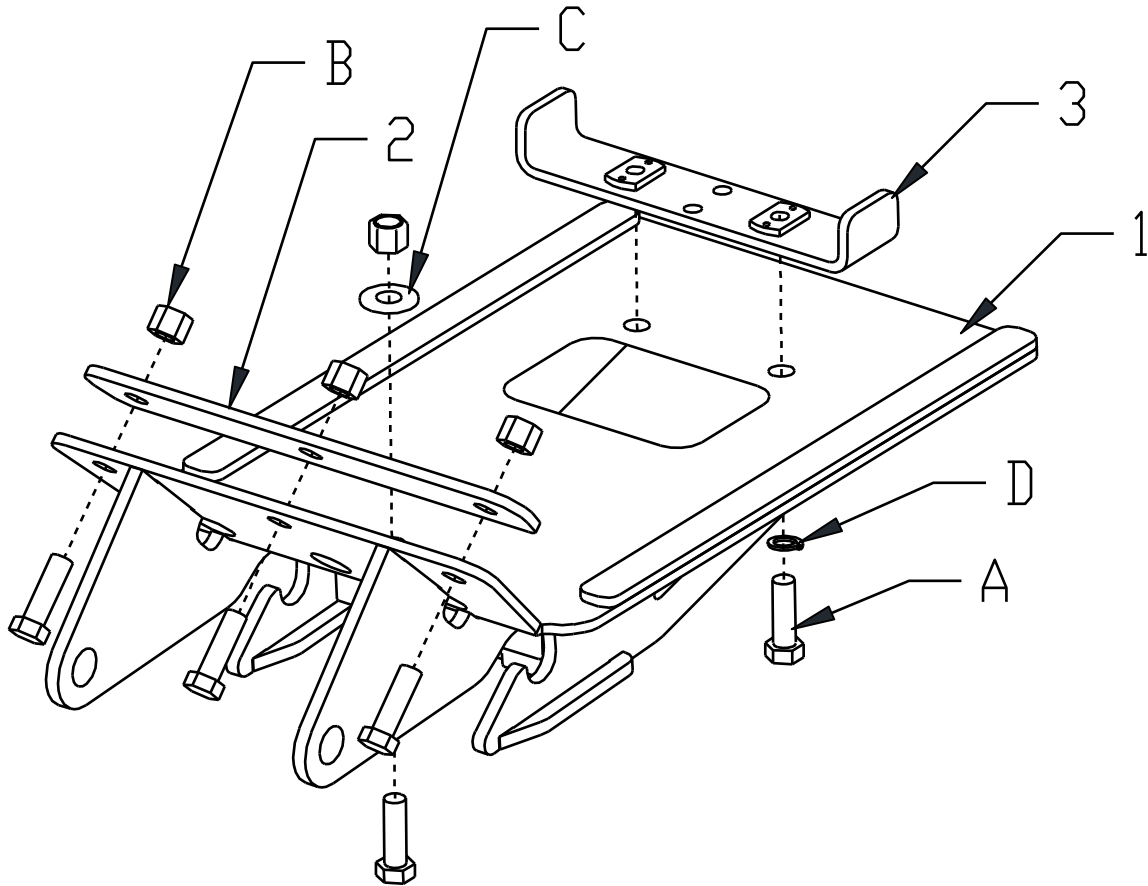

Figure 1

G10935

RECOMMENDED SUSPENSION SETTINGS

- A heavy-duty front spring kit is required for plow installation on this vehicle. See manufacturers' specifications. Contact BOSS Service Department for specific part numbers.

GUIDE TO RECOMMENDED ASSEMBLY TORQUE



DIAMETER / PITCH	GRADE 5	GRADE 8	GRADE 8.8	GRADE 10.9
1/4-20	6	9		
5/16-18	14	19		
3/8-16	23	33		
7/16-14	38	53		
1/2-13	56	80		
9/16-12	82	116		
5/8-11	113	159		
3/4-10	201	283		
M10 X 1.25			36	
M10 X 1.5				49
M12 X 1.75				71
M14 X 2.0				80

ALL TORQUE VALUES ARE IN FOOT-POUNDS (FT.-LB.)

Figure 2

G10410

* The torque values listed above are based on dry, coated bolts. Variables such as oil or other lubrications may appreciably alter these values and must be taken into consideration.

NOTE: IT IS IMPORTANT THAT ALL FASTENERS BE PROPERLY TORQUED TO ASSURE A SAFE OPERATING PLOW. RE-TIGHTEN ALL FASTENERS AFTER 2 HOURS OF PLOWING.