

BOSS Products limited consumer warranty and BOSS Products commercial warranty policies are located at [www.BOSSPlow.com](http://www.BOSSPlow.com).

Patent [www.ttcopats.com](http://www.ttcopats.com).

## Safety

- Always follow the vehicle manufacturer's recommendations relating to system installation.
- Due to the variety of equipment that you can install using the undercarriage, ensure that the gross-vehicle-weight rating (GVWR) is not exceeded at any time. You may need to weigh the vehicle and add ballast or limit the payload of the vehicle to compensate.

## Installation

Determine the left and right sides of the machine from the normal operating position.

1. Park the machine on a level surface, shut off the engine, wait for all moving parts to stop, engage the parking brake, and remove the key.
2. Align the skid plate holes with the lower front bumper holes.
3. Temporarily install the skid plate to the existing lower holes in the vehicle bumper using the 2 bolts (3/8 x 1-3/4 inches) and 2 locknuts (3/8 inches).

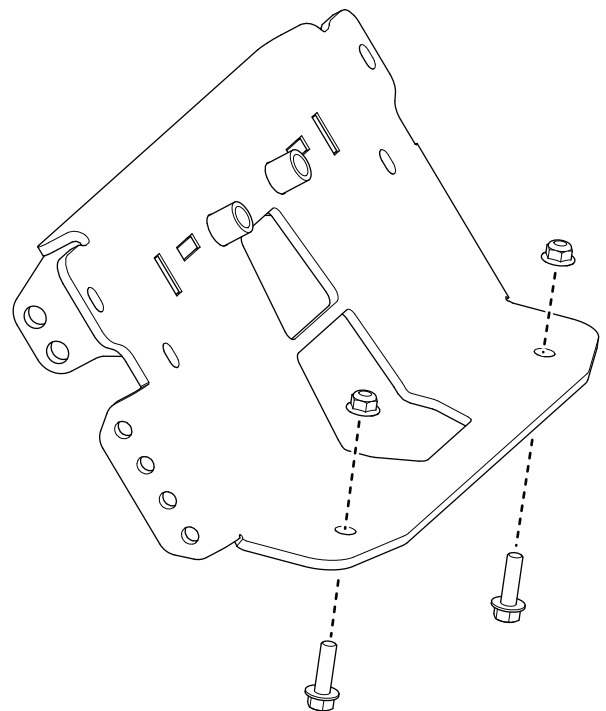

g510598

**Figure 1**  
Vehicle not shown



- Use the skid-plate assembly as a template and mark the 6 hole locations on the vehicle's front bumper.

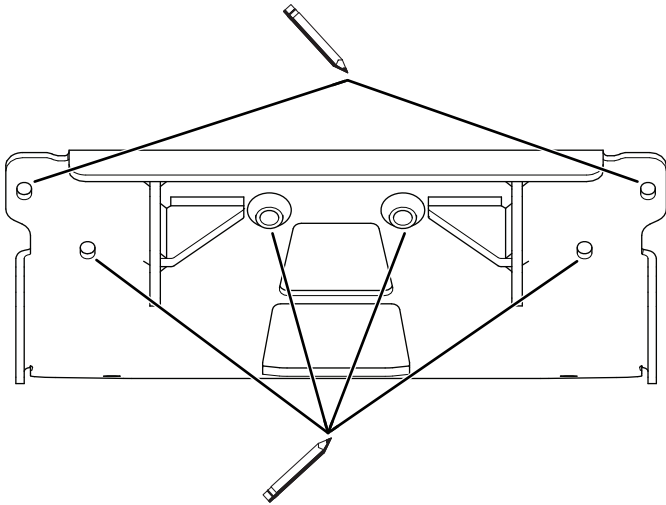

**Figure 2**  
Vehicle not shown

g510587

- Using a drill bit (9/16 inch), drill the 2 inner holes on the metal skid plate on the vehicle (**Figure 3**).

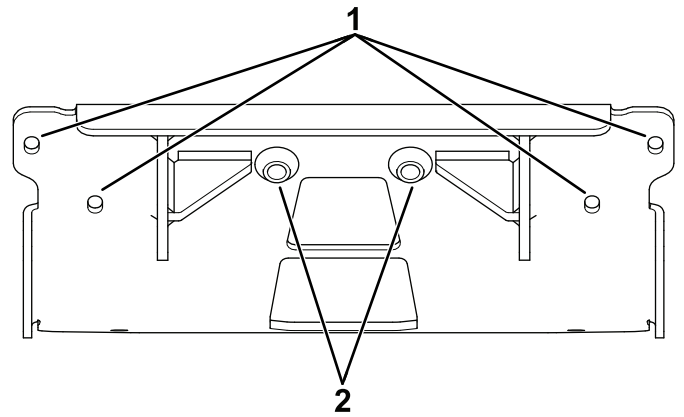

**Figure 3**  
Vehicle not shown

g510599

- Outer hole locations (for reference only)
- Inner hole locations (for reference only)

- Remove the skid-plate assembly from the machine.

**⚠ WARNING**

Using a drill without proper eye protection may allow debris to enter the eye, causing injury.

When drilling, always wear eye protection.

- Using a drill bit (7/16 inch), drill the 4 outer marked holes on the metal skid plate on the vehicle (**Figure 3**).

- Behind the front bumper on the frame of the vehicle, install the rear support brackets using 2 bolts (M10 x 20 mm).

**Note:** The bolts will go through the rear support brackets and into the nuts that are welded on the front of the vehicle frame.

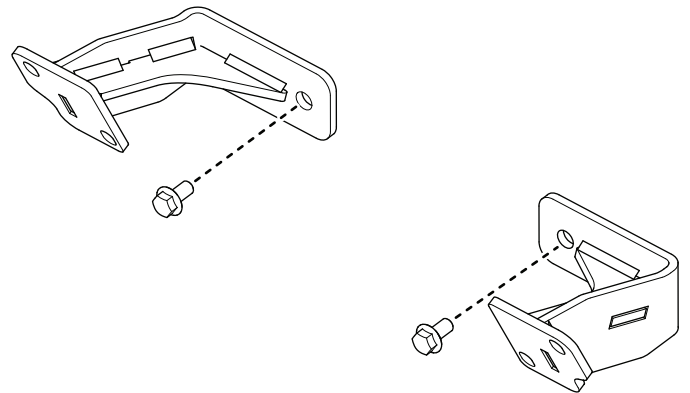

**Figure 4**  
Vehicle not shown

g510610

9. Install the skid plate to the existing lower holes in the vehicle bumper using the 2 bolts (3/8 x 1-3/4 inches) and 2 locknuts (3/8 inches).

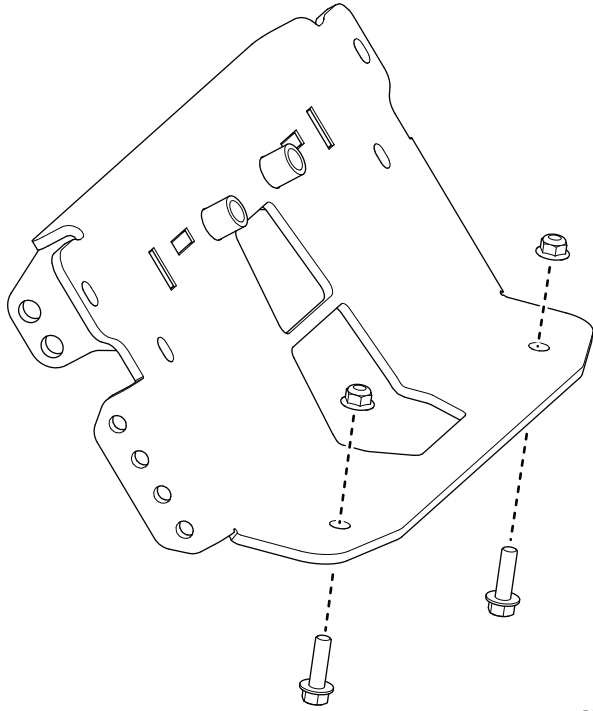

**Figure 5**  
Vehicle not shown

g510598

10. Install the front of the skid-plate assembly and rear support brackets to the vehicle front bumper using the 4 bolts (3/8 x 1-1/4 inches) and 4 locknuts (3/8 inch).

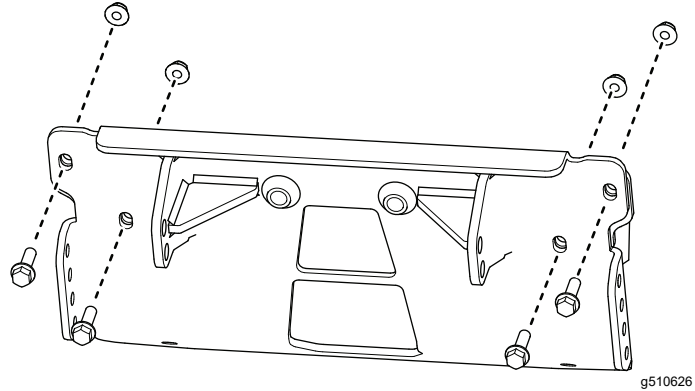

g510626

**Figure 6**  
Front view (vehicle not shown)

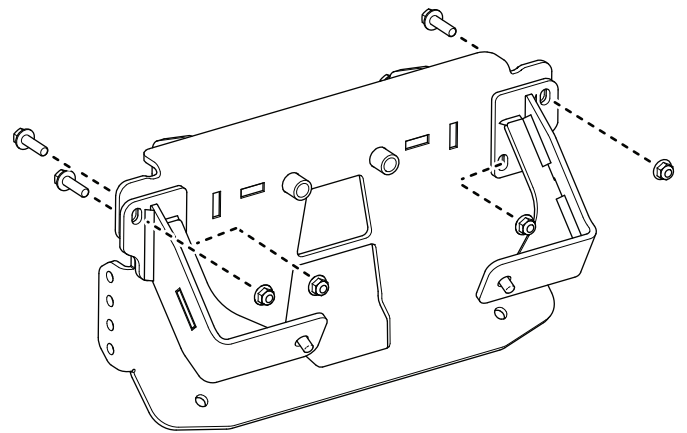

g510639

**Figure 7**  
Back view (vehicle not shown)

11. Install the skid-plate assembly to the vehicle front bumper using the 2 bolts (1/2 x 2-1/2 inches) and 2 locknuts (1/2 inch).

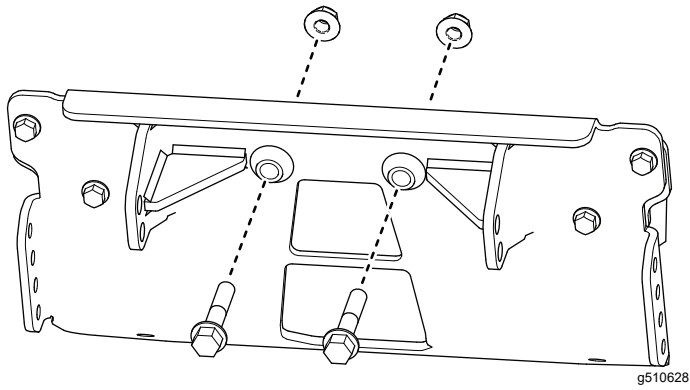

**Figure 8**  
Vehicle not shown

12. Install the pushbeam assembly to the skid-plate assembly using the 4 bolts (1/2 x 1-1/2 inches) and 4 locknuts (1/2 inch).

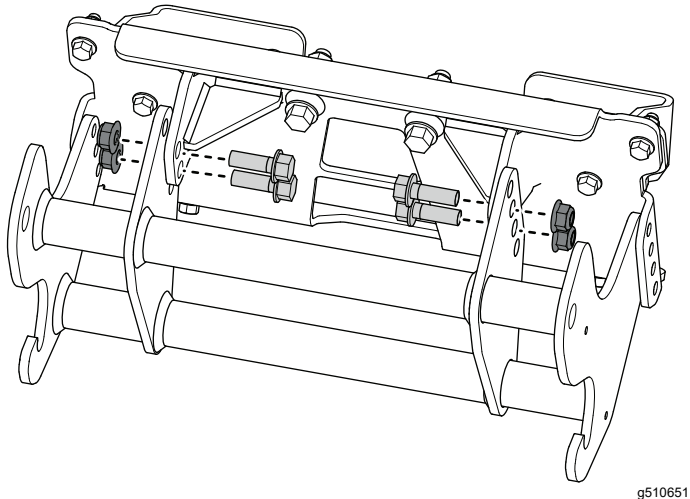

**Figure 9**

13. Install the remaining 6 bolts (3/8 x 1-1/4 inches) and 6 locknuts (3/8 inch) to secure the pushbeam assembly to the skid-plate assembly.

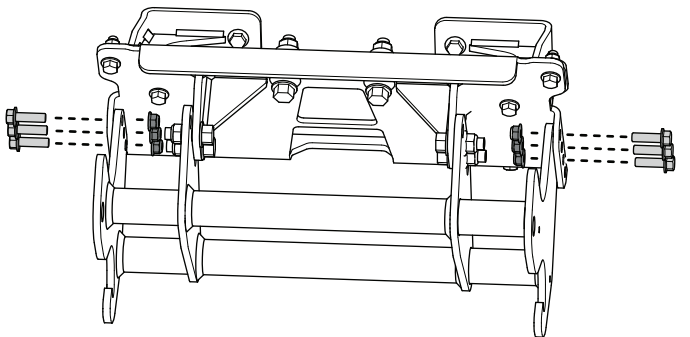

**Figure 10**

14. Torque all the fasteners to the following specifications:

- 3/8-inch bolts: 35 N·m (26 ft-lb)
- 1/2-inch bolts: 80 N·m (59 ft-lb)
- M10 bolts: 66 N·m (49 ft-lb)

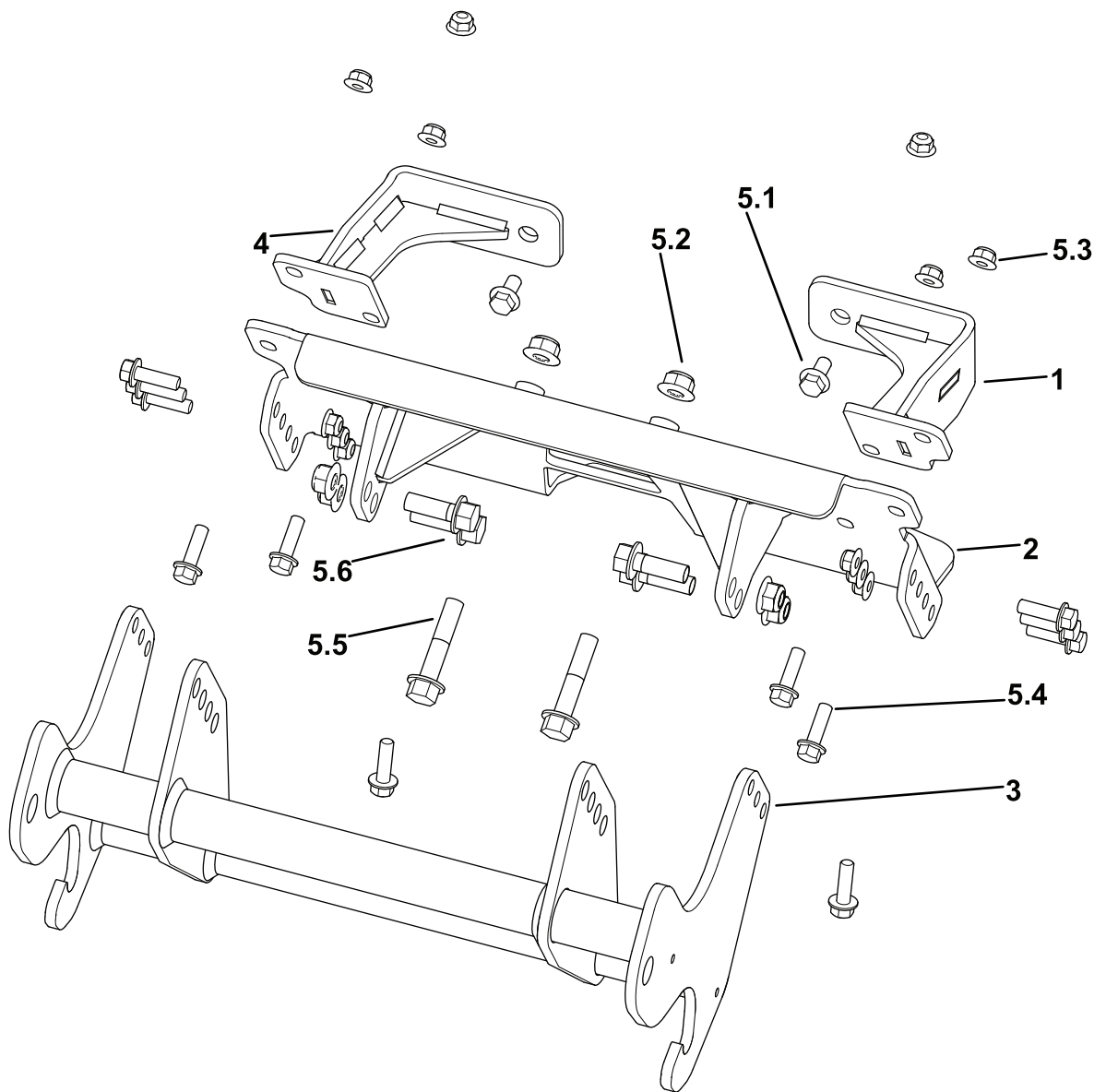

g510681

**Figure 11**  
Parts

Ref.	Part Number	Qty.	Description	Ref.	Part Number	Qty.	Description
1	ITA27975	1	PBSP ASSY,DR,POLARIS RNGR XD,24+	5.1	93-2569	2	SCREW-HHF[M10-1.5 X 20, CL8.8 CZ, PATCH]
2	ITA27971	1	SKID PLT WLMT,POLARIS RNGR XD,24+	5.2	HDW27963	6	NUT-HF [1/2-13, NYLOCK, GR N5, BZ]
3	PBA27999	1	PUSHBEAM ASM RT3,UTV,DROP	5.3	HDW27962	12	NUT-HF [3/8-16, NYLOCK, GR N5, BZ]
4	ITA27980	1	PBSP ASSY,PS,POLARIS RNGR XD,24+	5.4	HDW27943	12	SCREW-HHF [3/8-16 X 1.25, GR5, BZ]
5	HDW27990	1	KIT-FASTENER,UC,POLARIS RANGER XD,24+	5.5	HDW27964	2	SCREW-HHF [1/2-13 X 2.5, GR5, BZ]
				5.6	HDW27948	4	SREW-HHF [1/2-13 X 1.5, GR5, BZ]

**Notes:**

**Notes:**

**BOSS**

**S N O W P L O W**