

Installation Instructions

BOSS Products limited consumer warranty and BOSS Products commercial warranty policies are located at www.BOSSPlow.com.

Patent: www.ttcopats.com.

Safety

- Always follow the vehicle manufacturer's recommendations relating to system installation. For recommended vehicle models, refer to the *BOSS Snowplow Application Chart and Selection Guide*.
- Never disable, remove, or relocate any sensors or other components related to the operation of the air bags.
- To comply with federal regulations and to assure a safe vehicle, do not exceed the front gross-axle-weight rating (FGAWR), rear gross-axle-weight rating (RGAWR), and the gross-vehicle-weight rating (GVWR) at any time.
- Due to the variety of equipment that you can install on the vehicle and undercarriage, do not exceed the front gross-axle-weight rating (FGAWR), rear gross-axle-weight rating (RGAWR), and the gross-vehicle-weight rating (GVWR) at any time. This may require weighing the vehicle and adding ballast as necessary. It may also limit the payload capacity of the vehicle.

Installation

Determine the left and right sides of the machine from the normal operating position.

1. Park the machine on a level surface, shut off the engine, wait for all moving parts to stop, engage the parking brake, and remove the key.
2. Rotate the cab forward.
3. Remove the 4 bolts securing the rear AC bracket to the vehicle frame.

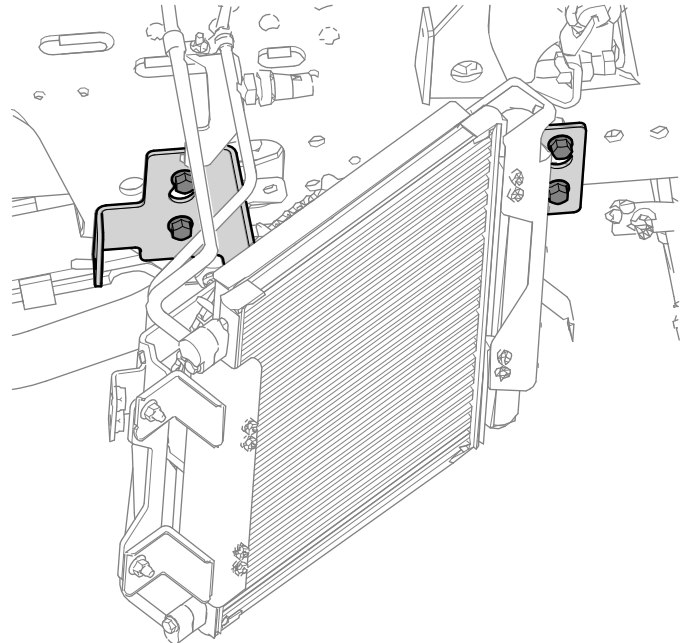

Figure 1

g560451

⚠ WARNING

Using a drill without wearing eye protection may allow debris to enter the eye, causing personal injury.

When drilling, always wear eye protection.

4. Drill out the 4 existing holes in the vehicle frame using a drill bit (9/16 inch) and remove the captive nuts.
5. Place the passenger side bracket between the AC bracket and the vehicle frame, and loosely secure the bracket to the frame with 4 bolts (1/2 x 2 inches) and 4 nuts (1/2 inch).

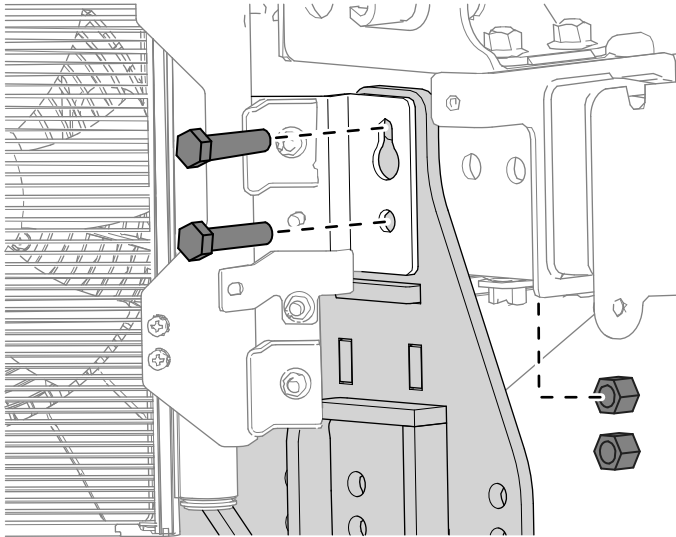

g560463

Figure 2

Passenger side bracket—front

6. Loosely secure the underside of the passenger side bracket to the vehicle frame using 1 bolt (1/2 x 2 inches), 1 flat washer, and 1 nut (1/2 inch). The washer should be placed between the underside of the truck frame and the top of the bracket.

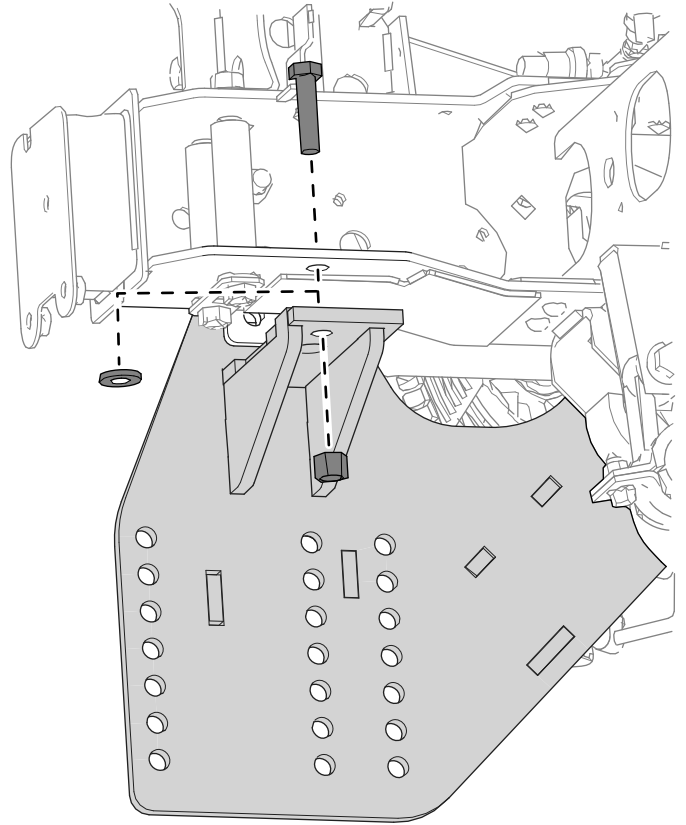

g560487

Figure 4

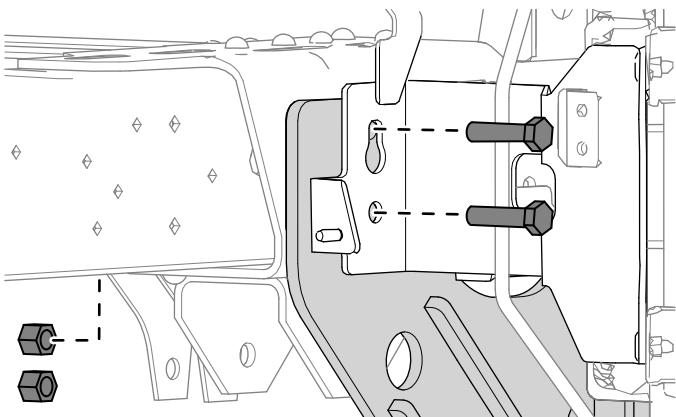

g560462

Figure 3

Passenger side bracket—rear

7. Line up the driver side bracket with the existing 3 holes on the vehicle frame. Mark and drill the left hole using a drill bit (9/16 inch).

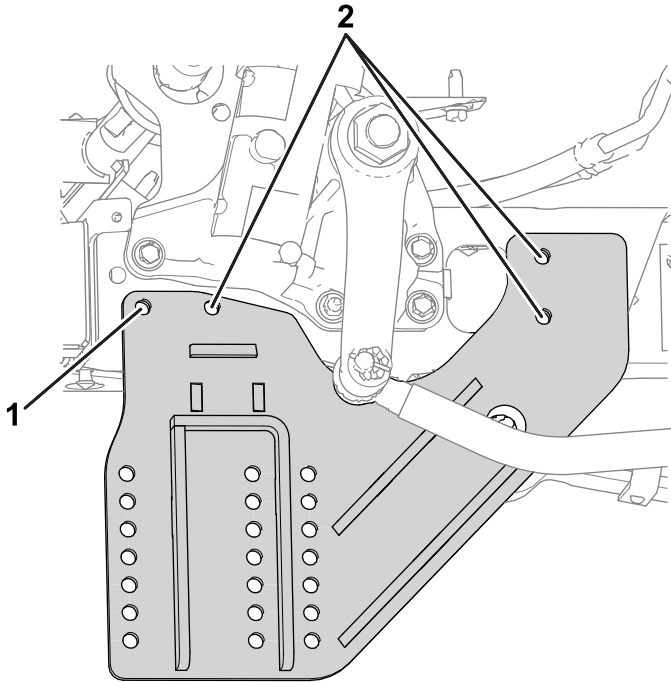

g560490

Figure 5

1. Mark and drill hole here 2. Existing holes

8. Loosely secure the driver side bracket with 4 bolts (1/2 x 2 inches) and 4 nuts (1/2 inch).

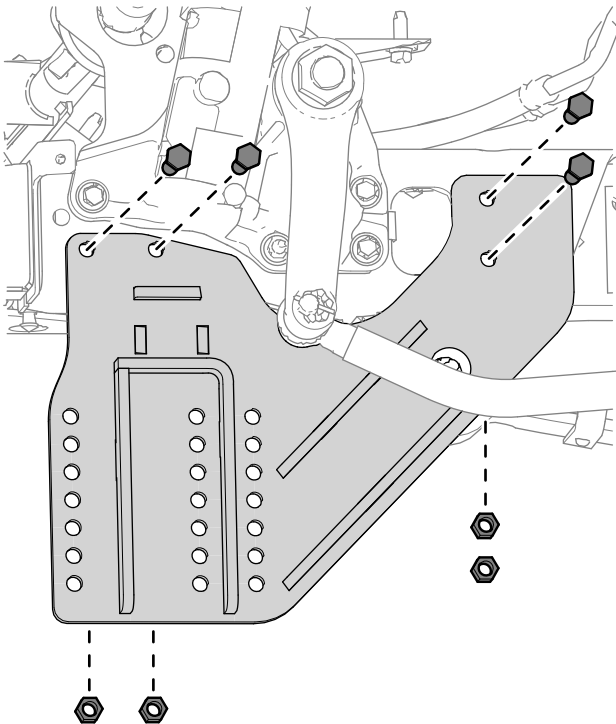

g560502

Figure 6

9. Loosely secure the underside of the driver side bracket to the vehicle frame using 1 bolt (1/2 x 2 inches), 1 flat washer, and 1 nut (1/2 inch). The washer should be placed between the underside of the truck frame and the top of the bracket.

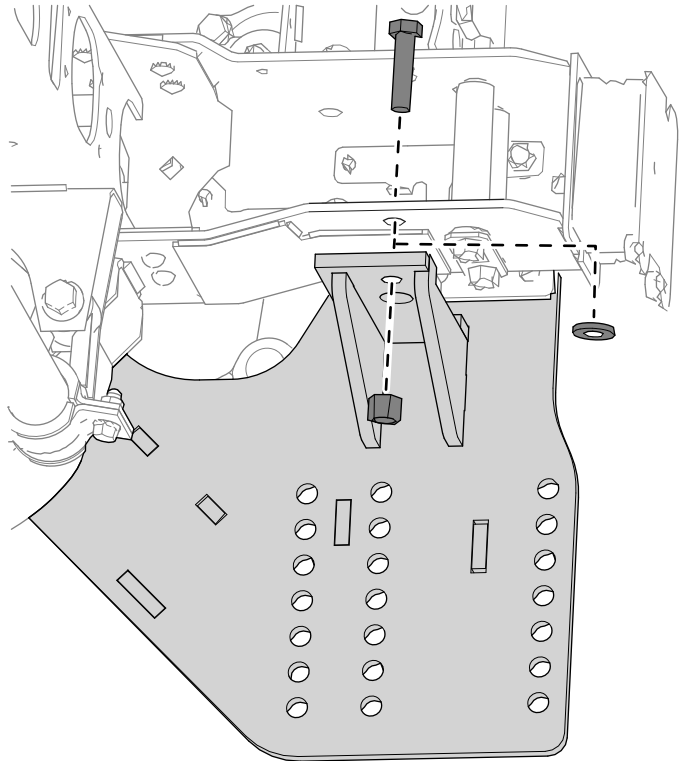

g560514

Figure 7

10. Remove the front piece of the vehicle bumper. Notch the bumper out around the pushbeam hooks.

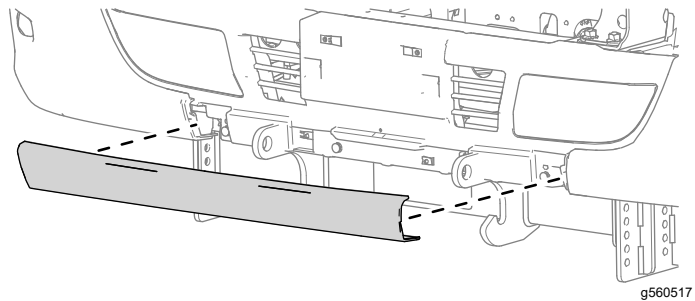

g560517

Figure 8

11. Loosely secure the pushbeam according to your model:

Note: Refer to your plow *Owner's Manual* and www.BOSS.com for the appropriate pushbeam.

Refer to the table below for the appropriate pushbeam height.

- Standard RT3 pushbeam—8 bolts (1/2 x 1-1/2 inches) and 8 nuts (1/2 inch)
- Heavy Duty pushbeam—8 bolts (1/2 x 2 inches) and 8 nuts (1/2 inch)

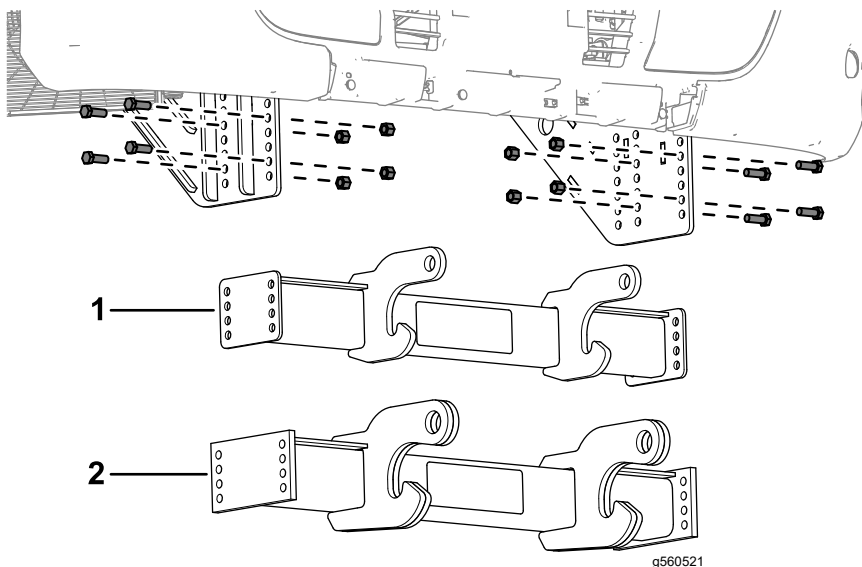

Figure 9

1. Standard pushbeam
2. Heavy Duty pushbeam

Recommended Pushbeam Height

Plow Type	Recommended Pushbeam Height
Rear Mounted Plow	48 cm (19 inches)
UTV	44-1/2 cm (17-1/2 inches)
Heavy Duty	15 cm (16-1/2 inches)
Standard Duty	39 cm (15-1/2 inches)
HTX/Sport Duty	37 cm (14-1/2 inches)

12. Torque all of the bolts (1/2 inch) to 76 N·m (56 ft-lb).

Important: Tighten all fasteners again after 2 hours of plowing.

13. Raise the cab.

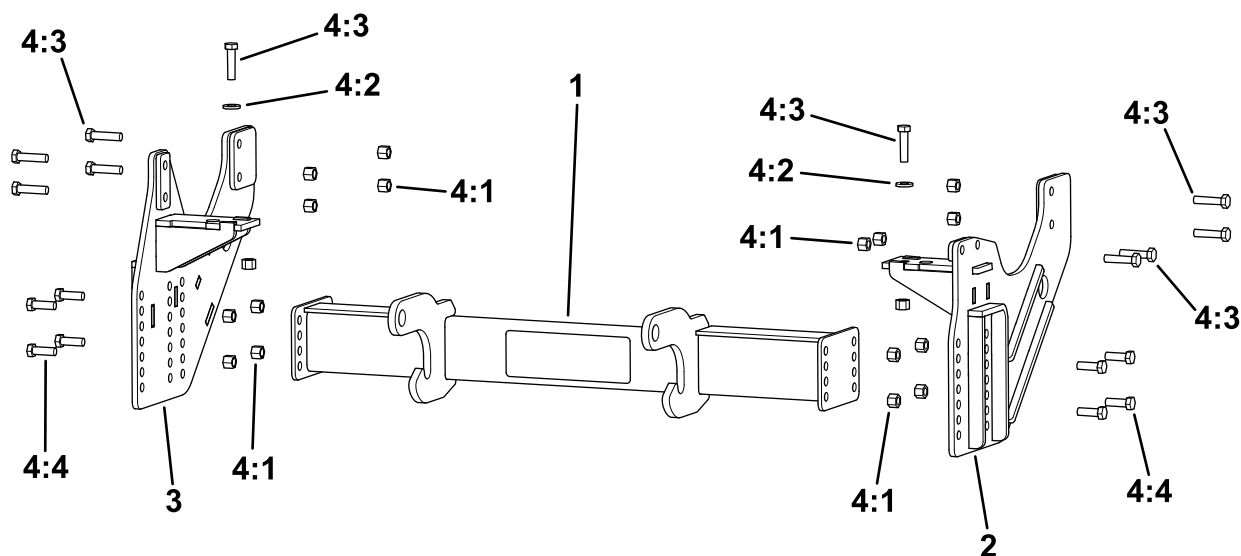

Parts

g560524

Ref.	Part Number	Qty.	Description	Ref.	Part Number	Qty.	Description
1	PBA25801-03 (for model LTA28320)	1	PUSHBEAM,GM LCF 35/45/5500	4:1	HDW01748	18	NUT,1/2-13,NYL INS,YZN
	PBA25825-03 (for model LTA28330)		PUSHBEAM,HD,GM LCF 35/45/5500,ISUZU,17	4:2	HDW01729	2	WASHER,1/2,F436 HARD,F/W,YZN
2	PBA28321-03	1	DS,PBSP,GM LCF 35/45/5500,ISUZ	4:3	HDW01755	10	HHCS,1/2-13X2,GR5,YZN
3	PBA28322-03	1	PS,PBSP,GM LCF 35/45/5500, ISU	4:4	HDW01728 (for model LTA28320)	8	HHCS,1/2-13X1-1/2,NC,GR5,YZN
4	HDW28325	1	Fastener Kit,GM LCF 35/45/5500		HDW01755 (for model LTA28330)		HHCS,1/2-13X2,GR5,YZN

Notes:

Notes:

BOSS
S N O W P L O W