

BOSS Products limited consumer warranty and BOSS Products commercial warranty policies are located at www.BOSSPlow.com.

Patent www.ttcopats.com.

Safety

- Always follow the vehicle manufacturer's recommendations relating to system installation.
- Due to the variety of equipment that you can install using the undercarriage, ensure that the gross-vehicle-weight rating (GVWR) is not exceeded at any time. You may need to weigh the vehicle and add ballast or limit the payload of the vehicle to compensate.

Installation

Determine the left and right sides of the machine from the normal operating position.

1. Park the machine on a level surface, shut off the engine, wait for all moving parts to stop, engage the parking brake, and remove the key.
2. Align the skid-plate holes with the lower front bumper holes.
3. Temporarily install the skid plate to the existing lower holes in the vehicle bumper using the 2 bolts (3/8 x 1-3/4 inches) and 2 locknuts (3/8 inch).

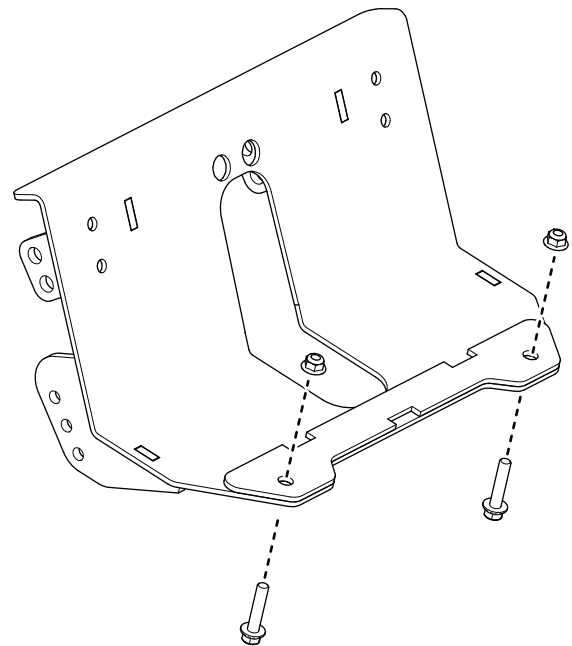
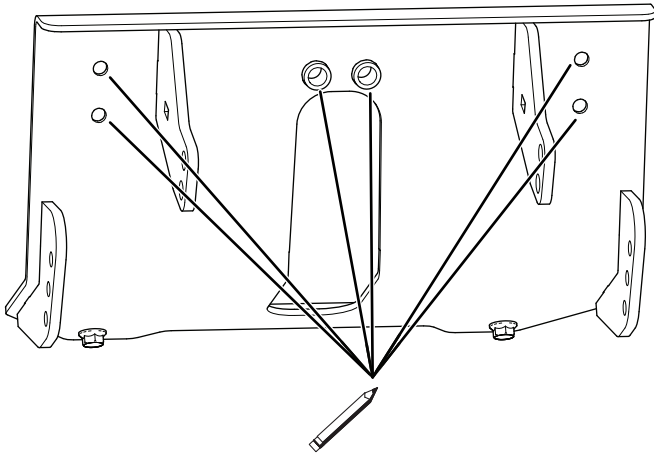

Figure 1

Vehicle not shown

g515305

- Use the skid-plate assembly as a template and mark the 6 hole locations on the front bumper.



g515306

Figure 2
Vehicle not shown

- Remove the skid-plate assembly from the vehicle.

⚠ WARNING

Using a drill without proper eye protection may allow debris to enter the eye, causing injury.

When drilling, always wear eye protection.

- Using a drill bit (7/16 inch), drill the 6 holes on the metal skid plate on the vehicle.
- Remove the front bumper from the vehicle; refer to the vehicle manufacturer's instructions.

- Vehicles equipped with winches only:** Remove the 2 lower bolts attaching the winch to the vehicles frame.

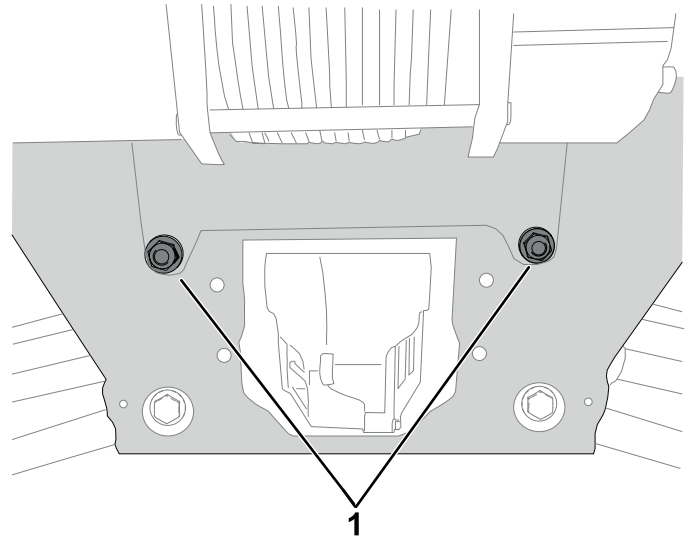

g515301

Figure 3

- Bolts to be removed

- Vehicles equipped with winches only:** Using the existing holes where the winch was mounted to the frame, temporarily install the rear support brackets to the vehicle using 1 bolt (3/8 x 1-3/4 inches) and 1 nut (3/8 inch).

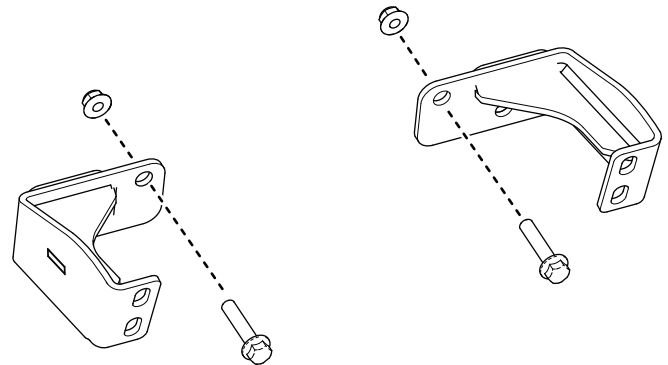

g515303

Figure 4
Vehicle not shown

10. **Vehicles without winches only:** Temporarily install each winch spacer plate and rear support bracket to the vehicle frame using 1 bolt (3/8 x 1-3/4 inches) and 1 nut (3/8 inch).

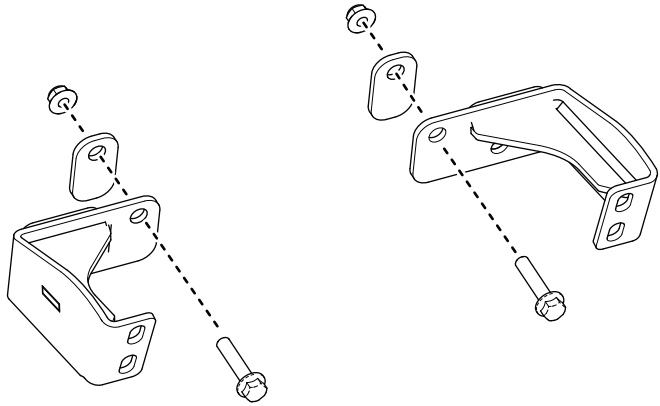

Figure 5
Vehicle not shown

g515302

14. Install the rear support brackets as shown below.

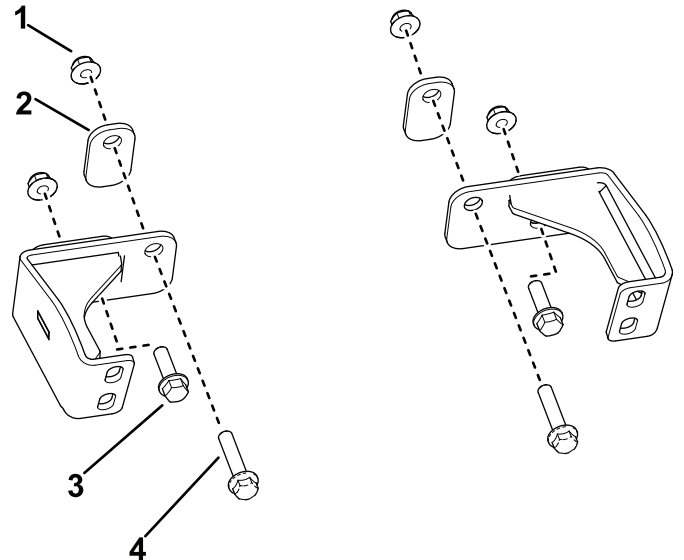

Figure 7
Vehicle not shown

g515321

11. Use the rear support bracket as a template and mark the 2 hole locations on the vehicle frame.

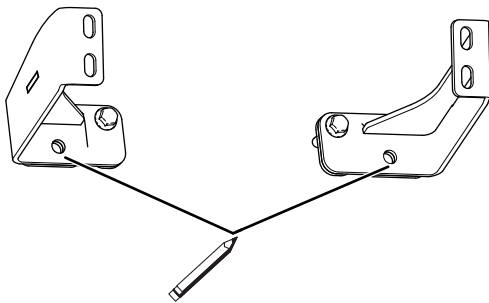

Figure 6
Vehicle not shown

g515309

- | | |
|---|------------------------------|
| 1. Nut (3/8 inch) | 3. Bolt (3/8 x 1-1/4 inches) |
| 2. Winch spacer plate (vehicles not equipped with a winch only) | 4. Bolt (3/8 x 1-3/4 inches) |

12. Remove the rear support bracket from the vehicle.

⚠ WARNING

Using a drill without proper eye protection may allow debris to enter the eye, causing injury.

When drilling, always wear eye protection.

13. Using a drill bit (7/16 inch), drill the 2 holes on the vehicle frame.

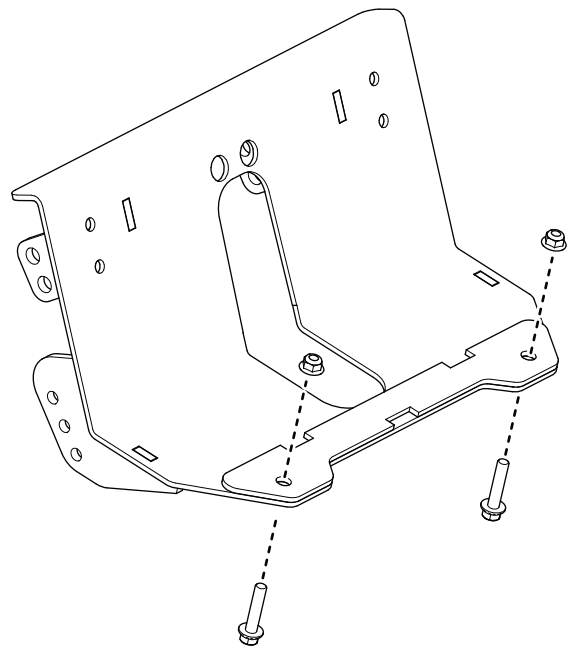

Figure 8
Vehicle not shown

g515305

17. Install the front of the skid-plate assembly and rear support brackets to the vehicle front bumper using 4 bolts (3/8 x 1-1/4 inches) and 4 nuts (3/8 inch).

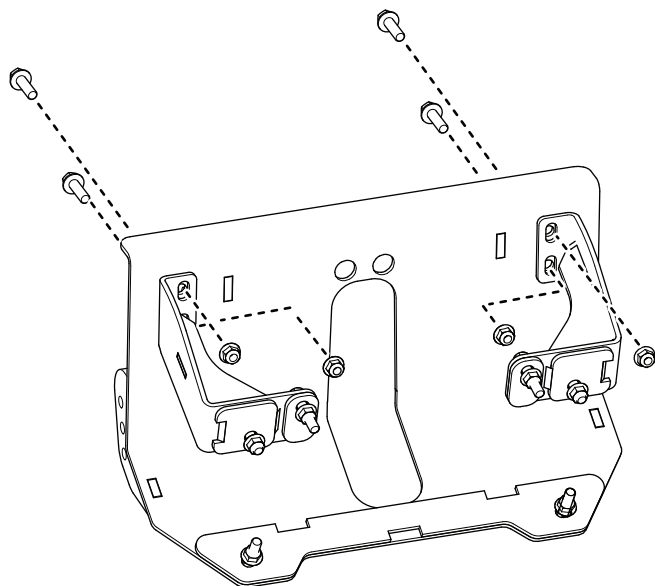

Figure 9

Vehicle not shown

g515322

18. Install the skid-plate assembly to the vehicle front bumper using 2 bolts (3/8 x 1-3/4 inches) and 2 nuts (3/8 inch).

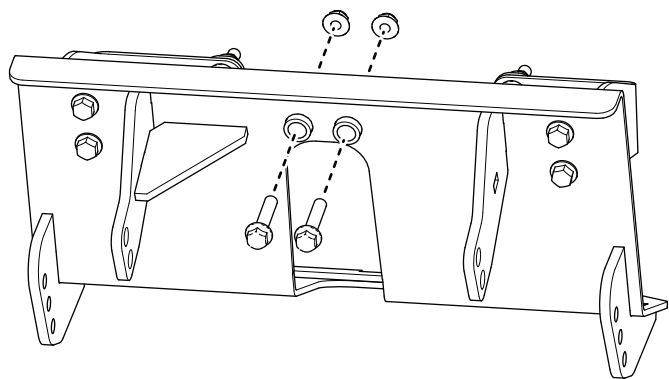

Figure 10

Vehicle not shown

g515323

19. Install the pushbeam assembly to the skid-plate assembly using the 4 bolts (1/2 x 1-1/2 inches) and 4 locknuts (1/2 inch).

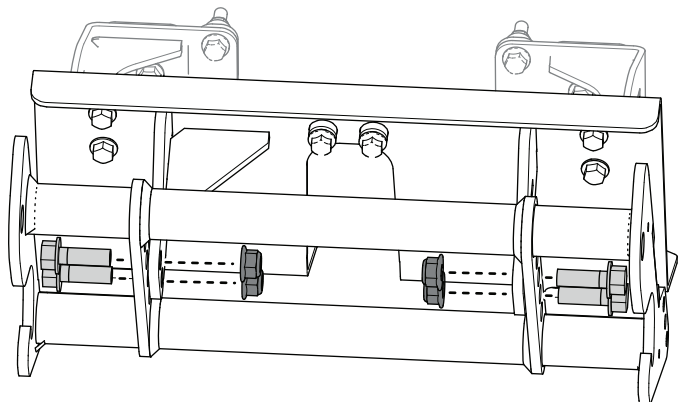

Figure 11

Vehicle not shown

g515334

20. Install the remaining 6 bolts (3/8 x 1-1/4 inches) and 6 locknuts (3/8 inch) to secure the pushbeam assembly to the skid-plate assembly.

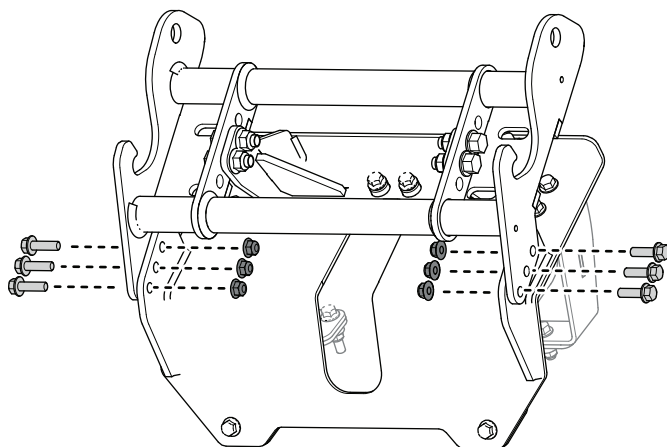

Figure 12

Vehicle not shown

g515335

21. Torque all the fasteners to the following specifications:

- 3/8-inch bolts: 35 N·m (26 ft-lb)
- 1/2-inch bolts: 80 N·m (59 ft-lb)

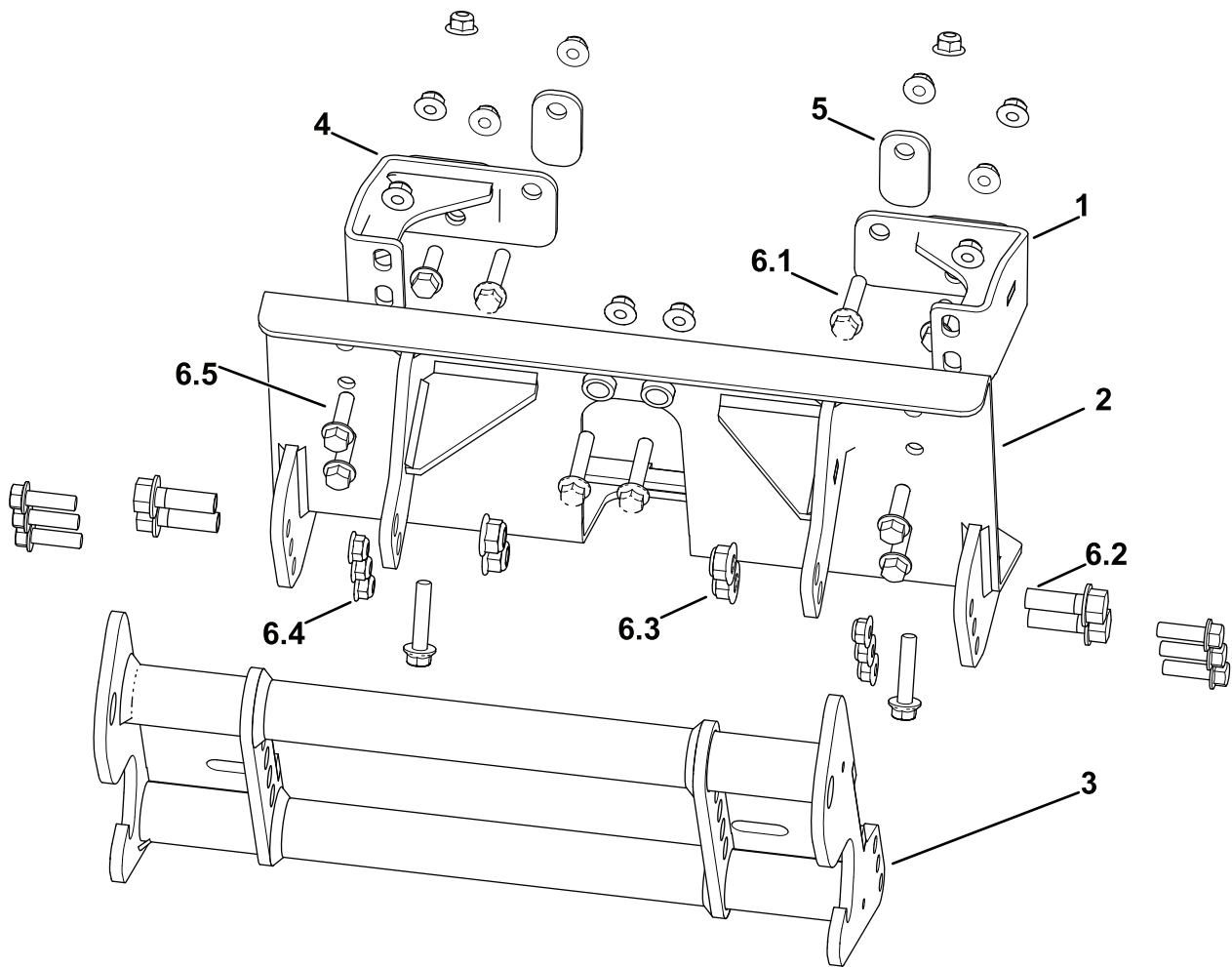

g515346

Figure 13
Parts

Ref.	Part Number	Qty.	Description	Ref.	Part Number	Qty.	Description
1	LTA28355-03	1	PBSP ASSY,DR,POLARIS RNGR XP,25+ [BLACK]	6.1	139-2594	6	SCREW-HHF [3/8-16 X 1.75, GR5, BZ]
2	LTA28351-03	1	SKID PLT WLMT,POLARIS RNGR XP,25+ [BLACK]	6.2	HDW27948	4	SCREW-HHF [1/2-13 X 1.5, GR5, BZ]
3	PBA12535-03	1	PUSHBEAM ASM RT3,UTV,COMMON [WELD] [BLACK]	6.3	HDW27963	4	NUT-HF [1/2-13, NYLOCK, GR N5, BZ]
4	LTA28357-03	1	PBSP ASSY,PS,POLARIS RNGR XP,25+ [BLACK]	6.4	HDW27962	16	NUT-HF [3/8-16, NYLOCK, GR N5, BZ]
5	LTA28364-03	2	SPCR,WINCH MNT,POLARIS RNGR XP,25+ [BLACK]	6.5	HDW27943	12	SCREW-HHF [3/8-16 X 1.25, GR5, BZ]
6	HDW28370	1	KIT-FASTENER,UC,POLARIS RNGR XP 1000,25+				

Notes:

Notes:

BOSS

S N O W P L O W