



A Division of The Toro Company

P.O.Box 787 Iron Mountain, MI 49801-0787

ISO 9001: 2008 REGISTERED

bossplow.com

TO: BOSS DEALERS

DATE: 5/7/2021

SUBJECT: MSC21680 Drag Pro Controller & Control Module Compatibility

The following is Service Bulletin SV158 from BOSS Snowplow Technical Support. Please make sure this bulletin is distributed to all employees who sell or service BOSS Products. We have distributed this service bulletin to all registered Distributors and Sub-distributors with dedicated e-mail addresses.

Thank you,

BOSS Snowplow Technical Support

REGARDING: MSC21680 Drag Pro Controller and Control Module Compatibility

With release of the new Drag Pro 180Z, BOSS has revised the MSC21680 Drag Pro controller to a REV B to function with both the original Drag Pro and Drag Pro 180Z models.

To minimize parts complexity, BOSS has also revised the MSC20099 control module to be common for both models. As a result, newer REV B hand controllers are only compatible with certain model Drag Pros. The following table outlines which combination of hand control, control module, and revision level are compatible on each product.

Drag Pro		
Hand Control MSC21680	Compatibility	Module MSC20099
REV A	Compatible with:	REV A
		REV B
		REV C
REV B	Compatible with:	REV B
		REV C

Drag Pro 180Z		
Hand Control MSC21680	Compatibility	Module MSC20099
REV B		REV C

NOTE: Previous Drag Pro models (manufactured in 2019 and before) may contain an older REV A control module and will NOT be compatible with newer REV B hand controllers. In this case, customers will require installation of a new REV C control module to function with a REV. B hand control.

Additionally, the REV C modules output wires must be installed differently than previous versions. Because of this, BOSS has released a control module service kit MSC21805 that includes the latest REV C MSC20099 control module, wiring schematic decal, and installation instructions for the revised wiring.

New controllers can be identified by a “REV B” decal printed on the connector housing (Fig. 2 below) and contain instructions on the back of the controller so that users can select the appropriate software mode for their rear plow (Fig 1).

Figure 1 – Software Mode Instructions

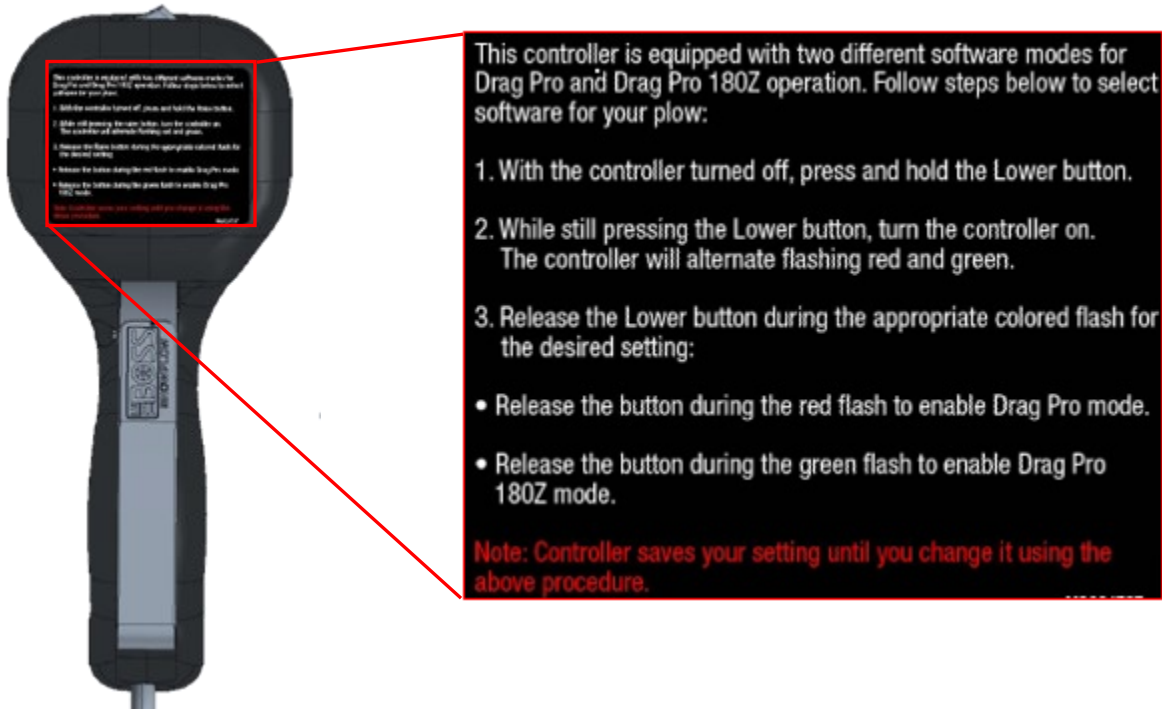

**Figure 2
Hand Control Connector Housing**



Please inspect any unsold Drag Pro plow boxes to verify which module is present. BOSS Technical Service will replace any new REV A MSC20099 modules with a REV C version at no charge to ensure your inventory is compatible with new and old hand controls. If your Drag Pro contains a REV B control module, the plow is compatible with newer REV B hand controllers, and no further actions are necessary. Modules can be identified by the revision marking on the part number decal (Fig. 3)

Figure 3
Module Part Number Decal



All Drag Pro plow boxes shipping from BOSS as of this bulletin will include either a REV B or C plow control module, both of which are compatible with the new REV B dual-programmable hand control.

All Drag Pro 180Z plow boxes shipping from BOSS as of this bulletin will include a REV C plow control module and is compatible with the new REV B dual programmable hand control.

If a control module service kit is needed, please work with your distributor to file a warranty claim in the PRW system. Claims can be ran as STOCK warranties for any field inventory. If you have any questions while filing a warranty claim, please call BOSS Technical Support at (800)286-4155 option 2 or email us at boss.techservice@bossplow.com and reference this Service Bulletin.