

Part No. VBS15125

Part No. VBS15130

Part No. VBS15135

Installation Instructions

⚠ WARNING

CALIFORNIA Proposition 65 Warning

This product contains a chemical or chemicals known to the State of California to cause cancer, birth defects, or reproductive harm.

Use this manual to install the kit on the VBX 6500, 8000, and 9000 spreaders. Illustrations may vary.

Determine the left and right sides of the machine from the normal operating position.

- For VBX 8000/9000 spreaders, secure 3 cover sections together using 8 bolts (1/4 x 2-3/4 inches), 16 washers, and 8 nuts (Figure 2).

Assembling the Cover

- Secure 1 set of spreader covers together according to your spreader:
 - For VBX 6500 spreaders, secure 2 cover sections together using 4 bolts (1/4 x 2-3/4 inches), 8 washers, and 4 nuts (Figure 1).

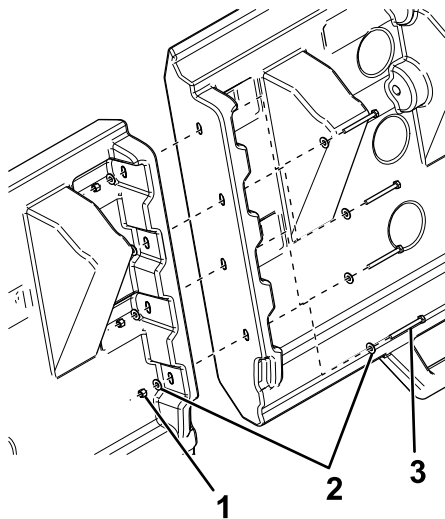

Figure 1

- Nut (1/4 inch)
- Washers (1/4 inch)
- Bolts (1/4 x 2-3/4 inches)

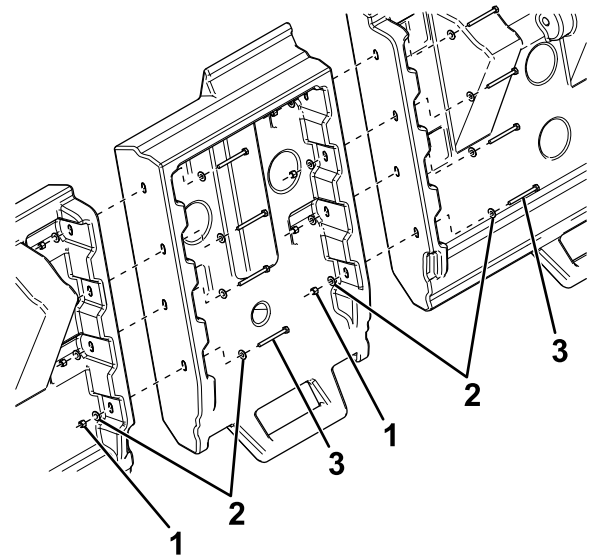

Figure 2

- Nuts (1/4 inch)
- Washers (1/4 inch)
- Bolts (1/4 x 2-3/4 inches)

- Torque the fasteners to 7 N·m (5 ft-lb).
- Secure a track to 1 end of the cover using a bolt (3/8 x 5 inches), 2 washers, and a nut as shown in Figure 3.

Note: The fasteners should be snug but not tight.



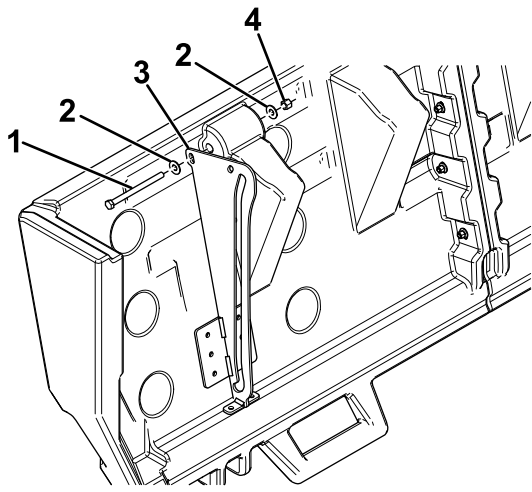

Figure 3

g225556

- | | |
|--------------------------|-------------------|
| 1. Bolt (3/8 x 5 inches) | 3. Track |
| 2. Washers (3/8 inch) | 4. Nut (3/8 inch) |

-
- Push the track flush against the lip of the cover and secure it in place with 2 lag screws as shown in [Figure 4](#).

Note: Use a square to ensure the track is perpendicular to the cover.

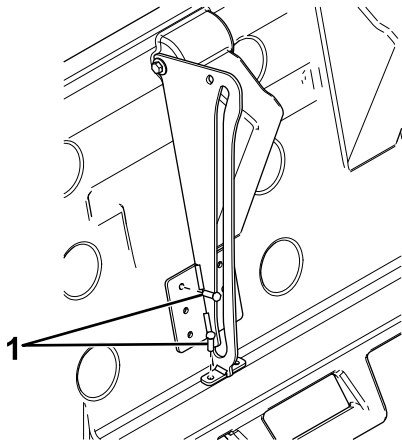

Figure 4

g225557

- Lag screws

-
- Attach a support bracket to the track using a bolt (3/8 x 1 inch), 2 washers, and a nut ([Figure 5](#)).

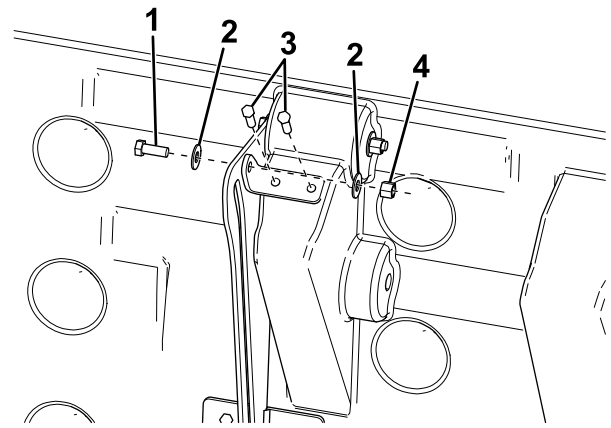

Figure 5

g225558

- | | |
|------------------------|-------------------|
| 1. Bolt (3/8 x 1 inch) | 3. Lag screws |
| 2. Washers (3/8 inch) | 4. Nut (3/8 inch) |

-
- Use a square to ensure the track is not tilted, then secure the support bracket to the cover using 2 lag screws ([Figure 5](#)).
 - Repeat steps [3](#) through [6](#) on the other end of the assembled cover sections.

Important: Ensure that the tracks are parallel to each other.

- Secure the tracks to the cover using 8 lag screws ([Figure 6](#)).

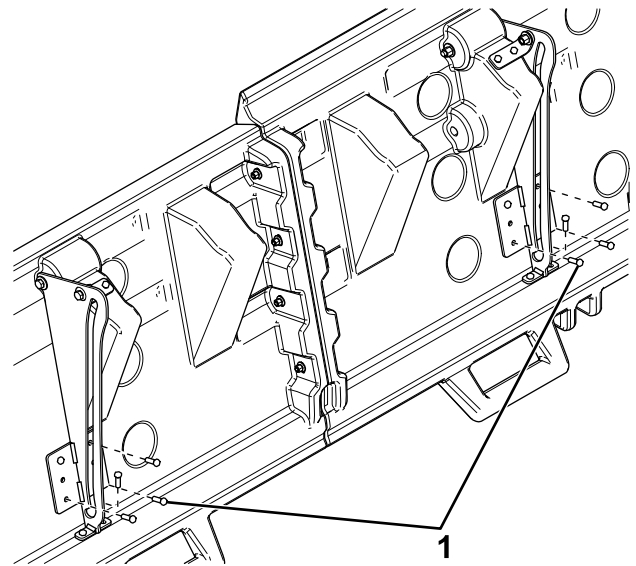

Figure 6

g225559

- Lag screws

-
- Torque the 3/8 x 5 inch bolts ([Figure 3](#)) to 7 N·m (5 ft·lb).

- Connect the material shields together using 4 bolts (3/8 x 1 inch), 4 washers, and 4 nuts as shown in [Figure 7](#) or [Figure 8](#).

Note: The fasteners should be snug but not tight.

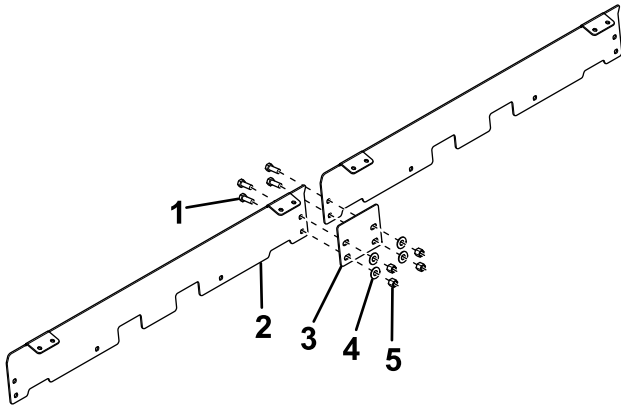

Figure 7
VBX 6500

g225560

- | | |
|---------------------------|----------------------|
| 1. Bolt (3/8 x 1 inch) | 4. Washer (3/8 inch) |
| 2. Outer material shield | 5. Nut (3/8 inch) |
| 3. Middle material shield | |

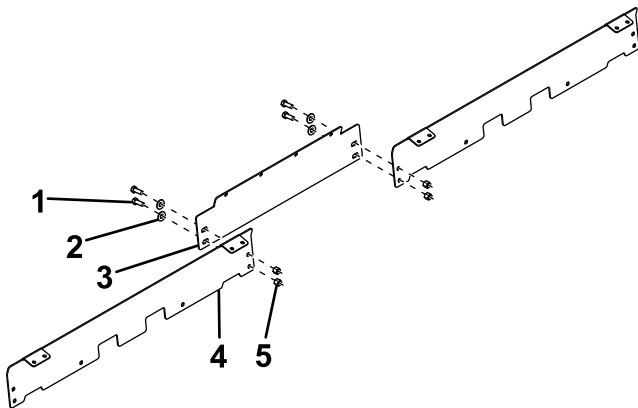

Figure 8
VBX 8000/9000

g225561

- | | |
|---------------------------|--------------------------|
| 1. Bolt (3/8 x 1 inch) | 4. Outer material shield |
| 2. Washer (3/8 inch) | 5. Nut (3/8 inch) |
| 3. Middle material shield | |

- With the cover upside-down, center the middle material shield with the center of the cover ([Figure 9](#)). For VBX 8000/9000 spreaders, secure the middle material shield to the cover using 4 lag screws ([Figure 10](#)).

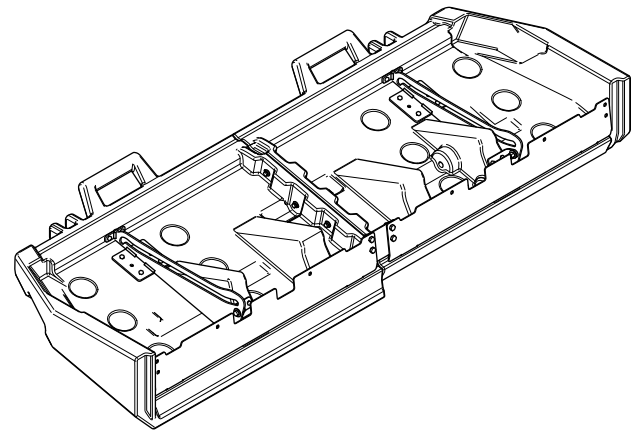

Figure 9
VBX 6500

g225562

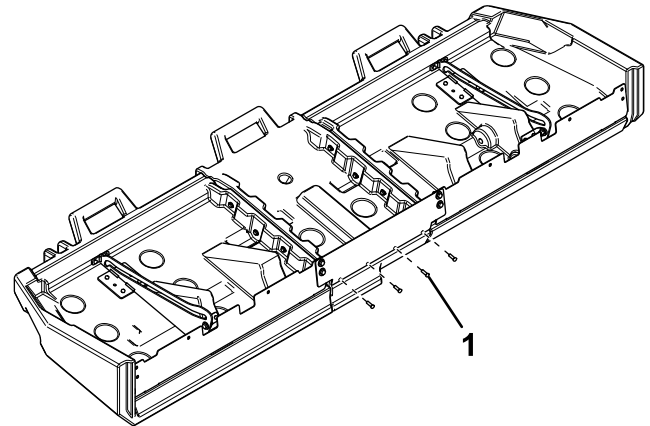

Figure 10
VBX 8000/9000

g225539

- Lag screw
- Adjust the outer material shields so the tracks are centered in the shield cutouts ([Figure 9](#) and [Figure 10](#)).
- Slide the outer material shields forward until they contact the protrusions on the underside of the cover, then secure them using 8 lag screws ([Figure 11](#)).

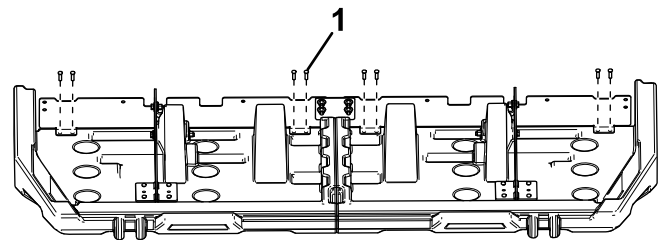

Figure 11

g225540

- Lag screw

- Attach the 4 support brackets to the material shield and cover using 4 bolts (3/8 x 1 inch), 4 washers, 4 nuts, and 4 lag screws as shown in [Figure 12](#).

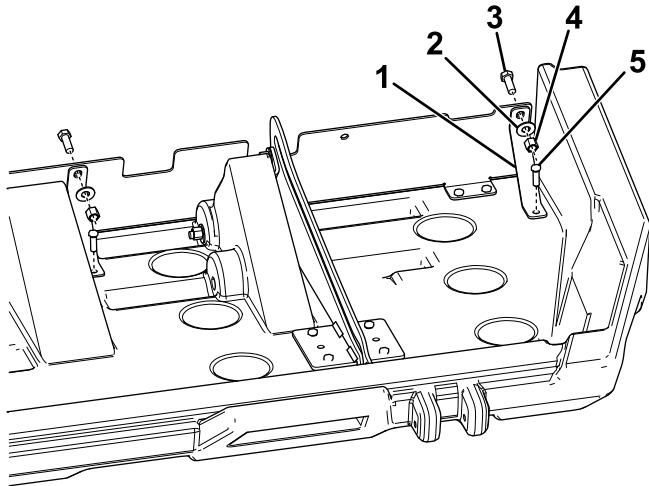

Figure 12

g225541

- | | |
|------------------------|-------------------|
| 1. Support bracket | 4. Nut (3/8 inch) |
| 2. Washer (3/8 inch) | 5. Lag screw |
| 3. Bolt (3/8 x 1 inch) | |

- Torque the middle material shield fasteners to 31 N·m (23 ft-lb).
- Repeat for the other side.

Installing the Topscreen Brackets

- Measure the distance from the track to the end of the cover ([Figure 13](#)).

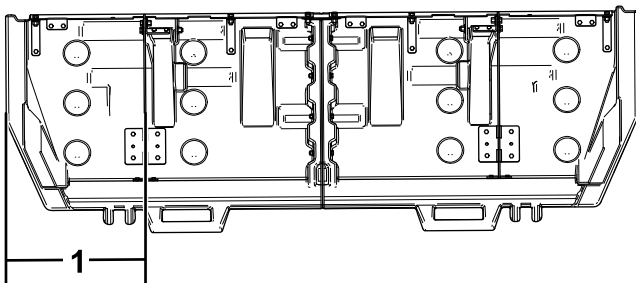

Figure 13

g225542

- Measure

- Starting at the outer edge of the spreader hopper, measure the distance found in step 1 and make a mark on the top screen ([Figure 14](#)).

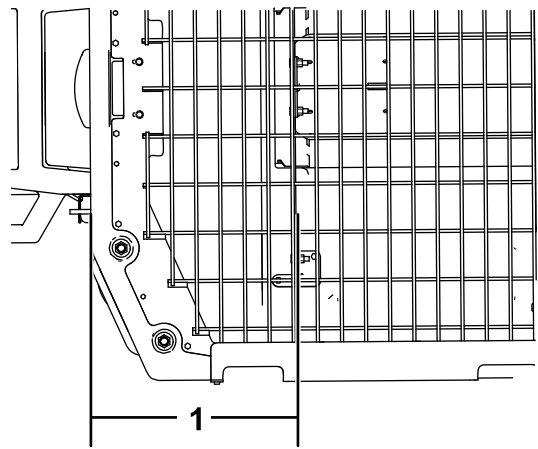

Figure 14

g225543

- Distance found in step 1.

- Center the mounting bracket with the mark on the topscreen from step 2 and secure it approximately 2.5 cm (1 inch) from the edge of the topscreen according to your spreader:

Note: The fasteners should be snug, but not tight.

- For VBX 6500 and 9000 spreaders, use 4 bolts (3/8 x 1-1/2 inches), 1 clamp plate, and 4 nuts ([Figure 15](#)).

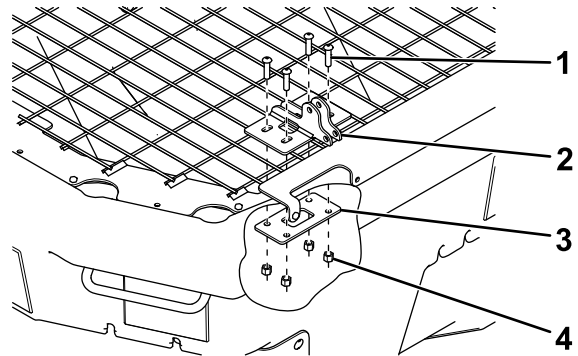

Figure 15

g225544

- | | |
|------------------------------|-------------------|
| 1. Bolt (3/8 x 1-1/2 inches) | 3. Clamp plate |
| 2. Mounting bracket | 4. Nut (3/8 inch) |

- For VBX 8000 spreaders, use 4 bolts (3/8 x 1-1/2 inches), 1 spacer plate, 1 clamp plate, and 4 nuts ([Figure 16](#)).

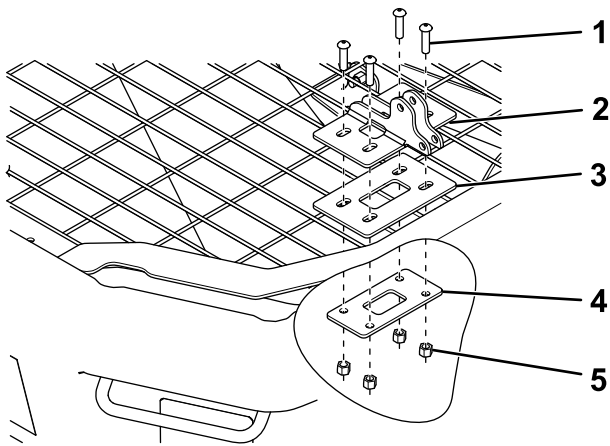

Figure 16

g225545

1. Bolt (3/8 x 1-1/2 inches)
2. Mounting bracket
3. Spacer plate
4. Clamp plate
5. Nut (3/8 inch)

4. On the cover, measure the distance between the tracks (Figure 17).

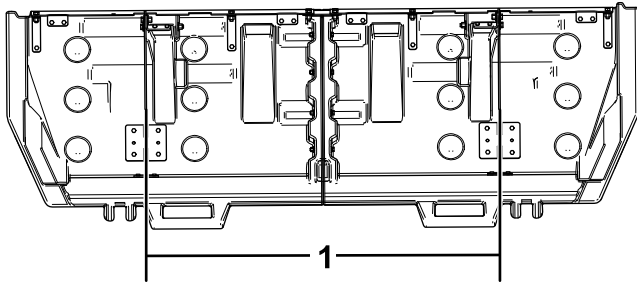

Figure 17

g225546

1. Measure

5. Starting at the center of the mounting bracket, measure the distance found in step 4 and make a mark on the top screen (Figure 18).

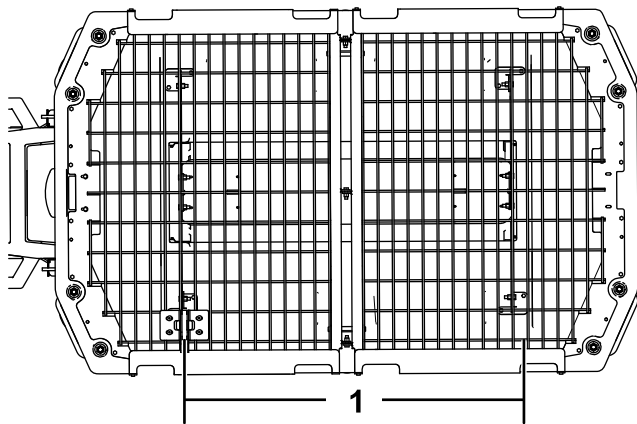

Figure 18

g225547

1. Distance found in step 4.

6. Center the mounting bracket with the mark on the topscreen from step 5 and secure it approximately 2.5 cm (1 inch) from the edge of the topscreen according to your spreader:

Note: The fasteners should be snug, but not tight.

- For VBX 6500 and 9000 spreaders, use 4 bolts (3/8 x 1-1/2 inches), 1 clamp plate, and 4 nuts (Figure 15).
- For VBX 8000 spreaders, use 4 bolts (3/8 x 1-1/2 inches), 1 spacer plate, 1 clamp plate, and 4 nuts (Figure 16).

7. Repeat for the other side.

Attaching the Cover to the Spreader

1. Snap a roller onto the slot in each of the tracks (Figure 19).

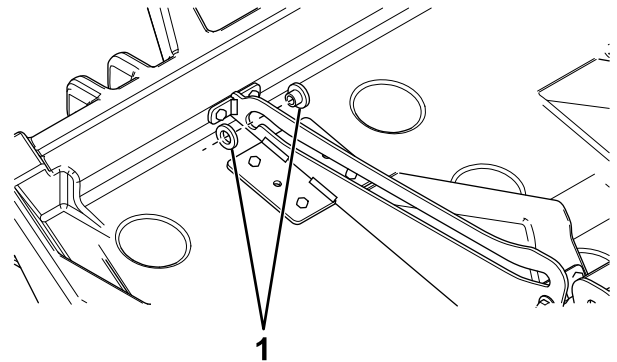

Figure 19

g225548

1. Roller

2. Secure a bushing to each mounting bracket using a bolt (3/8 x 1-3/4 inches) and nut (Figure 20).

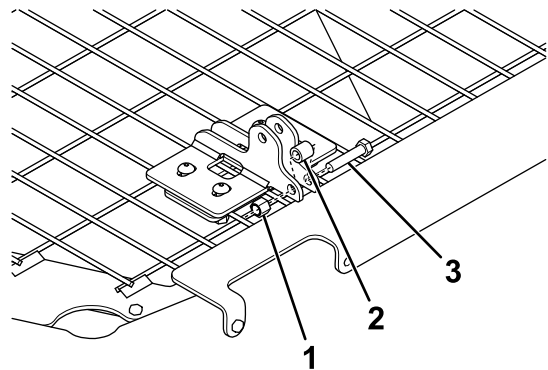

Figure 20

g225550

1. Nut (3/8 inch)
2. Bushing
3. Bolt (3/8 x 1-3/4 inches)

- Lift a cover onto the spreader and stand it vertically as shown in [Figure 21](#).

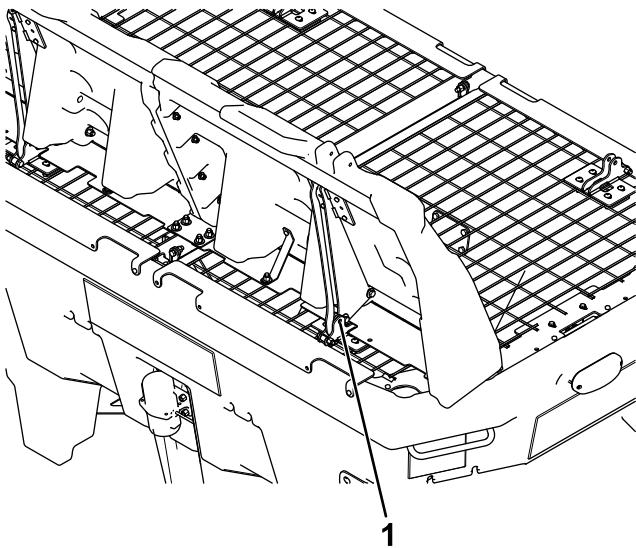

Figure 21

g225551

- Mounting bracket hole

- Line up the slots in the tracks with the holes in the mounting brackets ([Figure 21](#)).
- Slide the rollers on the tracks until they line up with the holes in the mounting brackets ([Figure 21](#)).
- Secure the cover to the top screen using 2 clevis and cotter pins ([Figure 22](#)).

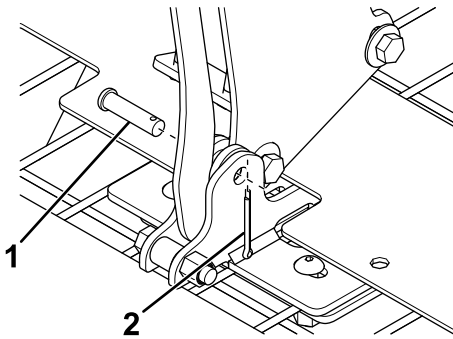

Figure 22

g225552

- Clevis pin
- Cotter pin

- Repeat steps 3 through 6 on the other side.
- Lower the cover and adjust the position of the mounting brackets until everything fits correctly.
- Torque the mounting bracket fasteners to 31 N·m (23 ft-lb).

Installing the Handles

- Secure 2 mounting assemblies to a handle assembly using 2 nuts, 2 male bushings, 2 washers, and 2 bolts (3/8 x 1-1/4 inches) as shown in [Figure 23](#).

Important: Do not overtighten the fasteners.

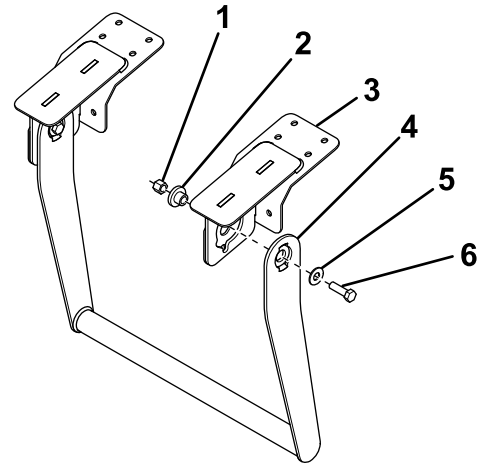

Figure 23

g225553

- | | |
|----------------------|------------------------------|
| 1. Nut (3/8 inch) | 4. Handle assembly |
| 2. Male bushing | 5. Washer (3/8 inch) |
| 3. Mounting assembly | 6. Bolt (3/8 x 1-1/4 inches) |

- Center the handle on the cover and secure it with 12 lag screws ([Figure 24](#)).

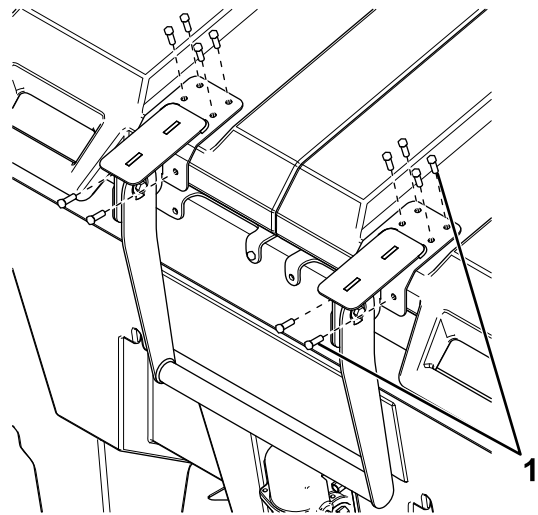

Figure 24

g225554

- Lag screw

- Using the handle as a guide, mark the placement of the handle clips and secure them in place with 4 lag screws ([Figure 25](#)).

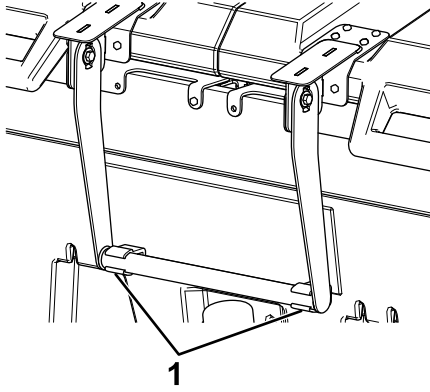

Figure 25

g225555

- Handle clips
-

- Repeat on the other side.
- If desired, lubricate any pivot points.

BOSS
S N O W P L O W